

Safety instructions



WARNING

Operator must have instructions before running the machine. Untrained operators can cause injury or death.



Never use the telescopic handler without instructions. See the machine signs (decals), Operation & Maintenance Manual, and data sheets located in the cab.



Safety Alert Symbol: This symbol with a warning statement means: "Warning, be alert! Your safety is involved!" Carefully read the message that follows.

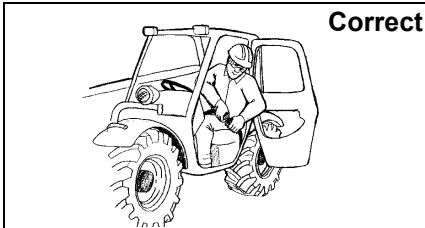

Correct

- Always fasten seat belt securely.
- Do not have any part of your body outside the cab

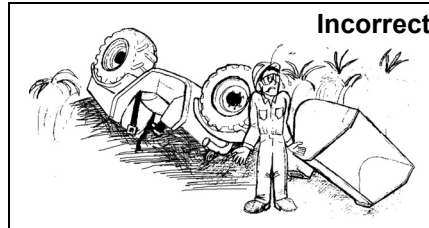

Incorrect

- Never use the telescopic handler without operator cab (ROPS & FOPS).

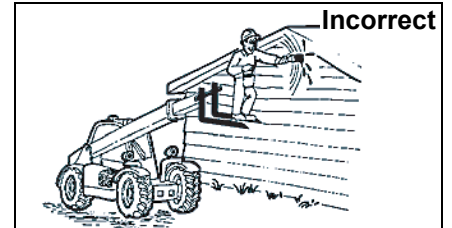

Incorrect

- Never use the machine as a working platform or an elevator.

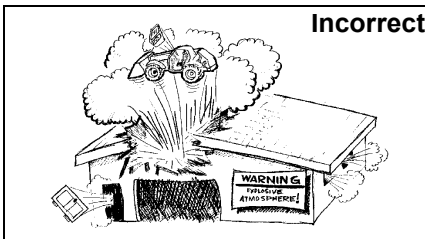

Incorrect

- Do not use the machine where exhaust can contact flammable material, explosive dust or gases.

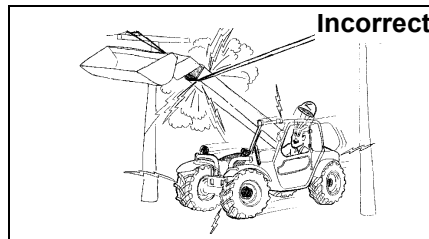

Incorrect

- Check for underground or overhead lines in the area before operating the machine.
- Keep a minimum distance of 8 m between the nearest line and the machine arm, attachment, or load.

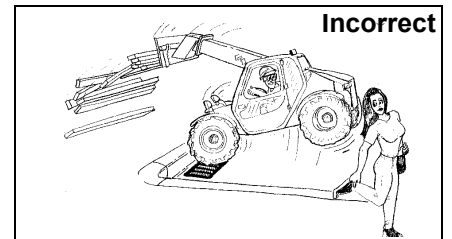

Incorrect

- Never transport a load when raised.
- Do not travel or turn with the lift arms up.
- Load, unload and turn on flat level ground.

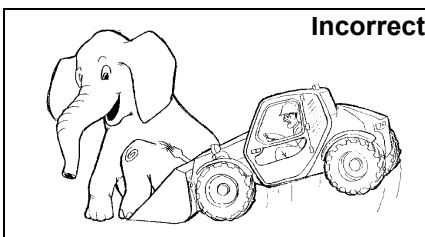

Incorrect

- Never exceed rated operating capacity.
- Keep to the limits of the machine's load chart and/or the attachment's nominal capacity.

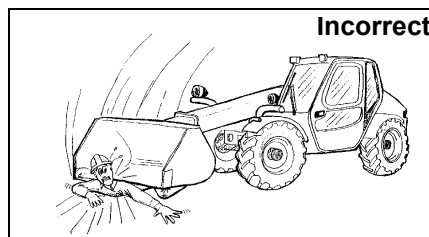

Incorrect

- Never leave telescopic handler with engine running or with lift arms up.
- To park, engage parking brake and put attachment flat on the ground.

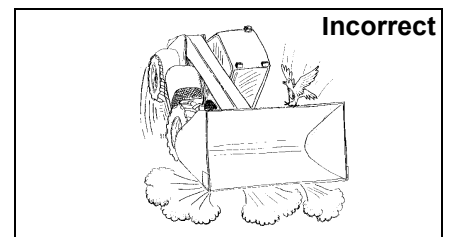

Incorrect

- Never modify equipment.
- Only use attachments that are approved by Massey Ferguson for this type of telescopic handler.

SAFETY EQUIPMENT

The Massey Ferguson telescopic handler must be equipped with safety systems necessary for each job. Ask your dealer for information on the safe use of attachments and accessories.

- SEAT BELT:** Check belt fasteners and check for damaged strap or buckle.
- OPERATOR CAB (ROPS & FOPS):** It must be on the machine with all fasteners tight. Never use the machine without the right side window.
- OPERATOR'S HANDBOOK:** Must be in cab.
- MACHINE SIGNS (Decals):** Replace if Damaged
- SAFETY TREADS:** Replace if Damaged
- GRAB HANDLES:** Replace if Damaged
- PARKING BRAKE**
- WINDOWS AND MIRRORS:** Clean and check for broken window or mirror. Replace if Damaged

Page left blank intentionally

CONTENTS

CONTENTS I

FOREWORD I

SAFETY 1

LOAD CHARTS 9

OPERATING INSTRUCTIONS 13

PREVENTIVE MAINTENANCE 39

ATTACHMENTS 59

OPTIONS 71

SPECIFICATIONS 8947 79

REFERENCE INFORMATION

Write the correct information for your Massey Ferguson telescopic handler in the spaces below. Always use these numbers when referring to your machine.

Telescopic Handler Serial Number	
Engine Serial Number	
Notes:	
Your Massey Ferguson Dealer:	
Address:	
Telephone:	

FOREWORD

IMPORTANT

This manual was written to give the owner/operator instructions on the safe operation and maintenance of the Massey Ferguson telescopic handler. READ AND UNDERSTAND THIS MANUAL BEFORE OPERATING YOUR MACHINE. If you have any questions, see your Massey Ferguson dealer.

Regular Maintenance Items III

Lubricants, fuel and fluids..... III

Serial Number Locations IV

Delivery Report..... IV

Identification of the telescopic handler V

Options and Accessories..... VI

Regular Maintenance Items

The parts listed below are those required for normal maintenance of the machine. For other parts, consult your Massey Ferguson dealer who has the catalogue of spare parts for your machine.



WARNING

Only use guaranteed genuine Massey Ferguson parts for the maintenance of the machine.

Designation	Code
Air filter - Main cartridge turbocharged engine	4235 895 M1
Air filter - Standby cartridge turbocharged engine	4235 896 M1
Diesel engine fuel filter cartridge	4224 811 M1
Diesel engine oil filter cartridge	4225 348 M1
Alternator belt	4233 305 M1
Hydraulic oil filter cartridge	4235 978 M1
Hydraulic tank vent valve	
Wheel nut	
Wheel nut washer	

Lubricants, fuel and fluids

The lubricants and fuels described below are those used in the factory. They apply to operating conditions in European temperate climate areas. Please consult us for requirements under other weather conditions.

Designation	Brand	Code
Engine oil - Diesel engine lubricating circuit	TOTAL	RUBIA XT 15W40
Hydraulic oil - Hydraulic system	TOTAL	EQUIVIS ZS 46
Transmission oil - Axle and transfer box housings	TOTAL	TRANSMISSION MP
Brake fluid - Service brake system	TOTAL	LHM PLUS
Grease - Boom hinges and guides	TOTAL	MULTIS EP
Antifreeze - Diesel engine coolant circuit	TOTAL	ANTIGEL
Fuel	-	Gas oil

Serial Number Locations

Telescopic Handler Serial Number

Always use the type, model and serial number of the machine when requesting service information or when ordering parts.

Early or later models (identified by the serial number) may use different parts or require a specific maintenance procedure.

The machine name plate is riveted to the right side of the frame, near the front right wheel. The serial number is etched on the top of the frame, on the front right end.

Figure 1

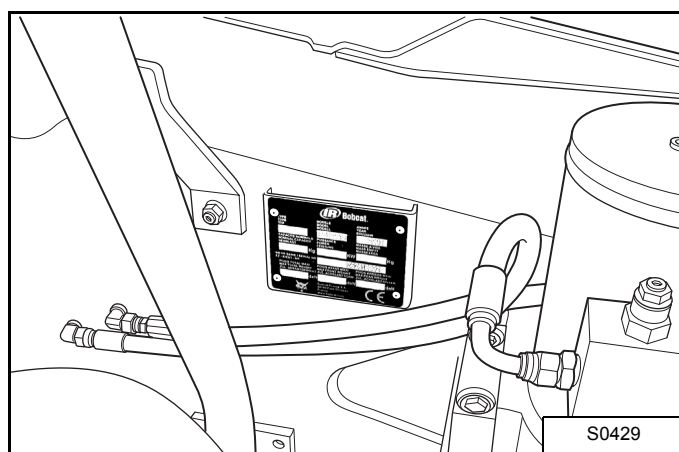

Engine Serial Number

The engine serial number is etched on a plate located beneath the alternator belt [Figure 2]. The belt cover must first be removed. Always use the complete serial number when requesting information or when ordering parts.

Figure 2

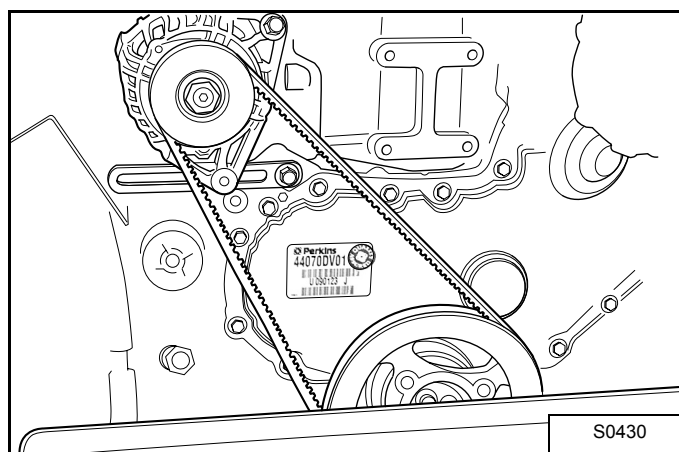

Other Serial Numbers

Other components may also have serial numbers and an identification plate. Always use these serial numbers when ordering parts.

Delivery Report

The Delivery Report must be filled out by the dealer and signed by the owner or operator when the Telescopic Handler is delivered. An explanation of the form must be given to the owner. Make sure it is filled out correctly.

Identification of the telescopic handler

Reference	Designation
1	Telescopic boom
2	Boom
3	Fuel tank
4	Mirror
5	Operator Cab
6	Battery compartment
7	Boom stop (opt.)
8	Engine exhaust
9	Lights
10	Engine cover
11	Rotating beacon
12	Palletiser

For the 8947 telescopic handler [Figure 3].

Figure 3

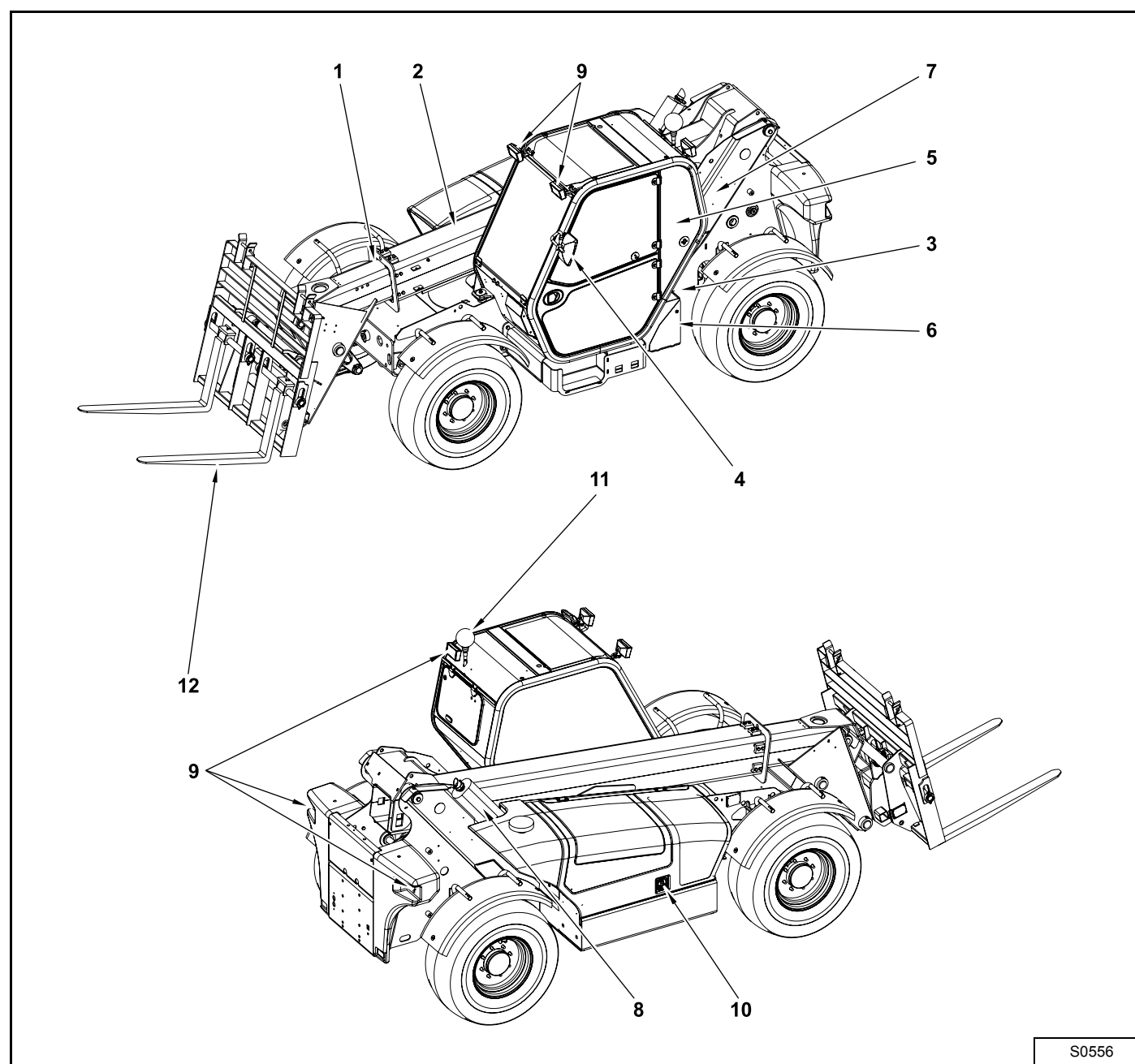

S0556

Options and Accessories

The 8947 telescopic handler has the following basic equipment:

- Hydrostatic transmission
- ROPS/FOPS operator cab
- Heating, demisting, windscreen washer
- Hydraulic Joystick Control
- Two-way auxiliary hydraulic supply at the end of the boom
- Hydraulic system
- Mechanical lock of accessories
- 4 equal-size drive and steering wheels with DUNLOP 400/80.24 15 3B T37 TL TYRES
- Mudguards
- Narrow bracket (mounting of the equipment)
- Reverse drive alarm
- Rotating beacon
- Yoke + electrical plug

Options

- Stop aggravating movements (SAM) device with key switch to disable this function
- Tyres
- Cab air conditioning
- Rear hydraulic hook + mirror
- Transmission disengagement
- Rear hydraulic connection
- Trailer brake valve
- Fan reverse (for clearing out dust)
- Set of blue lights for hen houses
- Hydraulic lock of equipment
- Windscreen grill
- Work light on boom
- Roof windscreen wiper
- 2nd hydraulic function on boom

Below is a list of equipment available from your dealer as Dealer and/or Factory Installed Accessories. Please see your Massey Ferguson dealer for more information.

Tyres

The machine is fitted with 4 identical tyres.

Three mounts are possible:

Marque	Dimensions	Pression (bar)
TITAN (Option)	400/70 - 20 150B 166A2 LIFT RIGGER II	4
DUNLOP (option)	405/70 - 20 MPT 152J 168A2 SP T9	5,5
DUNLOP (option)	400/70 - 20 150B T37 TL	4
DUNLOP (Standard)	400/80 - 24 153B T37 TL	4,25

SAFETY

Contents

Safety instructions for Massey Ferguson telescopic handlers and their attachments.....	2
Safety is the operator's responsibility.....	2
Safety Symbols.....	3
Safe operation requires a qualified operator.....	3
Fire Prevention.....	4
Instructions for maintenance.....	4
Warning of residual risks.....	5
Other instructions.....	5
Machine Signs (Decals).....	7

Safety instructions for Massey Ferguson telescopic handlers and their attachments

Safety is the operator's responsibility

Carefully follow the operating and maintenance instructions in this manual.

All Massey Ferguson telescopic handlers and attachments are designed to ensure maximum safety to the operator. However, in spite of very careful design, this machine can be dangerous if not used and serviced according to the instructions in this manual.

A certificate of compliance is issued on delivery of the machine. This must be kept and shown at each periodic inspection of the machine and handed over to the purchaser if the machine is resold.

The Massey Ferguson telescopic handler is highly manoeuvrable and compact. It is rugged and useful under a wide variety of conditions. The operator will still face hazards associated with various types of applications.

Subject to compliance with operating and maintenance instructions, and use of the specially designed original equipment, this machine:

- can be used for lifting operations with variable-length load suspension components, which allow the load to swing freely in all directions;

This machine is not designed for:

- use under weather conditions with a risk of lightning, storm or winds faster than 12.5 m/s (force 6 on the Beaufort scale);
- use in explosive atmosphere;
- carrying out work on live power lines;
- carrying out underground work.

The dealer explains the capabilities and restrictions of the Massey Ferguson telescopic handler for each application. The dealer demonstrates the safe operation according to Massey Ferguson instructions, which are made available to operators.

The dealer can also identify unsafe modifications or use of non-approved attachments.

The attachments and buckets are designed for rated capacities and secure fastening to the Massey Ferguson telescopic handler.

The user should check with the dealer, or refer to Massey Ferguson documentation, to determine safe loads of materials of specified densities for the Telescopic Handler/ Attachment combination.

The user must adhere to the load charts relative to each mounting of tyres.

The user should use only the tyres listed in "Tyres" on page 72

, and should ensure that the machine is equipped with 4 identical tyres.

The following publications and training materials provide information on the safe use and maintenance of the telescopic handler and attachments:

- The Delivery Report ensures that complete instructions have been given to the new owner and that the Massey Ferguson Telescopic Handler and equipment are in safe operating condition.
- The Operation & Maintenance Manual delivered with the Massey Ferguson telescopic handler or attachment provides operating information as well as routine maintenance and service procedures. It is a part of the telescopic handler and must be stored in the container provided inside the operator cab. Replacement Operation & Maintenance Manuals are available from your Massey Ferguson dealer.
- Machine signs (decals) instruct on the safe operation and maintenance of your Massey Ferguson telescopic handler or attachment. The signs and their locations are shown in the Operation & Maintenance Manual. Replacement signs are available from your Massey Ferguson dealer.

On delivery, the dealer checks the recommended applications of the product with the owner / operator. If the machine is to be used for other applications, the owner/ operator should check the relevant recommendations with the dealer.

This as a preview PDF file from best-manuals.com



Download full PDF manual at best-manuals.com