

9020 Excavator Service Manual

Table of Contents

Description	Section No.	Form No.
General		
	Tab 1	
Section Index - General		7-45990
Standard Torque Specifications for 9000 Series Excavators	1001	7-44790
Fluids and Lubricants	1002	7-45590
Engines		
	Tab 2	
Section Index - Engines		7-46000
Engine Removal and Installation	2001	7-46700
Radiator Removal and Installation	2002	7-46710
Detailed Engine Specifications	2402	8-24163
Aftercooler	2411	7-43510
Cylinder Head and Valve Train	2415	8-24173
Cylinder Block	2425	8-24183
Lubrication	2445	8-24193
Cooling System	2455	8-24203
Turbocharger	2465	8-25550
Turbocharger Failure Analysis	2565	9-78235
Fuel System		
	Tab 3	
Section Index - Fuel System		7-46010
Fuel System and Filters	3410	8-24212
Fuel Injectors	3413	8-24233
Fuel Injection Pump (Bosch)	3415	7-37141
Electrical		
	Tab 4	
Section Index - Electrical		7-46020
Electrical Specifications and Troubleshooting	4001	7-45770
Electric Schematic Foldout	In Rear Pocket	7-45970
Batteries	4002	7-44950
Systems Display Panel	4005	7-44980
Starter and Starter Solenoid	4006	8-42191
Alternator	4009	8-16570
Tracks		
	Tab 5	
Section Index - Tracks		7-46030
Troubleshooting the Track System	5001	7-44830
Tracks, Rollers, and Idlers	5002	7-46040
Power Train		
	Tab 6	
Section Index - Power Train		7-46050
Troubleshooting - See Section 8001		
Drive Motor and Final Drive Transmission	6000	7-46060

Reprinted



9020 Excavator Service Manual

Table of Contents

Description	Section No.	Form No.
Hydraulics		Tab 8
Section Index - Hydraulics		7-46070
Cleaning the Hydraulic System	8000	7-45050
Hydraulic Specifications, Troubleshooting, and Pressure Checks	8001	7-45850
Hydraulic Schematic Foldout	In Rear Pocket	7-45970
Main Hydraulic Pump	8002	7-46080
Pilot Control Circuit Pump	8003	7-46090
Hydraulic Swivel	8004	7-46100
Main Control Valve	8005	7-46110
Remote Control Valves	8006	7-45780
Solenoid Valves	8007	7-46960
Swing Motor and Swing Reduction Gear Box	8008	7-46120
Cylinders	8009	7-46130
Cushion Control Valve	8010	7-46750
Boom Holding Valve	8011	7-46780
Auxiliary Control Valve	8012	7-46790
Mounted Equipment		Tab 9
Section Index - Mounted Equipment		7-46140
Pedals and Levers	9001	7-45670
Turntable Bearing	9003	7-46720
Boom and Arm	9004	7-46150
Seat and Seat Belts	9006	7-45170
Electric and Hydraulic Schematic Foldout	In Rear Pocket	7-45970

SECTION INDEX - GENERAL

Section Title

Section Number

Standard Torque Specifications for 9000 Series Excavators	1001
Fluids and Lubricants	1002



Section 1001

STANDARD TORQUE SPECIFICATIONS FOR 9000 SERIES EXCAVATORS



Bur 7-44790

Copyright © 1992 CASE CORPORATION
Printed in U.S.A.
Issued November 1992

TABLE OF CONTENTS

TORQUE SPECIFICATIONS - DECIMAL HARDWARE2

TORQUE SPECIFICATIONS - METRIC HARDWARE3

TORQUE SPECIFICATIONS - STEEL HYDRAULIC FITTINGS4

TORQUE SPECIFICATIONS - O-RING FACE SEAL FITTINGS.....5

TORQUE SPECIFICATIONS - DECIMAL HARDWARE

Use the torques in this chart when special torques are not given. These torques apply to fasteners with both UNC and UNF threads as received from suppliers, dry, or when lubricated with engine oil. Not applicable if special graphites, molydisulfide greases, or other extreme pressure lubricants are used.

Grade 5 Bolts, Nuts, and Studs		
		
Size	Pound-Feet	Newton metres
1/4 in	9-11	12-15
5/16 in	17-21	23-28
3/8 in	35-42	48-57
7/16 in	54-64	73-87
1/2 in	80-96	109-130
9/16 in	110-132	149-179
5/8 in	150-180	203-244
3/4 in	270-324	366-439
7/8 in	400-480	542-651
1.0 in	580-696	787-944
1-1/8 in	800-880	1085-1193
1-1/4 in	1120-1240	1519-1681
1-3/8 in	1460-1680	1980-2278
1-1/2 in	1940-2200	2631-2983

Grade 8 Bolts, Nuts, and Studs		
		
Size	Pound-Feet	Newton metres
1/4 in	12-15	16-20
5/16 in	24-29	33-39
3/8 in	45-54	61-73
7/16 in	70-84	95-114
1/2 in	110-132	149-179
9/16 in	160-192	217-260
5/8 in	220-264	298-358
3/4 in	380-456	515-618
7/8 in	600-720	814-976
1.0 in	900-1080	1220-1465
1-1/8 in	1280-1440	1736-1953
1-1/4 in	1820-2000	2468-2712
1-3/8 in	2380-2720	3227-3688
1-1/2 in	3160-3560	4285-4827

NOTE: Use thick nuts with Grade 8 bolts.

TORQUE SPECIFICATIONS - METRIC HARDWARE

Use the following torques when specifications are not given.

These values apply to fasteners with coarse threads as received from supplier, plated or unplated, or when lubricated with engine oil. These values do not apply if graphite or molydisulfide grease or oil is used.

Grade 8.8 Bolts, Nuts, and Studs		
		
Size	Pound-Feet	Newton metres
M6	6-7	8-9
M8	14-17	20-23
M10	29-34	39-46
M12	50-59	68-80
M16	128-149	173-202
M20	249-291	337-393
M22	342-399	464-541
M24	431-503	584-681
M27	637-743	864-1008
M30	863-1007	1170-1365
M33	1180-1377	1600-1867
M36	1977-2307	2680-3127
M42	2434-2840	3300-3850
M45	3054-3563	4140-4830
M48	3658-4268	4960-5787
M52	4757-5549	6450-7525
M56	5908-6893	8010-9345
M64	8925-10413	12100-14117

Grade 10.9 Bolts, Nuts, and Studs		
		
Size	Pound-Feet	Newton metres
M6	8-10	11-13
M8	20-24	28-32
M10	41-47	55-64
M12	71-83	96-112
M16	178-208	242-282
M20	350-408	475-554
M22	481-561	652-761
M24	606-707	821-958
M27	900-1050	1220-1423
M30	1217-1420	1650-1925
M33	1667-1945	2260-2637
M36	2124-2478	2880-3360
M39	2773-3235	3760-4387
M42	3422-3992	4640-5413
M45	4293-5009	5820-6790
M48	5141-5998	6970-8132
M52	6690-7805	9070-10582
M56	8334-9723	11300-13183
M64	12612-14714	17100-19950

Grade 12.9 Bolts, Nuts, and Studs



Usually the torque values specified for grade 10.9 fasteners can be used satisfactorily on grade 12.9 fasteners.

TORQUE SPECIFICATIONS - STEEL HYDRAULIC FITTINGS

Tube OD Hose ID	Thread Size	Pound- Feet	Newton metres
37 Degree Flare Fittings			
1/4 in 6.4 mm	7/16-20	6-12	8-16
5/16 in 7.9 mm	1/2-20	8-16	11-22
3/8 in 9.5 mm	9/16-18	10-25	14-34
1/2 in 12.7 mm	3/4-16	15-42	20-57
5/8 in 15.9 mm	7/8-14	25-58	34-79
3/4 in 19.0 mm	1-1/16-12	40-80	54-108
7/8 in 22.2 mm	1-3/16-12	60-100	81-135
1.0 in 25.4 mm	1-5/16-12	75-117	102-158
1-1/4 in 31.8 mm	1-5/8-12	125-165	169-223
1-1/2 in 38.1 mm	1-7/8-12	210-250	285-338

Tube OD Hose ID	Thread Size	Pound- Feet	Newton metres
Straight Threads with O-ring			
1/4 in 6.4 mm	7/16-20	12-19	16-26
5/16 in 7.9 mm	1/2-20	16-25	22-34
3/8 in 9.5 mm	9/16-18	25-40	34-54
1/2 in 12.7 mm	3/4-16	42-67	57-91
5/8 in 15.9 mm	7/8-14	58-92	79-124
3/4 in 19.0 mm	1-1/16-12	80-128	108-174
7/8 in 22.2 mm	1-3/16-12	100-160	136-216
1.0 in 25.4 mm	1-5/16-12	117-187	159-253
1-1/4 in 31.8 mm	1-5/8-12	165-264	224-357
1-1/2 in 38.1 mm	1-7/8-12	250-400	339-542

Split Flange Mounting Bolts*		
Size	Pound- Feet	Newton metres
5/16-18	15-20	20-27
3/8-16	20-25	27-34
7/16-14	35-45	47-61
1/2-13	55-65	74-88
5/8-11	140-150	190-203

**NOTE: Use standard metric hardware torque for metric split flange mounting bolts.*

TORQUE SPECIFICATIONS - O-RING FACE SEAL FITTINGS

Nom. SAE Dash Size	Tube OD	Thread Size	Pound-Feet	Newton metres	Thread Size	Pound-Feet	Newton metres
O-ring Face Seal End					O-ring Boss End Fitting or Lock Nut		
-4	1/4 in 6.4 mm	9/16-18	10-12	14-16	7/16-20	17-20	23-27
-6	3/8 in 9.5 mm	11/16-16	18-20	24-27	9/16-18	25-30	34-41
-8	1/2 in 12.7 mm	13/16-16	32-40	43-54	3/4-16	45-50	61-68
-10	5/8 in 15.9 mm	1-14	46-56	62-76	7/8-14	60-65	81-88
-12	3/4 in 19.0 mm	1-3/16-12	65-80	90-110	1-1/16-12	85-90	115-122
-14	7/8 in 22.2 mm	1-3/16-12	65-80	90-110	1-3/16-12	95-100	129-136
-16	1.0 in 25.4 mm	1-7/16-12	92-105	125-140	1-5/16-12	115-125	156-169
-20	1-1/4 in 31.8 mm	1-11/16-12	125-140	170-190	1-5/8-12	150-160	203-217
-24	1-1/2 in 38.1 mm	2-12	150-180	200-254	1-7/8-12	190-200	258-271

Section 1002

1002

FLUIDS AND LUBRICANTS



TABLE OF CONTENTS

CAPACITIES AND LUBRICANT SPECIFICATIONS	3
HYDRAULIC OIL CHART	4
ENGINE LUBRICATION	5
Engine Oil Selection	5
Oil Viscosity/Temperature Ranges	5
DIESEL FUEL	6
Fuel Storage	6

NOTE: The J I Case Company reserves the right to make improvements in design or changes in specifications at any time without incurring any obligation to install them on units previously sold.

CAPACITIES AND LUBRICANT SPECIFICATIONS

Fuel Tank

Capacity 63.4 U.S. gallons (240 litres)
 Type of fuel See Diesel Fuel on page 6

Engine Oil Capacity

Capacity with filter change 11.6 U.S. quarts (11 litres)
 Type of Lubricant Case IH Engine Oil, see Engine Lubrication on page 5

Engine Cooling System

Capacity 5 U.S. gallons (18.9 litres)
 Type of coolant Use a mixture of 55% ethylene glycol and 45% water.
 If lowest ambient temperature will be below -34°F (1.11°C) adjust the mixture.

Hydraulic Reservoir

Tank capacity 21.9 U.S. gallons (83 litres)
 System capacity 41.4 U.S. gallons (157 litres)
 Type of fluid See Hydraulic Oil Chart on page 4

Swing Gearbox

Capacity 1.8 U.S. quarts (1.7 litres)
 Type of lubricant Case IH 135H EP Gear Lube

Swing Ring Gear

Capacity 22 pounds (10 kg)
 Type of lubricant Case No. 2 Lithium Grease

Turntable Bearing

Capacity As required
 Type of lubricant Case No. 2 Lithium Grease

Final Drives

Capacity 2.8 U.S. quarts (2.5 litres)
 Type of lubricant Case IH 135H EP Gear Lube

Track Roller

Capacity 5.3 ounces (160 cc)
 Type of lubricant Shell Rimula Oil No. 30 or equivalent to API Class CD, SAE 30

Carrier Roller

Capacity 3.6 ounces (110 cc)
 Type of lubricant Shell Rimula Oil No. 30 or equivalent to API Class CD, SAE 30

Idler Wheel

Capacity 4.6 ounces (140 cc)
 Type of lubricant Shell Rimula Oil No. 30 or equivalent to API Class CD, SAE 30

Track Adjustment Cylinder

Capacity As required
 Type of lubricant Case No. 2 Lithium Grease

Grease Fitting

Type of lubricant Case No. 2 Lithium Grease

Batteries

Capacity As required
 Type of lubricant Use drinking or distilled water

HYDRAULIC OIL CHART

Use only hydraulic oils meeting Case specifications of equivalent AW (anti-wear) hydraulic oils.

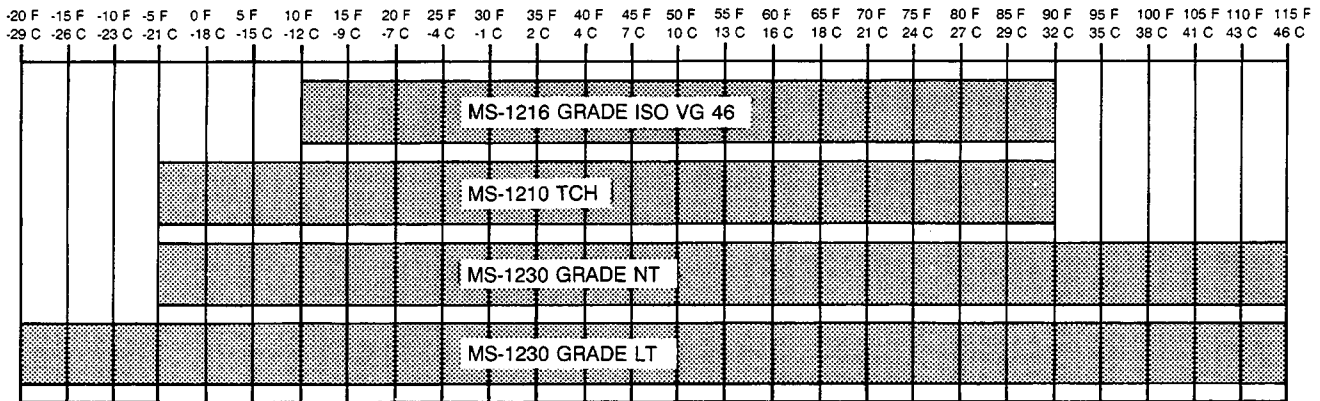

B922640J

NOTE: Case specification MS-1210 TCH Fluid is used in place of ISO VG 32 (-5° to +65°F) and ISO VG 46 (+10° to +90°F).

Case specifications MS-1230 Grade NT or Grade LT is used in place of ISO VG 32 (-5° to +65°F), ISO VG 46 (+10° to +90°F), ISO VG 100 (+30° to 115°F), and MS-1210 TCH.

ENGINE LUBRICATION

Engine Oil Selection

Case No. 1 Engine Oil is recommended for use in your Case Engine. Case Engine Oil will lubricate your engine correctly under all operating conditions.



If Case No. 1 Multi-Viscosity or Single Grade Engine Oil is not available, use only oil meeting API engine oil service category CE.



NOTE: Do not put Performance Additives or other oil additive products in the engine crankcase. The oil change intervals given in this manual are according to tests with Case lubricants.

Oil Viscosity/Temperature Ranges

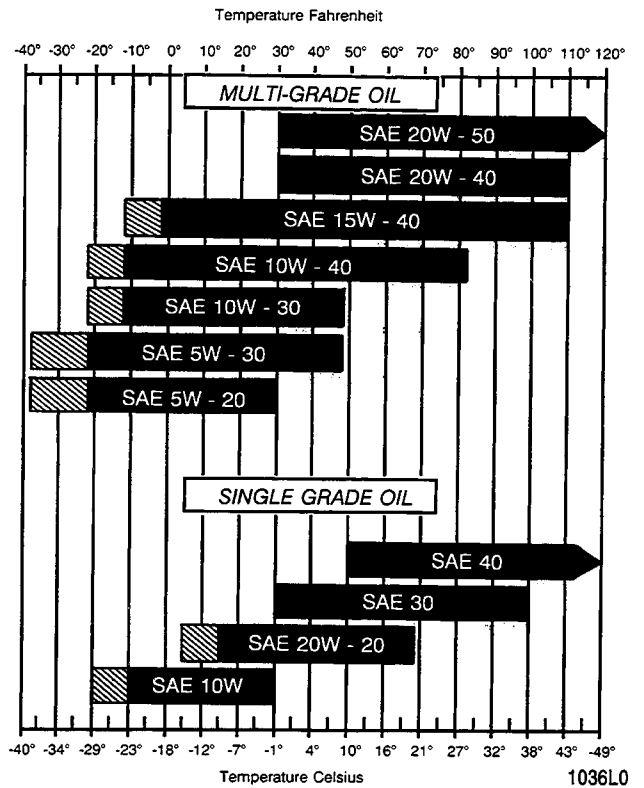

NOTE: Use of an engine oil pan heater or an engine coolant heater is required when operating temperatures are in the crosshatched area.

DIESEL FUEL

Use No. 2 diesel fuel in the engine of this machine. The use of other fuels can cause the loss of engine power and high fuel consumption.

In very cold temperatures, a mixture of No. 1 and No. 2 diesel fuels is temporarily permitted. See the following Note.

NOTE: See your fuel dealer for winter fuel requirements in your area. If the temperature of the fuel lowers below the cloud point (wax appearance point), wax crystals in the fuel will cause the engine to lose power or not start.

The diesel fuel in this machine must meet the specifications in the chart below or Specification D975-81 of the American Society for Testing and Materials.

Fuel Storage

If you keep fuel in storage for a period of time, you can get foreign material or water in the fuel storage tank. Many engine problems are caused by water in the fuel.

Keep the fuel storage tank outside and keep the fuel as cool as possible. Remove water from the storage container at regular periods of time.

Fill the fuel tank at the end of the daily operating period to prevent condensation in the fuel tank.

Specifications for Acceptable No. 2 Diesel Fuel

API gravity, minimum	34
Flash point, minimum	140°F (60°C)
Cloud point (wax appearance point), maximum	-5°F (-20°C) See Note above
Pour point, maximum	-15°F (-26°C) See Note above
Distillation temperature, 90% point	540 to 640°F (282 to 338°C)
Viscosity, at 100°F (38°C)	
Centistokes	2.0 to 4.3
Saybolt Seconds Universal	32 to 40
Cetane number, minimum	43 (45 to 55 for winter or high altitudes)
Water and sediment, by volume, maximum	0.05 of 1%
Sulfur, by weight, maximum	0.50 of 1%
Copper strip corrosion, maximum	No. 2
Ash, by weight, maximum	0.01 of 1%

 **Engine fuel is flammable and can cause a fire or an explosion. Do not fill the fuel tank or service the fuel system near an open flame, welding, burning cigars, cigarettes, etc.**

SECTION INDEX - ENGINES

Section Title	Section Number
Engine Removal and Installation	2001
Radiator Removal and Installation	2002
Detailed Engine Specifications	2402
Aftercooler	2411
Cylinder Head and Valve Train	2415
Cylinder Block	2425
Lubrication	2445
Cooling System	2455
Turbocharger	2465
Turbocharger Failure Analysis	2565



Section 2001

ENGINE REMOVAL AND INSTALLATION

TABLE OF CONTENTS

SPECIFICATIONS	3
SPECIAL TOOLS	3
ENGINE	4
Removal	4
Installation	8

NOTE: The J I Case Company reserves the right to make improvements in design or changes in specifications at any time without incurring any obligation to install them on units previously sold.

SPECIFICATIONS

Cooling system capacity	18.7 U.S. quarts (17.7 litres)
Special torques	
Bolts that hold the engine mounts to the frame	195 to 231 pound-feet (264 to 313 Nm)
Cap screws that hold the rear engine mounts to the engine	71 to 83 pound-feet (96 to 112 Nm)
Cap screws that hold the front engine mounts to the engine	71 to 83 pound-feet (96 to 112 Nm)
Cap screws that hold the fan and the spacer to the engine	38 to 45 pound-feet (51 to 61 Nm)
Cap screws that hold the hydraulic pump to the flywheel housing	48 to 56 pound-feet (65 to 76 Nm)
Weight of the hydraulic pump	201 pounds (91 kg)
Weight of the engine	827 pounds (375 kg)

SPECIAL TOOLS

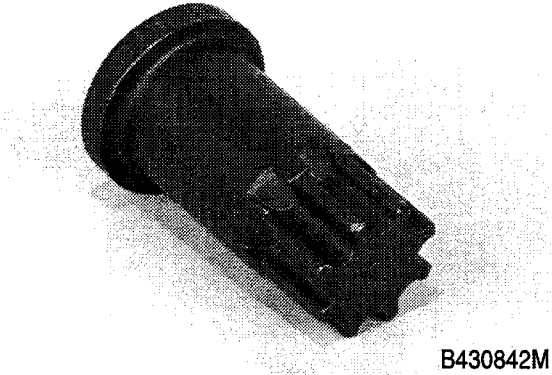

B430842M

CAS-1690 Tool used to rotate the flywheel.

ENGINE

Removal

1. Park the machine on a hard level surface. Lower the tool to the floor and stop the engine.

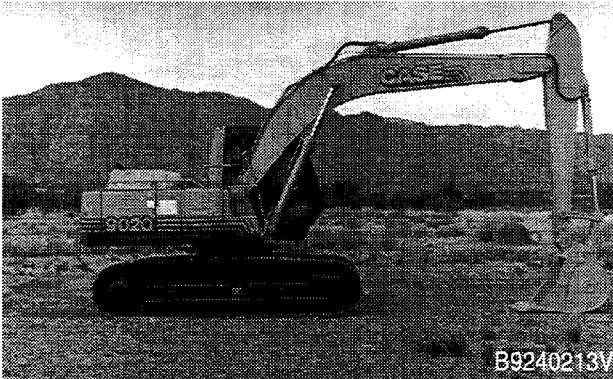

2. Open the access doors over the engine and on each side of the engine compartment. Remove the access covers from under the engine and the radiator.

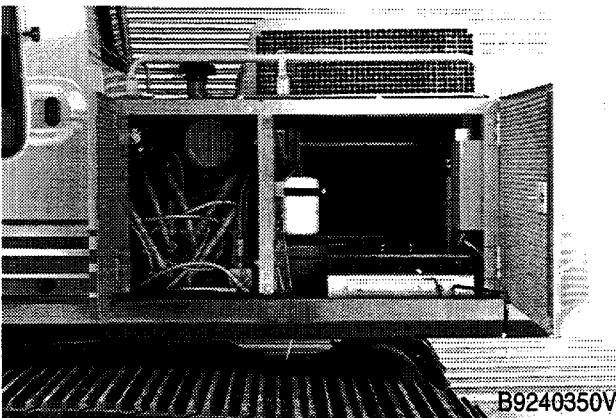

3. Make sure that the engine is cool and remove the radiator cap. Open the drain valve and drain the cooling system. The cooling system holds 18.7 U.S. quarts (17.7 litres) of coolant.



4. Remove the access cover for the batteries and disconnect the ground cable.

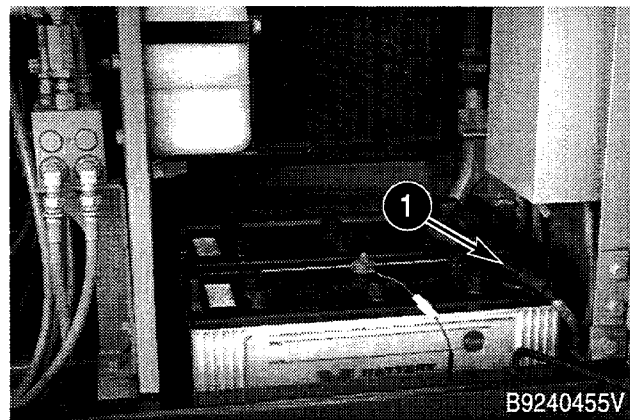

1. Ground Cable

5. Remove the muffler and the mounting bracket for the muffler.
6. Disconnect the hose for the air cleaner from the turbocharger (1).
7. Disconnect the top (3) and bottom (4) radiator hoses from the radiator.
8. Disconnect the hose (2) for the coolant reservoir from the radiator.
9. Remove the fan guard and the fan shroud from the radiator.
10. Remove the cap screws and hardware that hold the fan and the spacer to the engine.
11. Disconnect the fuel supply hose and the fuel return hose. Install a plug in each hose.

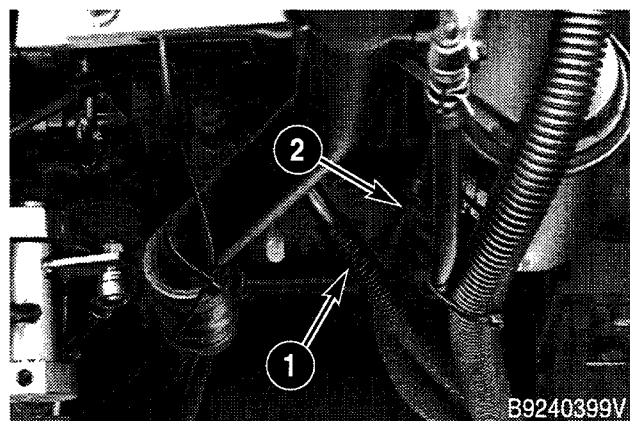

1. Supply Hose

2. Return Hose

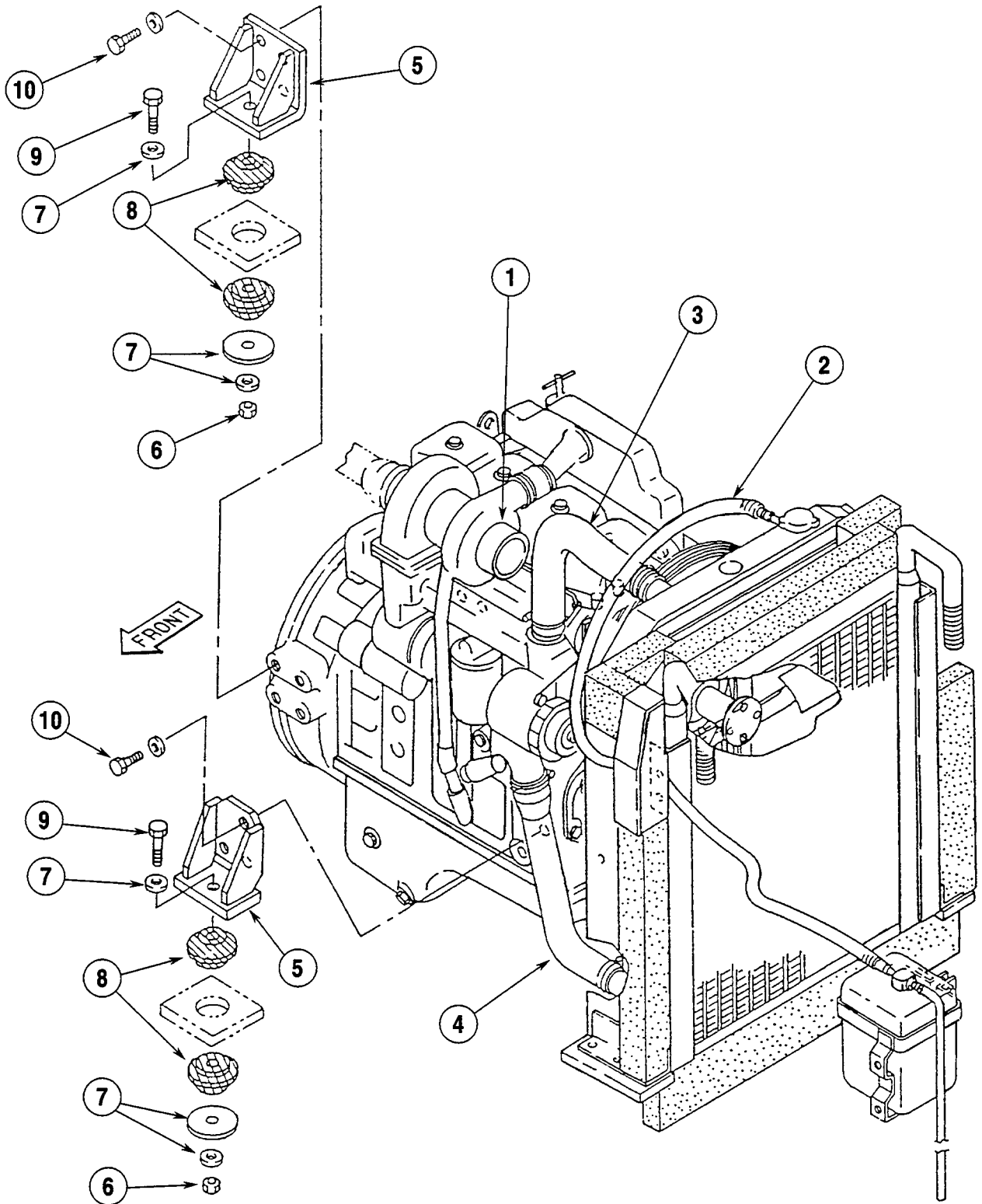

- 1. Disconnect Hose for Air Cleaner Here
- 2. Hose for the Coolant Reservoir
- 3. Top Radiator Hose
- 4. Bottom Radiator Hose
- 5. Engine Mounting Bracket

- 6. Self-Locking Nut
- 7. Washer
- 8. Insulator
- 9. Tighten to 195 to 231 pound-feet (264 to 313 Nm)
- 10. Tighten to 71 to 83 pound-feet (96 to 112 Nm)

B924511J

12. Disconnect the throttle cable from the bellcrank at the bracket on the engine. If the machine is equipped with ether start, disconnect the tube from the fitting in the intake manifold.

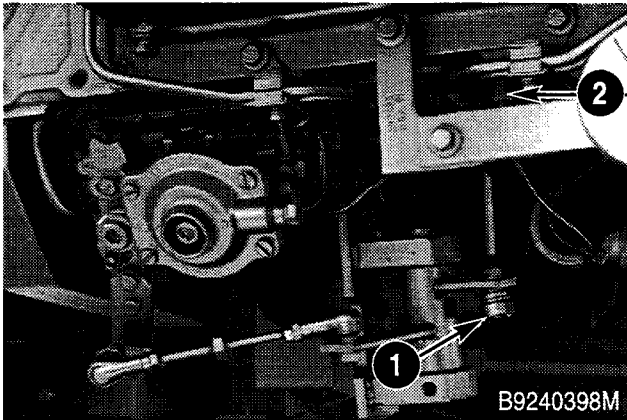

1. Disconnect Throttle Cable Here 2. Tube for Ether Start

13. Put identification tags on the wiring harness, wires and cables connected to the engine for correct assembly. Disconnect the wiring harness, wires and cables from the engine.

14. Disconnect the hoses for the heater from the engine. Install a plug in each hose.
15. Disconnect the ground strap from the engine.
16. Connect acceptable lifting equipment to the lifting eyes on the engine. The weight of the engine is 827 pounds (375 kg).
17. Connect a lifting sling to the hydraulic pump. The weight of the hydraulic pump is 201 pounds (91 kg). Remove the cap screws and hardened washers that hold the hydraulic pump to the flywheel housing.
18. Separate the hydraulic pump from the flywheel housing and disengage the splined shaft of the hydraulic pump from the splined hub in the coupling. The coupling and the drive plate will stay with the flywheel.
19. Remove the self-locking nuts (6), washers (7), insulators (8), and bolts (9) that hold the engine mounting brackets (5) to the frame.
20. Make sure that all hoses, tubes, cables, wires, and wiring harnesses are out of the way.
21. Lift the engine and remove the engine from the machine.

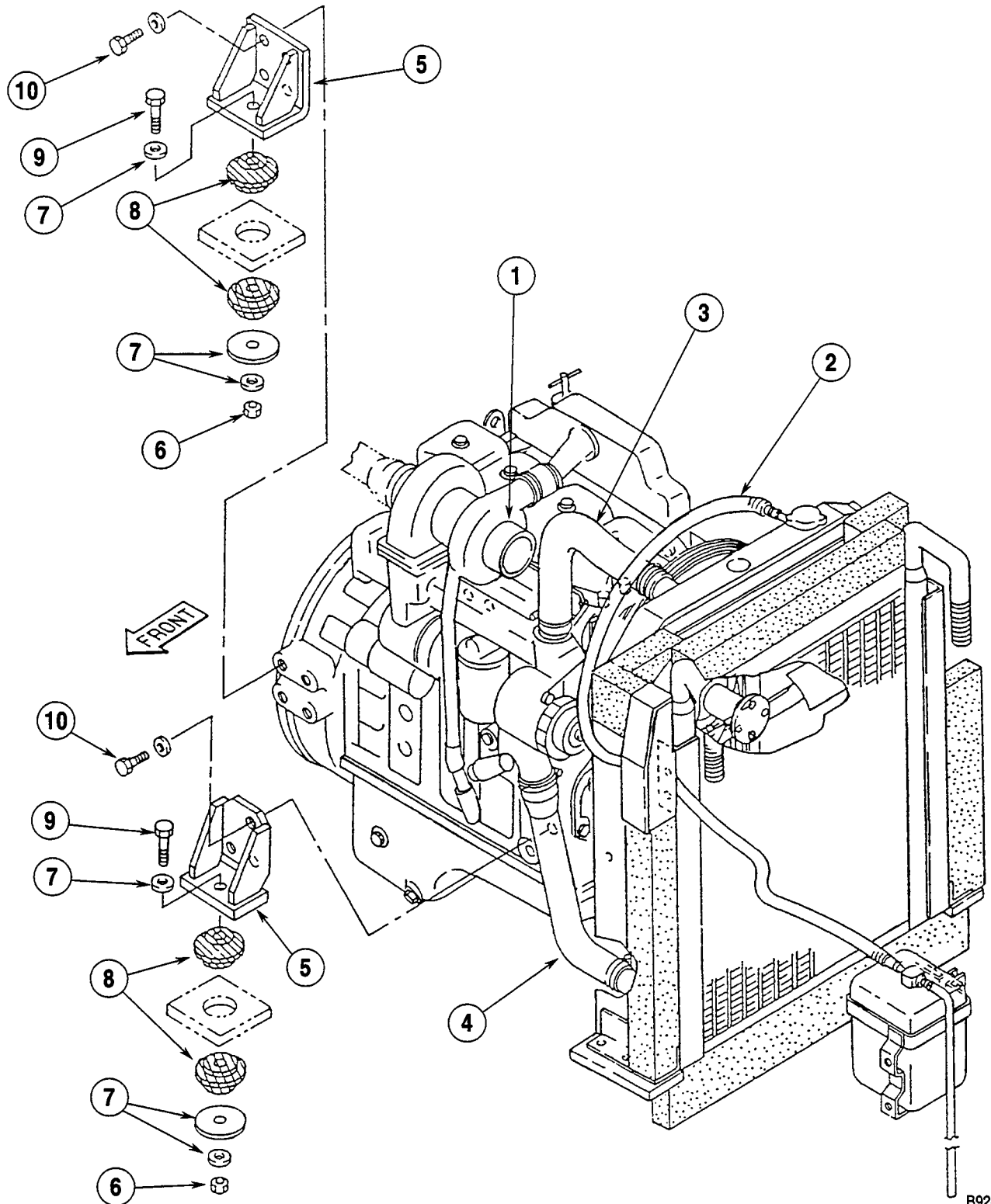

- 1. Disconnect Hose for Air Cleaner Here
- 2. Hose for the Coolant Reservoir
- 3. Top Radiator Hose
- 4. Bottom Radiator Hose
- 5. Engine Mounting Bracket

- 6. Self-Locking Nut
- 7. Washer
- 8. Insulator
- 9. Tighten to 195 to 231 pound-feet (264 to 313 Nm)
- 10. Tighten to 71 to 83 pound-feet (96 to 112 Nm)

Installation

Installation is the reverse sequence of removal.

1. Check the condition of the insulators for the engine mounts. If the insulators are damaged, install new insulators.
2. Align the holes in the drive plate and coupling with the holes in the flywheel. Install the socket head screws that hold the coupling and drive plate to the flywheel. Tighten the socket head screws to the torque specifications shown on page 3.
3. Tighten the bolts that hold the engine mounting brackets to the frame to the torque specifications shown on page 3.
4. Tighten the cap screws that hold the hydraulic pump to the flywheel housing to the torque specifications shown on page 3.
5. Tighten the cap screws that hold the fan and the spacer to the engine to the torque specifications shown on page 3.
6. Do the following procedure to bleed the air from the cooling system.
 - A. Close the drain valve on the radiator. Fill the radiator with coolant and fill the coolant reservoir to the fill neck. If new coolant is being installed, the coolant must be 55% ethylene glycol and 45% water.
 - B. Open the air bleed valve on the aftercooler at the top rear of the engine.

C. Install and tighten the radiator cap.



D. Install and tighten the cap for the coolant reservoir.

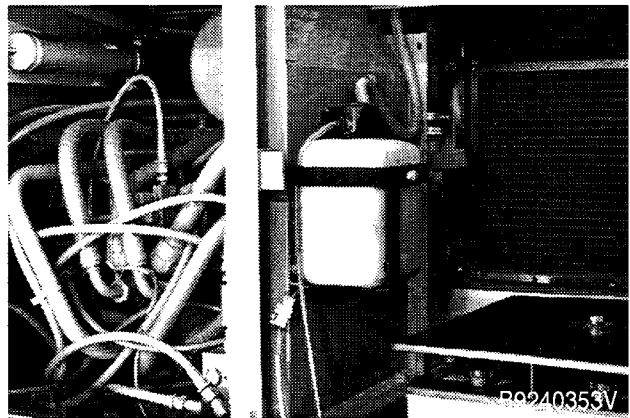

E. Close the shutoff valve for the heater at the top rear of the engine.

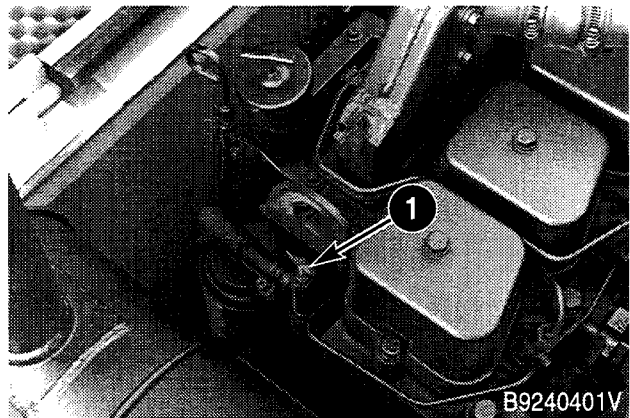

1. Shutoff Valve

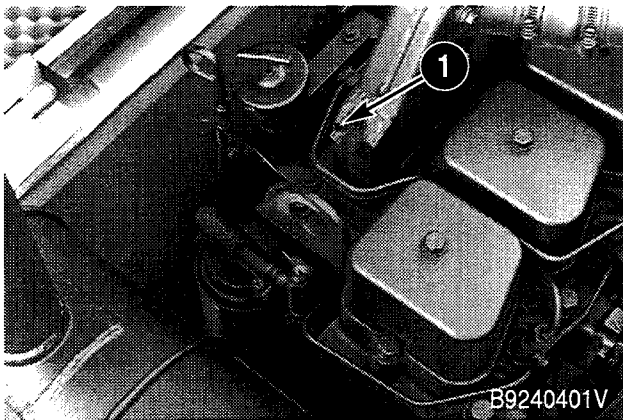

1. Air Bleed Valve

- F. Install a clear plastic hose on the air bleed valve of the aftercooler. Put the other end of the hose into a container.
- G. Have another person help you at this time.
- H. Start and run the engine at low idle. Close the air bleed valve on the aftercooler as soon as the coolant going through the clear plastic hose is free of air bubbles.
- I. Stop the engine. Fill the radiator with coolant again and fill the coolant reservoir again.
- J. Cover the outside of the radiator core (the side away from the fan) with cardboard.
- K. Start and run the engine at high idle. Look at the water temperature gauge. When the water temperature gauge indicates normal operating temperature (4th or 5th bar illuminated), open the shutoff valve for the heater.
- L. Continue to run the engine until the last amber bar illuminates, then remove the cardboard from the radiator.
- M. Reduce the engine speed to low idle. Continue to run the engine at low idle for 30 seconds.
- N. stop the engine and let the coolant cool.
- O. When the radiator feels COLD, remove the radiator cap and the cap for the coolant reservoir.
- P. Fill the radiator with coolant. Install and tighten the radiator cap.
- Q. Fill the coolant reservoir with coolant to the FULL mark. Install the cap for the coolant reservoir.

Section 2002

2002

RADIATOR REMOVAL AND INSTALLATION



Bur 7-46710

Copyright 1993 Case Corporation
Printed in U.S.A.
Issued February 1993

TABLE OF CONTENTS

SPECIFICATIONS 2

RADIATOR 3

 Removal 3

 Installation 3

NOTE: The J I Case Company reserves the right to make improvements in design or changes in specifications at any time without incurring any obligation to install them on units previously sold.

SPECIFICATIONS

Cooling System capacity 18.7 U.S. quarts (17.7 litres)

Special torques

 Cap screws that hold the fan and spacer to the engine 38 to 45 pound-feet (51 to 61 Nm)

Weight of the radiator 117 pounds (53 kg)

RADIATOR

Removal

1. Park the machine on a hard level surface. Lower the tool to the floor and stop the engine.

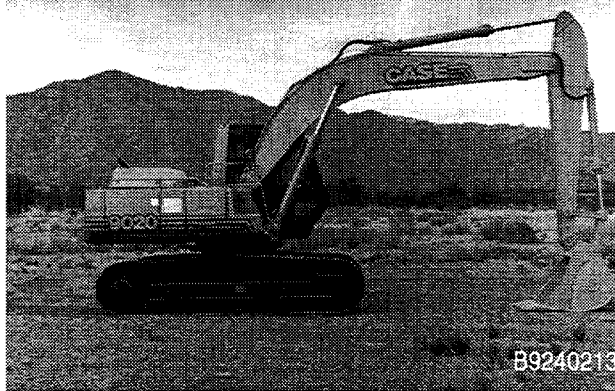

2. Open the access doors over the engine and on the left side of the engine compartment. Remove the access cover from under the radiator.

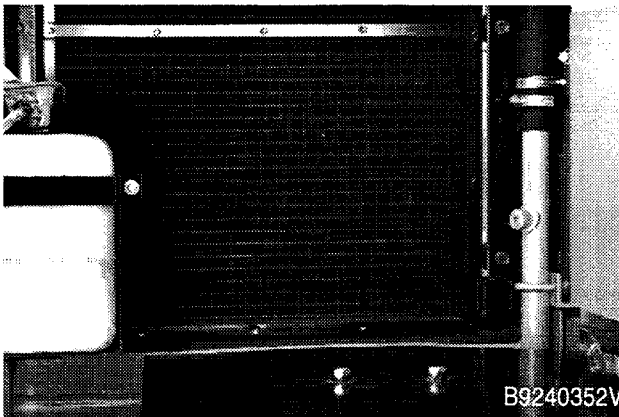

3. Make sure that the engine is cool and remove the radiator cap. Open the drain valve and drain the cooling system. The cooling system holds 18.7 U.S. quarts (17.7 litres) of coolant.



4. Disconnect the top and bottom radiator hoses from the radiator.

5. Disconnect the hose for the coolant reservoir from the radiator.
6. Remove the fan guard and the fan shroud from the radiator.
7. Remove the cap screws and hardware that hold the fan and the spacer to the engine. Remove the fan and the spacer.
8. Connect acceptable lifting equipment to the radiator. The weight of the radiator is 117 pounds (53 kg).
9. Remove the hardware that holds the radiator to the frame.
10. Remove the radiator from the machine.

Installation

Installation is the reverse sequence of removal.

1. If the foam baffles were removed from the radiator, install new foam baffles.
2. Tighten the cap screws that hold the fan and the spacer to the engine to the torque specifications shown on page 2.
3. Do the following procedure to bleed the air from the cooling system.
 - A. Close the drain valve on the radiator. Fill the radiator with coolant and fill the coolant reservoir to the fill neck. If new coolant is being installed, the coolant must be 55% ethylene glycol and 45% water.
 - B. Open the air bleed valve on the aftercooler at the top rear of the engine.

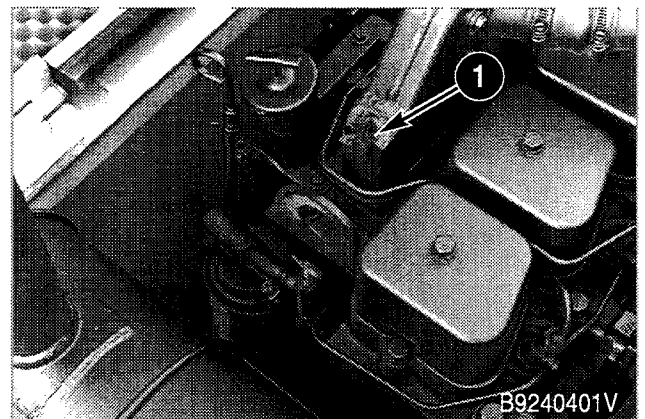

1. Air Bleed Valve

C. Install and tighten the radiator cap.

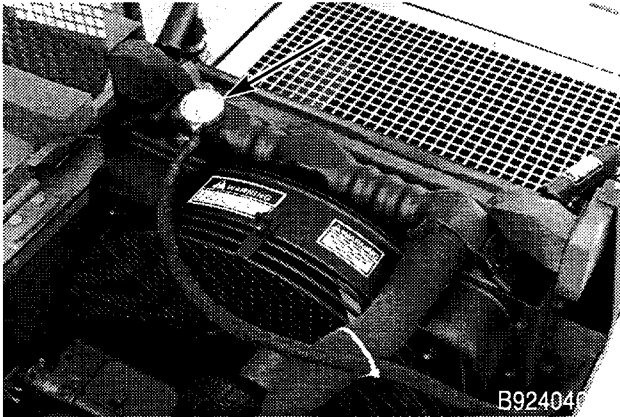

D. Install and tighten the cap for the coolant reservoir.

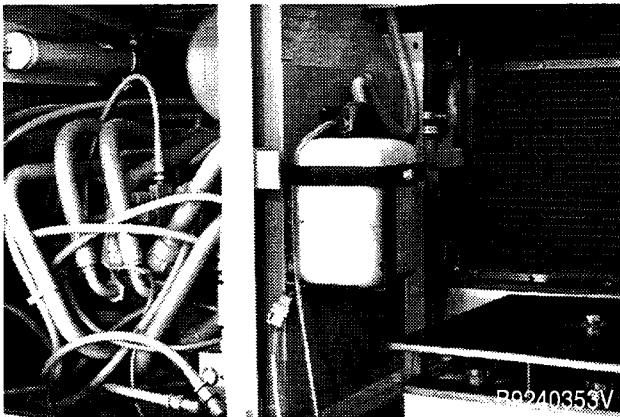

E. Close the shutoff valve for the heater at the top rear of the engine.

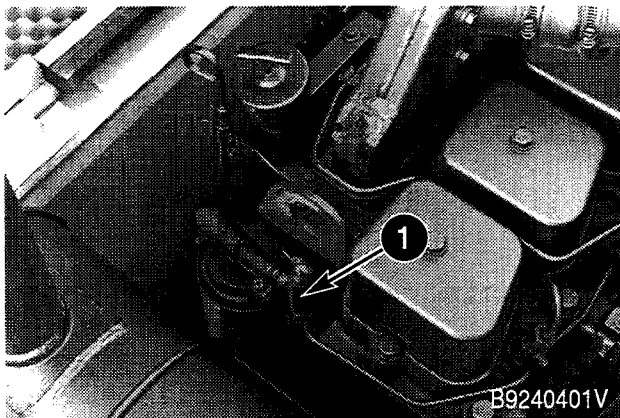

1. Shutoff Valve

F. Install a clear plastic hose on the air bleed valve of the aftercooler. Put the other end of the hose into a container.

G. Have another person help you at this time.

H. Start and run the engine at low idle. Close the air bleed valve on the aftercooler as soon as the coolant going through the clear plastic hose is free of air bubbles.

I. Stop the engine. Fill the radiator with coolant again and fill the coolant reservoir again.

J. Cover the outside of the radiator core (the side away from the fan) with cardboard.

K. Start and run the engine at high idle. Look at the water temperature gauge. When the water temperature gauge indicates normal operating temperature (4th or 5th bar illuminated), open the shutoff valve for the heater.

L. Continue to run the engine until the last amber bar illuminates, then remove the cardboard from the radiator.

M. Reduce the engine speed to low idle. Continue to run the engine at low idle for 30 seconds.

N. Stop the engine and let the coolant cool.

O. When the radiator feels COLD, remove the radiator cap and the cap for the coolant reservoir.

P. Fill the radiator with coolant. Install and tighten the radiator cap.

Q. Fill the coolant reservoir with coolant to the FULL mark. Install the cap for the coolant reservoir.

Section 2402

SPECIFICATION DETAILS

4-390 Diesel Engine

2402

IMPORTANT: *This engine was made using the metric measurement system. All measurements and checks must be made with metric tools to make sure of an accurate reading when inspecting parts.*

TABLE OF CONTENTS

RUN-IN INSTRUCTIONS.....	3
IDENTIFICATION MARKS	
Crankshaft	4
Cylinder Block.....	4
Cylinder Head.....	4
ENGINE SPECIFICATION DETAILS	
Cylinder Block.....	4
Service Cylinder Sleeve.....	5
Piston.....	5
Piston Pin.....	5
Piston Rings	6
Cylinder Head.....	6
Lifters	6
Connecting Rod	7
Crankshaft	8
Camshaft	9
Turbocharger	9
Gear Train.....	9
Rocker Arm Assembly.....	10
Intake Valve	10
Exhaust Valve	10
Valve Springs.....	11
Valve Seat Installation Dimensions	11
SPECIAL TORQUES.....	11-13

RUN-IN INSTRUCTIONS

Engine Lubrication

Fill the 4-390 engine crankcase with CC/SF, CD/SF, CE/SF or CF-4 service classification oil. Use the correct viscosity rating for the ambient air temperature. Install new oil filters after the engine is rebuilt.

Fill the 4T390 and the 4TA 390 engine crankcase with CE/SF or CF-4 service classification oil. Use the correct viscosity rating for the ambient air temperature. Install new oil filters after the engine is rebuilt.

Run-In Procedure for Rebuilt Engine

Step 1 Disconnect the wire to the electric shut-off on the injection pump so that the engine will not start. Crank the engine for 30 seconds until there is oil pressure, then reconnect the wire.

Step 2 Remove the air from the cooling system at the temperature sending unit.

Step 3 Run the engine at 1000 RPM minimum load for 5 minutes and check for oil leaks.

Step 4 During the Run-In, continue to check the oil pressure, coolant level, and coolant temperature.

Run-In Procedure for Rebuilt Engines (with a Dynamometer)

The following procedure must be followed when using a PTO dynamometer to Run-In the engine. The dynamometer will control the engine load at each speed and will remove stress on new parts during Run-In.

During the Run-In, continue to check the oil pressure, coolant level and coolant temperature.

STEP	TIME	ENGINE SPEED	DYNAMOMETER SCALE LOAD
1	5 Minutes	1000 RPM	50
2	5 Minutes	1100 RPM	1/2
3	5 Minutes	2200 RPM	Full

Run-In Procedure for Rebuilt Engines (without a Dynamometer)

STEP	TIME	ENGINE SPEED	LOAD
1	5 Minutes	1000 RPM	No Load
2	5 Minutes	1100 RPM	Light Load
3	5 Minutes	2200 RPM	Light Load

Run-In Procedure (Agriculture Equipment)

For the first 8 hours of field operation stay one gear lower than normal. For the next 12 hours DO NOT "lug" the engine. Prevent "lugging" by moving the lever to a lower gear. The engine must not be "lugged" below the rated engine RPM during early hours of life.

Run-In Procedure (Construction Equipment)

For the first 8 hours, operate the engine at full throttle maintaining a normal load. Avoid converter or hydraulic stall. The engine must not be "lugged" below the Rated Engine RPM (Do not stall the engine more than 10 seconds).

IDENTIFICATION MARKS

Crankshaft

Letter N = Nitroc Hardened, crankshaft must be rehardened to a minimum hardness of 450 HV 0.2 rockwell any time the crankshaft has been reconditioned.

Cylinder Block

Letter X = The cylinder block has been refaced and up to 0.25 mm has been removed. Use a thicker head gasket (two notches).

Letter XX = The cylinder block has been refaced and up to 0.50 mm has been removed. Use a thicker head gasket (three notches).

Cylinder Head

Letter G = Thermostat passage in cylinder did not need to be machined.

Letter M = Thermostat passage in cylinder head was machined.

Letter V = Valve seats have been machined.

Letter X = The cylinders in the cylinder block have been bored oversize. Use a head gasket with oversize cylinder holes (one notch). This gasket is used for standard replacement, 0.5 mm oversize and 1.0 mm oversize bore.

Letter XX = The cylinder block has been refaced and up to 0.25 mm has been removed use a thicker head gasket (two notches).

Letter XXX = The cylinder block has been refaced and up to 0.50 mm has been removed. Use a thicker head gasket (three notches).

Numbers = RH rear corner of cylinder head indicates the amount of material removed from the cylinder head.

ENGINE SPECIFICATION DETAILS

Cylinder Block

	Metric Value
Type.....	Non-Sleeved
Material.....	Cast Iron
ID of Cylinder	102.00 to 102.04 mm
Maximum Service Limit	102.116 mm
Cylinder Out of Round (Maximum).....	0.038 mm
Cylinder Taper (Maximum).....	0.076 mm
0.5 mm Oversize Piston	
Machine Cylinder Bore to	102.40 to 102.44 mm
Hone to (Finished Diameter)	102.50 to 102.54 mm
1.00 mm Oversize Piston	
Machine Cylinder Bore to	102.90 to 102.94 mm
Hone to (Finished Diameter)	103.00 to 103.04 mm
Warpage (Maximum).....	0.075 mm
Maximum Material Removal.....	0.50 mm

Service Cylinder Sleeve

Type.....	Dry, Can Be Replaced
Material.....	Cast Iron
Machine Cylinder Block Bore to	104.485 to 104.515 mm
Installation	Press Fit
Machine Sleeve Bore to:	
Standard Size Piston (Finished Diameter)	102.00 to 102.04 mm
0.5 mm Oversize Piston	
Machine Cylinder Bore to	102.40 to 102.44 mm
Hone to (Finished Diameter)	102.50 to 102.54 mm
1.0 mm Oversize Piston	
Machine Cylinder Bore to	102.90 to 102.94 mm
Hone to (Finished Diameter)	103.00 to 103.04 mm

Piston

Type.....	Cam Ground
Material.....	Aluminum Alloy
OD at 12 mm From the Bottom, 90 Degrees Piston Pin	
Standard Size Piston	101.873 to 101.887 mm
Minimum Service Limit.....	101.823 mm
0.5 mm Oversize Piston	102.373 to 102.387 mm
Minimum Service Limit.....	101.323 mm
1.0 mm Oversize Piston	102.873 to 102.887 mm
Minimum Service Limit.....	102.823 mm
ID of Piston Pin Bore.....	40.006 to 40.012 mm
Maximum Service Limit	40.025 mm
Width of 1st Ring Groove (Top).....	2.465 to 2.485 mm
Width of 2nd Ring Groove (Intermediate).....	2.425 to 2.445 mm
Width of 3rd Ring Groove (Oil Ring)	4.040 to 4.060 mm
Protrusion Above Cylinder Block (Maximum).....	0.660 mm
Protrusion Above Cylinder Block (Minimum).....	0.280 mm

Piston Pin

Type.....	Full Float
OD of Pin.....	39.997 to 40.003 mm
Minimum Service Limit	39.990 mm

Piston Rings

No. 1 Compression 4T-390 Engine	Key Stone Type (Barrel Face)
End Gap in 102.02 ID	0.4 to 0.70 mm
No. 1 Compression 4-390 Engine	Rectangular Type (Barrel Face)
End Gap in 102.02 ID	0.25 to 0.55 mm
Maximum Service Limit	0.806 mm
Side Clearance	0.075 to 0.120 mm
Maximum Service Limit	0.15 mm
No. 2 Compression	Rectangular Type (Tapper Face)
End Gap in 102.02 ID	0.25 to 0.55 mm
Maximum Service Limit	0.806 mm
Side Clearance	0.075 to 0.120 mm
Maximum Service Limit	0.15 mm
No. 3 Oil Control Rings	Two Piece
End Gap in 102.02 ID	0.25 to 0.55 mm
Maximum Service Limit	0.806 mm
Side Clearance	0.130 mm

Cylinder Head

Warpage (Maximum)	0.20 mm
Maximum Material Removal	1.00 mm
Minimum Head Height	93.75 mm
Engines Manufactured in U.S.A.:	
Prior to Engine Serial Number 45511034	Injector Nozzle 9 mm
Engine Serial Number 45511034 and After	Injector Nozzle 7 mm
Engines Manufactured in Darlington England:	
Prior to Engine Serial Number 21092870	Injector Nozzle 9 mm
Engine Serial Number 21092870 and After	Injector Nozzle 7 mm
Engines Manufactured in Neuss Germany:	
Prior to Engine Serial Number 52107489	Injector Nozzle 9 mm
Engine Serial Number 52107489 and After	Injector Nozzle 7 mm

Lifters

Material	Hardened Iron
OD of Lifter	15.961 to 15.977 mm
Minimum Service Limit	15.960 mm
Bore Diameter in Block	16.000 to 16.030 mm
Maximum Service Limit	16.055 mm

Connecting Rod

Bushing	Steel Backed Leaded Bronze
Bushing ID Installed (Ream to Size).....	40.053 to 40.067 mm
Maximum Service Limit	40.092 mm
Bearing Liners	Replaceable
Journal ID Without Bearing Liners	72.987 to 73.013 mm
Bearing Oil Clearance.....	0.038 to 0.116 mm
Maximum Service Limit	0.129 mm
Side Clearance.....	0.100 to 0.300 mm
Maximum Service Limit	0.330 mm
Connecting Rod Bend (Maximum)	
Without Bushing	0.200 mm
With Bushing	0.150 mm
Connecting Rod Twist (Maximum)	
Without Bushing	0.500 mm
With Bushing	0.300 mm
Connecting Rod Bolt Maximum.....	59.25

Crankshaft

Type.....	Hardened Steel, Balanced
Main Bearing Liners	Replaceable
End Clearance, Center Main Bearing Cap	0.13 to 0.25 mm
Center Main Bearing Thrust Surface Thickness.....	2.50 mm
Connecting Rod Journal	
OD, Standard	68.987 to 69.013 mm
Maximum Service Limit.....	68.962 mm
0.25 mm OD Undersize, Grind to	68.737 to 68.763 mm
Maximum Service Limit.....	68.712 mm
0.50 mm OD Undersize, Grind to	68.487 to 68.513 mm
Maximum Service Limit.....	68.462 mm
0.75 mm OD Undersize, Grind to	68.237 to 68.263 mm
Maximum Service Limit.....	68.212 mm
1.00 mm OD Undersize, Grind to	67.987 to 68.013 mm
Maximum Service Limit.....	67.962 mm
Connecting Rod Journal Maximum Taper.....	0.013 mm
Journals Out of Round Maximum.....	0.050 mm
Undersize Main Bearing Liners For Service	0.25, 0.50, 0.75 and 1.00 mm
Main Bearing Oil Clearance.....	0.041 to 0.119 mm
Maximum Service Limit	0.140 mm
Main Bearing Journal	
OD, Standard	82.987 to 83.013 mm
Maximum Service Limit.....	82.962 mm
0.25 mm OD Undersize, Grind to	82.737 to 82.763 mm
Maximum Service Limit.....	82.712 mm
0.50 mm OD Undersize, Grind to	82.487 to 82.513 mm
Maximum Service Limit.....	82.462 mm
0.75 mm OD Undersize, Grind to	82.237 to 82.263 mm
Maximum Service Limit.....	82.212 mm
1.00 mm OD Undersize, Grind to	81.987 to 82.013 mm
Maximum Service Limit.....	81.962 mm
Main Bearing Journal Bore ID No Liners.....	87.982 to 88.018 mm
Maximum Service Limit	88.031 mm
Main Journal Width:	
1st, 2nd, 3rd, 5th.....	37.424 to 37.576 mm
4th.....	37.475 to 37.525 mm
Connect Rod Journals Width.....	38.950 to 39.050 mm
Main Bearing Bolt Maximum Length	119.25 mm

This as a preview PDF file from best-manuals.com



Download full PDF manual at best-manuals.com