

CX130D Crawler Excavator

SERVICE MANUAL

Part number 51436799

English

February 2018

© 2018 CNH Industrial Italia S.p.A. All Rights Reserved.

CASE
CONSTRUCTION



SERVICE MANUAL

CX130D Crawler excavators LC version (TIER4 FINAL) - EU Market
CX130D Crawler excavators Standard w/Blade version (TIER 4 FINAL) - EU market
CX130D Long Reach Crawler excavators LC Long Reach (Tier 4 FINAL) - EU Market

Contents

INTRODUCTION

Engine.....	10
[10.001] Engine and crankcase	10.1
[10.102] Pan and covers	10.2
[10.106] Valve drive and gears	10.3
[10.101] Cylinder heads	10.4
[10.105] Connecting rods and pistons.....	10.5
[10.103] Crankshaft and flywheel.....	10.6
[10.216] Fuel tanks	10.7
[10.206] Fuel filters	10.8
[10.218] Fuel injection system.....	10.9
[10.202] Air cleaners and lines	10.10
[10.250] Turbocharger and lines.....	10.11
[10.254] Intake and exhaust manifolds and muffler	10.12
[10.500] Selective Catalytic Reduction (SCR) exhaust treatment.....	10.13
[10.501] Exhaust Gas Recirculation (EGR) exhaust treatment.....	10.14
[10.400] Engine cooling system	10.15
[10.414] Fan and drive	10.16
[10.310] Aftercooler.....	10.17
[10.304] Engine lubrication system.....	10.18
Hydraulic systems.....	35
[35.000] Hydraulic systems.....	35.1
[35.300] Reservoir, cooler, and filters.....	35.2
[35.106] Variable displacement pump	35.3
[35.102] Pump control valves.....	35.4
[35.359] Main control valve.....	35.5
[35.357] Pilot system	35.6

[35.355] Hydraulic hand control	35.7
[35.356] Hydraulic foot control.....	35.8
[35.352] Hydraulic swing system	35.9
[35.353] Hydraulic travel system	35.10
[35.354] Hydraulic central joint	35.11
[35.736] Boom hydraulic system	35.12
[35.737] Dipper hydraulic system.....	35.13
[35.741] Dozer blade cylinders	35.14
[35.738] Excavator and backhoe bucket hydraulic system.....	35.15
[35.360] Hammer and rotating bucket hydraulic system	35.16
Frames and ballasting	39
[39.140] Ballasts and supports	39.1
Tracks and track suspension.....	48
[48.130] Track frame and driving wheels	48.1
[48.100] Tracks	48.2
[48.134] Track tension units	48.3
[48.138] Track rollers	48.4
Cab climate control	50
[50.100] Heating	50.1
[50.200] Air conditioning.....	50.2
Electrical systems	55
[55.000] Electrical system	55.1
[55.100] Harnesses and connectors.....	55.2
[55.525] Cab engine controls.....	55.3
[55.015] Engine control system.....	55.4
[55.201] Engine starting system	55.5
[55.301] Alternator.....	55.6
[55.302] Battery.....	55.7

[55.202] Cold start aid	55.8
[55.011] Fuel tank system	55.9
[55.010] Fuel injection system	55.10
[55.014] Engine intake and exhaust system	55.11
[55.988] Selective Catalytic Reduction (SCR) electrical system	55.12
[55.989] Exhaust Gas Recirculation (EGR) electrical system	55.13
[55.012] Engine cooling system	55.14
[55.013] Engine oil system	55.15
[55.640] Electronic modules	55.16
[55.512] Cab controls	55.17
[55.036] Hydraulic system control	55.18
[55.051] Cab Heating, Ventilation, and Air-Conditioning (HVAC) controls	55.19
[55.050] Heating, Ventilation, and Air-Conditioning (HVAC) control system	55.20
[55.524] Cab controls (Lift arm, Boom, Dipper, Bucket)	55.21
[55.416] Swing control system	55.22
[55.417] Travel control system	55.23
[55.530] Camera	55.24
[55.518] Wiper and washer system	55.25
[55.404] External lighting	55.26
[55.514] Cab lighting	55.27
[55.408] Warning indicators, alarms, and instruments	55.28
[55.992] Anti-theft system	55.29
[55.DTC] FAULT CODES	55.30
Booms, dippers, and buckets	84
[84.910] Boom	84.1
[84.912] Dipper arm	84.2
[84.100] Bucket	84.3
Dozer blade and arm	86

[86.110] Dozer blade	86.1
Platform, cab, bodywork, and decals	90
[90.150] Cab.....	90.1
[90.154] Cab doors and hatches	90.2
[90.156] Cab windshield and windows	90.3
[90.118] Protections and footboards.....	90.4
[90.120] Mechanically-adjusted operator seat.....	90.5
[90.100] Engine hood and panels	90.6



INTRODUCTION

Contents

INTRODUCTION

Foreword - Important notice regarding equipment servicing	3
Safety rules	4
Safety rules - General information	5
Safety rules - Personal safety	6
Safety rules - ROPS judgment	8
Safety rules - Ecology and the environment	10
Torque - Bolt and nut	11
Torque - Special torque setting	12
Basic instructions - Shop and assembly	16
General specification (*)	18
General specification (*)	22
General specification (*)	26
General specification - Main equipment (*)	30
General specification - Main equipment (*)	41
General specification - Main equipment (*)	51
Weight (*)	61
Weight (*)	64
Weight (*)	67
Dimension (*)	69
Dimension (*)	72
Dimension (*)	75
Conversion factors	76
Fluids and lubricants	88
Abbreviation	91
Product identification	94
Product identification - Machine orientation	97

(*) See content for specific models

Foreword - Important notice regarding equipment servicing

All repair and maintenance work listed in this manual must be carried out only by qualified dealership personnel, strictly complying with the instructions given, and using, whenever possible, the special tools.

Anyone who performs repair and maintenance operations without complying with the procedures provided herein shall be responsible for any subsequent damages.

The manufacturer and all the organizations of its distribution chain, including - without limitation - national, regional, or local dealers, reject any responsibility for damages caused by parts and/or components not approved by the manufacturer, including those used for the servicing or repair of the product manufactured or marketed by the manufacturer. In any case, no warranty is given or attributed on the product manufactured or marketed by the manufacturer in case of damages caused by parts and/or components not approved by the manufacturer.

The manufacturer reserves the right to make improvements in design and changes in specifications at any time without notice and without incurring any obligation to install them on units previously sold. Specifications, descriptions, and illustrative material herein are as accurate as known at time of publication but are subject to change without notice.

In case of questions, refer to your CASE CONSTRUCTION Sales and Service Networks.

Safety rules

Personal safety





This is the safety alert symbol. It is used to alert you to potential personal injury hazards. Obey all safety messages that follow this symbol to avoid possible death or injury.

Throughout this manual you will find the signal words DANGER, WARNING, and CAUTION followed by special instructions. These precautions are intended for the personal safety of you and those working with you.

Read and understand all the safety messages in this manual before you operate or service the machine.

 DANGER indicates a hazardous situation that, if not avoided, will result in death or serious injury.

 WARNING indicates a hazardous situation that, if not avoided, could result in death or serious injury.

 CAUTION indicates a hazardous situation that, if not avoided, could result in minor or moderate injury.

FAILURE TO FOLLOW DANGER, WARNING, AND CAUTION MESSAGES COULD RESULT IN DEATH OR SERIOUS INJURY.

Machine safety

NOTICE: Notice indicates a situation that, if not avoided, could result in machine or property damage.

Throughout this manual you will find the signal word Notice followed by special instructions to prevent machine or property damage. The word Notice is used to address practices not related to personal safety.

Information

NOTE: Note indicates additional information that clarifies steps, procedures, or other information in this manual.

Throughout this manual you will find the word Note followed by additional information about a step, procedure, or other information in the manual. The word Note is not intended to address personal safety or property damage.

Safety rules - General information

Cleaning

Clean the metal parts with cleaning solution that meets the standard and steam cleaning. (except for bearings)

After cleaning, dry well, and inject oil in all parts.

Also inject oil into the bearings after drying.

Inspection

When disassembling parts, check all the parts.

If there are any worn or damaged parts, replace them.

Inspect carefully to prevent initial breakdowns.

Bearing

Replace any loose bearings.

Air dry bearings before installing them.

Needle bearing

When inserting needle bearings, be very careful not to damage them.

Apply grease to the section where the needle bearing will be inserted.

Gear

Check that there is no wear and no damage.

Oil seal, O-ring, gasket

Always install new oil seals, O-rings, and gaskets.

Apply grease to sections where oil seals and O-rings will be inserted.

Shaft

Check that there is no wear and no damage.

Check the bearings and check for damaged oil seals on the shaft.

Service parts

Install CASE CONSTRUCTION genuine service parts.

When placing an order, check the parts catalog. It contains the CASE CONSTRUCTION genuine part numbers.

Any breakdowns arising from the installation of non-genuine parts are not covered by the warranty.

Lubricants (fuel, hydraulic oil)

Use the oil from the specified company or specified in the operator's manual or service Manual.

Any breakdowns arising from any fuel or hydraulic oil other than those specified are not covered by the warranty.

Safety rules - Personal safety

 **WARNING:**

This symbol indicates a precaution.
It gives information concerning the safety of the operator and those in the surroundings.
Read and understand these precautions thoroughly before performing the work.

Always comply with warnings and precautions so as to avoid any accidents.

This section covers information related to overall safety.

Check whether all warning labels are in place.

Additional labels can be ordered from Service Parts.

 **WARNING:**

Read the operator's manual to gain a thorough understanding of machine control operations.

 **WARNING:**

Perform any machine operations from the seating position.
Any other method may cause severe injuries.

 **WARNING:**

Only the one operator is to ride on the machine. No one else is to ride on it.

 **WARNING:**

Check the safety messages in the operator's manual before starting the engine.
Check all the warning labels on the machine.
Check that no one is within the machine's operating range.
Check the operating methods in a safe location before starting the actual work.
Understand the machine operations well, then operate in compliance with all service-related laws and regulations.
The operator's manual can be purchased at your CASE CONSTRUCTION dealer.

 **WARNING:**

Working with sloppy clothes or clothes with which safety cannot be ensured leads to damage to the machine and injury to the operator.
Always wear clothes that ensures safety.
In order to work more safely, it is recommended to wear additional safety equipment.
Helmet, safety shoes, ear protection, goggles, work clothes, and gloves

 **WARNING:**

Pay careful attention when working with the engine running.

 **WARNING:**

Check hydraulic equipment.
Work according to the procedure.
Do not change the procedure.

INTRODUCTION

 WARNING:

Check that there is no one in the surroundings before draining the pressure from hydraulic circuits during machine hydraulic cylinder inspection.

 WARNING:

Use gloves when handling high-temperature parts.

 WARNING:

Bring the lower parts or attachments in contact with the ground before inspecting or repairing them.

 WARNING:

Check that hoses and tubes are securely connected.
If there is any damage to a hose or tube, replace it.
Do not check for oil leaks by hand. Use cardboard or wood.

 WARNING:

When removing an attachment pin or other hardened pin, use a hammer that has a soft head.

 WARNING:

Wear eye protection when using a hammer to install a pin or when working with a grinder.
At this time, use goggles or eye protectors that meet standards.

 WARNING:

Park the machine in a safe location when repairing or inspecting it.

 WARNING:

Use work site protection when repairing the machine.
Check the oil, coolant, grease, and tools.
Recover materials and parts as necessary.
Pay enough attention to safety.

 WARNING:

Some of the machine's parts are extremely heavy.
Use an appropriate lifting equipment for such parts.
For weights and procedures, see the Service Manual.

 WARNING:

Exhaust gases are toxic.
Always provide good ventilation when working indoors or in any other enclosed space.

 WARNING:

If the electrolytic battery solution freezes, it may explode.

Safety rules - ROPS judgment

1. Purpose

Judge whether or not the model is compliant with ROPS by the ROPS criteria.

Compliance with ROPS is highly dependent on its deadweight and boom.

The model has passed the ROPS test for its deadweight with all selectable options installed (as of 2014).

However, the judgment is required because its deadweight or boom position may go beyond the assumption depending on derivative or order conditions.

2. ROPS criteria

Weight

For each class, the following weight shall not be exceeded.

If the weight is exceeded, a cab may become damaged in case of a rollover, causing the operator to die or become severely disabled.

It is not applicable beyond the criterion.

The ROPS-compliant model shall not exceed the weight shown in the table.

(The following weight is shown on the decal in the ROPS cab.)

Gross body weight	Class
20500 kg (45194.76 lb) or less	CX130D

Boom position

NOTICE: If you make such modification as lowers the boom position, ROPS is not applicable.

NOTICE: Consultation with us is required whenever it is assumed that the boom position is lowered by modification.

NOTICE: The range of change in the boom position cannot be determined uniformly.

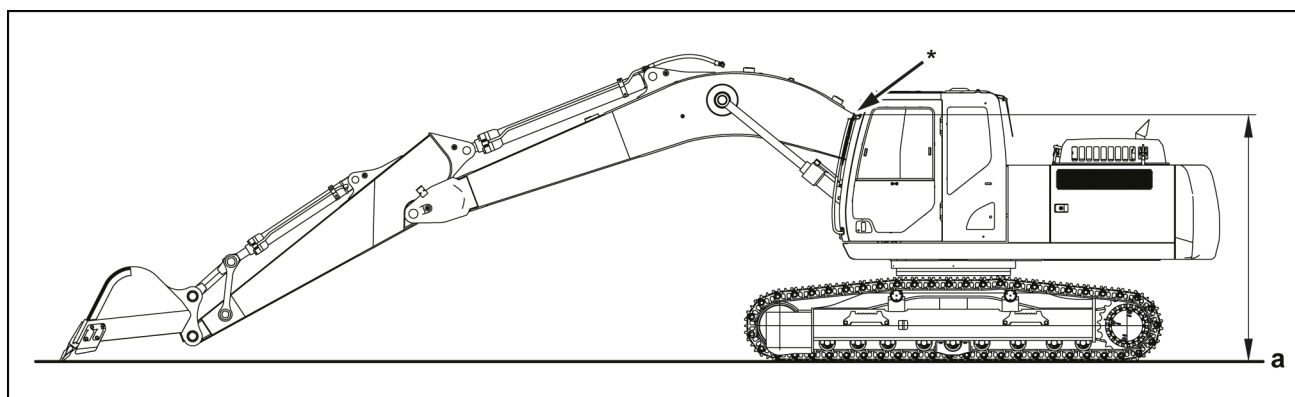

SML14CEX2001EA 1

a. Ground point

It is not applicable if the position overlapping with a cab on the side view (mark * in the figure) is lowered significantly as compared with the standard model (standard arm), within the maximum digging radius with the bucket tip on the surface of the ground.

Moreover, it cannot be said that the 24-ton model, close to the limit weight, with a cab that can bear up to 31-tons and the 21-ton model with the same cab are the same in the degree of influence.

3. Prohibitions

- Such modification as reduces the strength of the platform where the ROPS cab is installed. (Such action or modification as reduces the function of the retaining anchor in the left rear of the cab)
- Such modification as affects the ROPS strength of the ROPS cab.

Modification prohibited (Red components)	All changes (grinding, welding, drilling, removal, etc.) are prohibited.
Conditional modification permitted (Gray components)	Removal of components is prohibited. Welding and drilling of bars (limited to 20 mm (0.79 in) or less in diameter) are allowed.

Cab

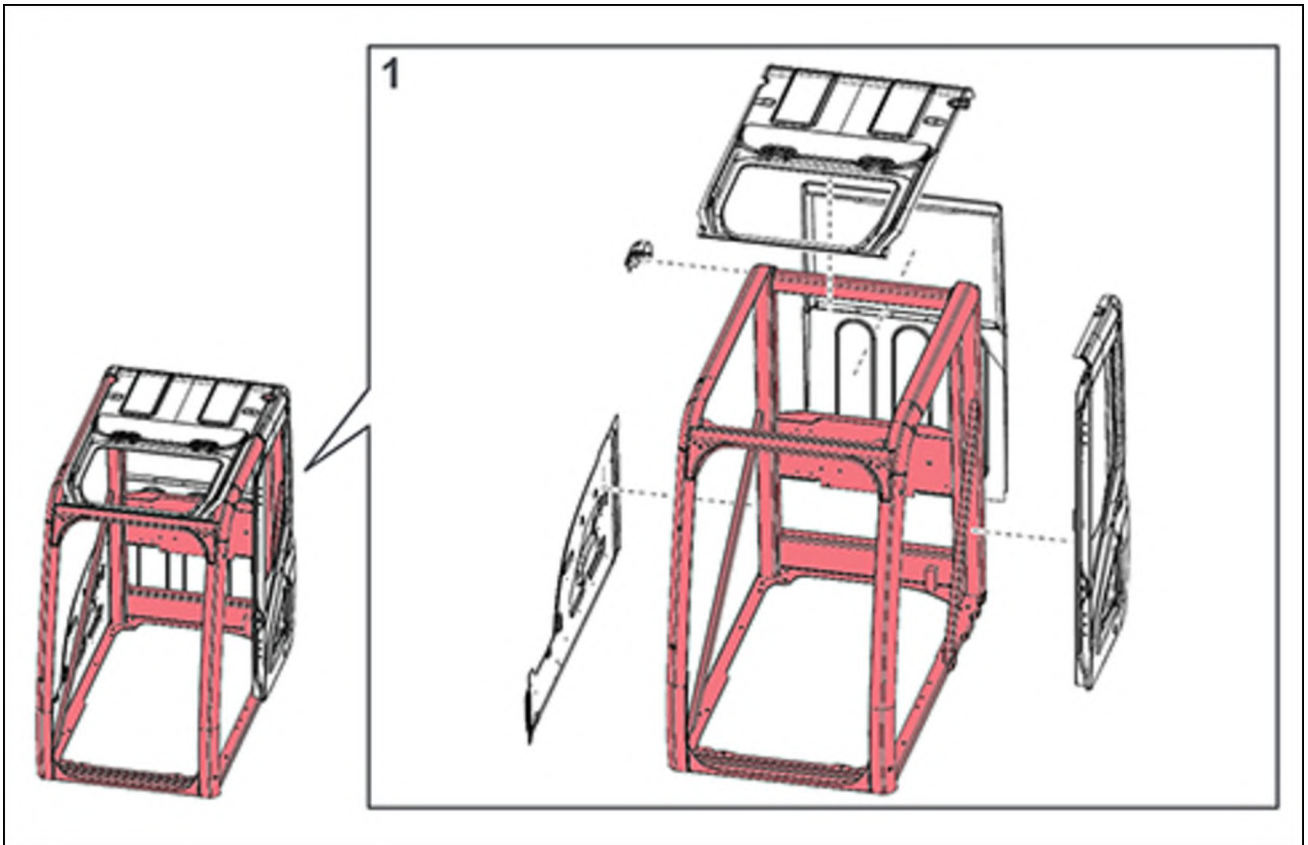

SMPH15CEX5805FA 2

Safety rules - Ecology and the environment

Soil, air, and water quality is important for all industries and life in general. When legislation does not yet rule the treatment of some of the substances that advanced technology requires, sound judgment should govern the use and disposal of products of a chemical and petrochemical nature.

Familiarize yourself with the relative legislation applicable to your country, and make sure that you understand this legislation. Where no legislation exists, obtain information from suppliers of oils, filters, batteries, fuels, anti-freeze, cleaning agents, etc., with regard to the effect of these substances on man and nature and how to safely store, use, and dispose of these substances.

Helpful hints

- Avoid the use of cans or other inappropriate pressurized fuel delivery systems to fill tanks. Such delivery systems may cause considerable spillage.
- In general, avoid skin contact with all fuels, oils, acids, solvents, etc. Most of these products contain substances that may be harmful to your health.
- Modern oils contain additives. Do not burn contaminated fuels and or waste oils in ordinary heating systems.
- Avoid spillage when you drain fluids such as used engine coolant mixtures, engine oil, hydraulic fluid, brake fluid, etc. Do not mix drained brake fluids or fuels with lubricants. Store all drained fluids safely until you can dispose of the fluids in a proper way that complies with all local legislation and available resources.
- Do not allow coolant mixtures to get into the soil. Collect and dispose of coolant mixtures properly.
- The air-conditioning system contains gases that should not be released into the atmosphere. Consult an air-conditioning specialist or use a special extractor to recharge the system properly.
- Repair any leaks or defects in the engine cooling system or hydraulic system immediately.
- Do not increase the pressure in a pressurized circuit as this may lead to a component failure.
- Protect hoses during welding. Penetrating weld splatter may burn a hole or weaken hoses, allowing the loss of oils, coolant, etc.

Battery recycling

Batteries and electric accumulators contain several substances that can have a harmful effect on the environment if the batteries are not properly recycled after use. Improper disposal of batteries can contaminate the soil, groundwater, and waterways. CASE CONSTRUCTION strongly recommends that you return all used batteries to a CASE CONSTRUCTION dealer, who will dispose of the used batteries or recycle the used batteries properly. In some countries, this is a legal requirement.



Mandatory battery recycling

NOTE: The following requirements are mandatory in Brazil.

Batteries are made of lead plates and a sulfuric acid solution. Because batteries contain heavy metals such as lead, CONAMA Resolution 401/2008 requires you to return all used batteries to the battery dealer when you replace any batteries. Do not dispose of batteries in your household garbage.

Points of sale are obliged to:

- Accept the return of your used batteries
- Store the returned batteries in a suitable location
- Send the returned batteries to the battery manufacturer for recycling

Torque - Bolt and nut

- Tighten alternating between left and right and top and bottom so that uniform tightening force is applied.

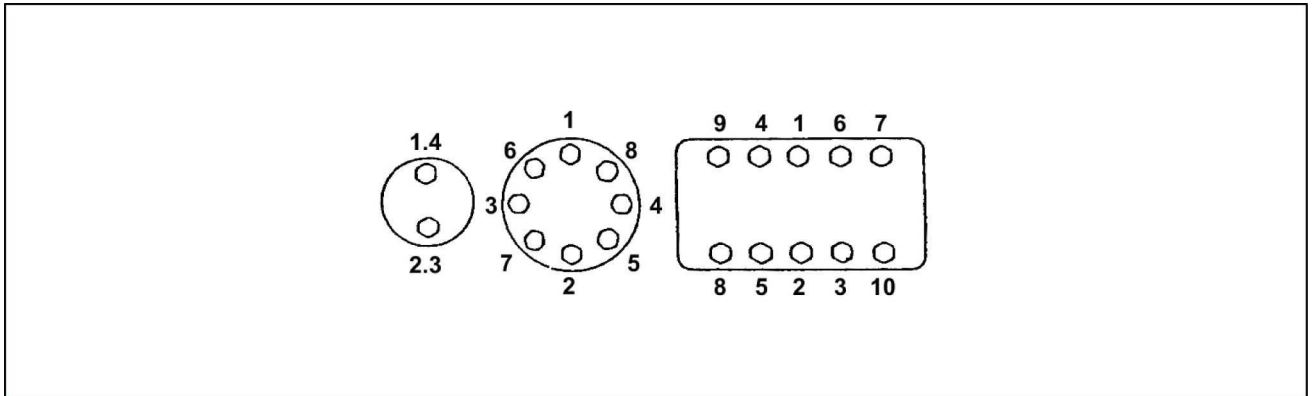

LPIL12CX00005EA 1

- If **LOCTITE®** was used on a removed bolt (there is something white sticking to the bolt when it is removed), clean the old **LOCTITE®** off with cleaning fluid, dry the bolt, then apply 2 - 3 drops of **LOCTITE®** to the thread section of the bolt.

Torque table

Bolt nominal diameter (size)		M6	M8	M10	M12	M14	M16	M18	M20
Hexagon bolt	Wrench	10 mm	13 mm	17 mm	19 mm	22 mm	24 mm	27 mm	30 mm
	Tightening torque	6.9 N·m (5.089 lb ft)	19.6 N·m (14.456 lb ft)	39.2 N·m (28.912 lb ft)	58.8 N·m (43.369 lb ft)	98.1 N·m (72.355 lb ft)	156.9 N·m (115.72 lb ft)	196.1 N·m (144.63 lb ft)	294.2 N·m (216.99 lb ft)
Hexagon socket head bolt	Wrench	5 mm	6 mm	8 mm	10 mm	12 mm	14 mm	14 mm	17 mm
	Tightening torque	8.8 N·m (6.491 lb ft)	21.6 N·m (15.931 lb ft)	42.1 N·m (31.051 lb ft)	78.5 N·m (57.899 lb ft)	117.7 N·m (86.811 lb ft)	176.5 N·m (130.18 lb ft)	245.2 N·m (180.85 lb ft)	343.2 N·m (253.13 lb ft)

Torque - Special torque setting

Code	Retightening location		Bolt nominal diameter	Wrench	Tightening torque
1*	Travel Motor		M16	24 mm	267 – 312 N·m (196.93 – 230.12 lb ft)
2*	Drive sprocket		M16	24 mm	267 – 312 N·m (196.93 – 230.12 lb ft)
3*	Take-up roller		M16	24 mm	267 – 312 N·m (196.93 – 230.12 lb ft)
4*	Upper roller		M16	24 mm	267 – 312 N·m (196.93 – 230.12 lb ft)
5*	Lower roller		M16	24 mm	267 – 312 N·m (196.93 – 230.12 lb ft)
6*	Track guard		M16	24 mm	267 – 312 N·m (196.93 – 230.12 lb ft)
7	Shoe		M16	24 mm	373 – 451 N·m (275.11 – 332.64 lb ft)
8	Counterweight		M27	41 mm	1078 – 1274 N·m (795.09 – 939.65 lb ft)
9	Turntable bearing	Lower frame	M16	24 mm	280 – 312 N·m (206.52 – 230.12 lb ft)
10		Swing frame	M16	24 mm	280 – 312 N·m (206.52 – 230.12 lb ft)
11*	Swing unit		M16	24 mm	280 – 312 N·m (206.52 – 230.12 lb ft)
12*	Engine	Engine mount (front)	M16	24 mm	264.9 – 313.9 N·m (195.38 – 231.52 lb ft)
13*		Engine mount (rear)	M16	24 mm	264.9 – 313.9 N·m (195.38 – 231.52 lb ft)
14*		Rear bracket	M12	19 mm	109 – 127 N·m (80.39 – 93.67 lb ft)
15	Radiator		M12	19 mm	63.8 – 73.6 N·m (47.06 – 54.28 lb ft)
16*	Hydraulic pump	Flange	M10	17 mm	63.7 – 72.6 N·m (46.98 – 53.55 lb ft)
17*		Pump	M16	14 mm hexagon socket head	223 – 247 N·m (164.48 – 182.18 lb ft)
18*	Hydraulic oil tank		M16	24 mm	232.4 – 276 N·m (171.41 – 203.57 lb ft)
19*	Fuel tank		M16	24 mm	232.4 – 276 N·m (171.41 – 203.57 lb ft)
20*	Urea tank		M16	24 mm	225.6 – 264.8 N·m (166.39 – 195.31 lb ft)
21*	Control valve		M16	24 mm	267 – 312 N·m (196.93 – 230.12 lb ft)
22*	Center Joint	Swing frame	M12	19 mm	88.3 – 107 N·m (65.13 – 78.92 lb ft)
23*		Lower frame	M12	19 mm	109 – 127 N·m (80.39 – 93.67 lb ft)
24	Cab		M16	24 mm	149 – 173 N·m (109.90 – 127.60 lb ft)
25	Battery		M10	17 mm	19.6 – 29.4 N·m (14.46 – 21.68 lb ft)

NOTICE: * mark indicates that the locations with this mark must be applied with **LOCTITE® 262™** or equivalent and tightened with the specified torque.

Tightening torque: **9.8 N·m (7.2 lb ft)**

Tighten bolts and nuts that are not specified in the above table, as follows:

Nominal bolt diameter (Size)		M6	M8	M10	M12	M14	M16	M18	M20
Hexagon bolt	Wrench	10 mm (0.394 in)	13 mm (0.512 in)	17 mm (0.669 in)	19 mm (0.748 in)	22 mm (0.866 in)	24 mm (0.945 in)	27 mm (1.063 in)	30 mm (1.181 in)
	Tightening torque	6.9 N·m (5.09 lb ft)	19.6 N·m (14.46 lb ft)	39.2 N·m (28.91 lb ft)	58.8 N·m (43.37 lb ft)	98.1 N·m (72.35 lb ft)	156.9 N·m (115.72 lb ft)	196.1 N·m (144.64 lb ft)	294.2 N·m (216.99 lb ft)
Hexagon socket head bolt	Wrench	5 mm (0.197 in)	6 mm (0.236 in)	8 mm (0.315 in)	10 mm (0.394 in)	12 mm (0.472 in)	14 mm (0.551 in)	14 mm (0.551 in)	17 mm (0.669 in)
	Tightening torque	8.8 N·m (6.49 lb ft)	21.6 N·m (15.93 lb ft)	42.1 N·m (31.05 lb ft)	78.5 N·m (57.90 lb ft)	117.7 N·m (86.81 lb ft)	176.5 N·m (130.18 lb ft)	245.2 N·m (180.85 lb ft)	343.2 N·m (253.13 lb ft)

INTRODUCTION

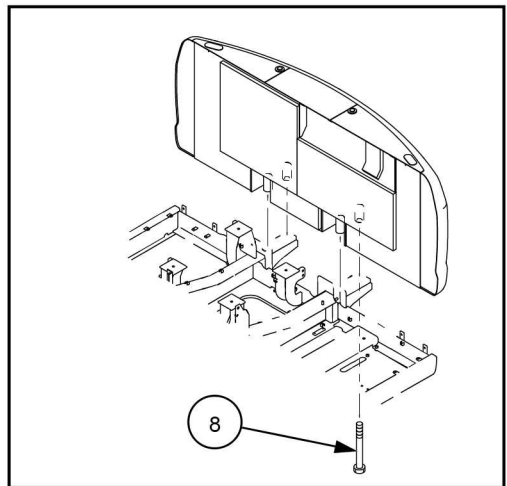
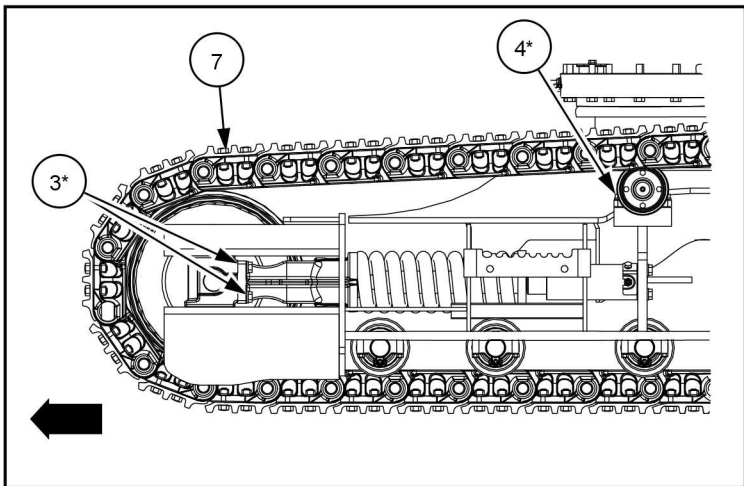
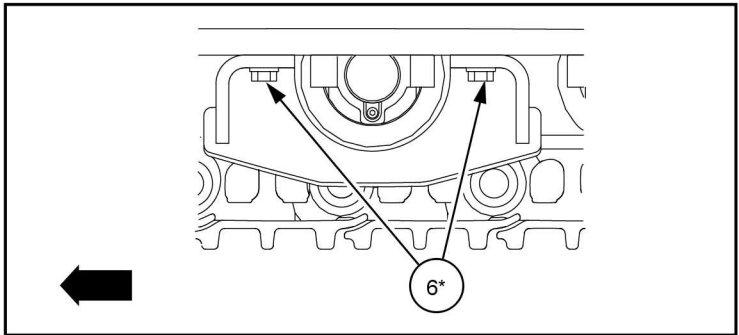
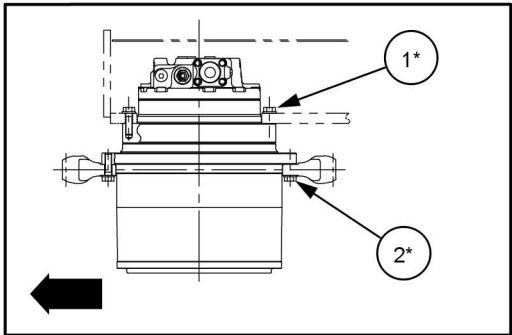
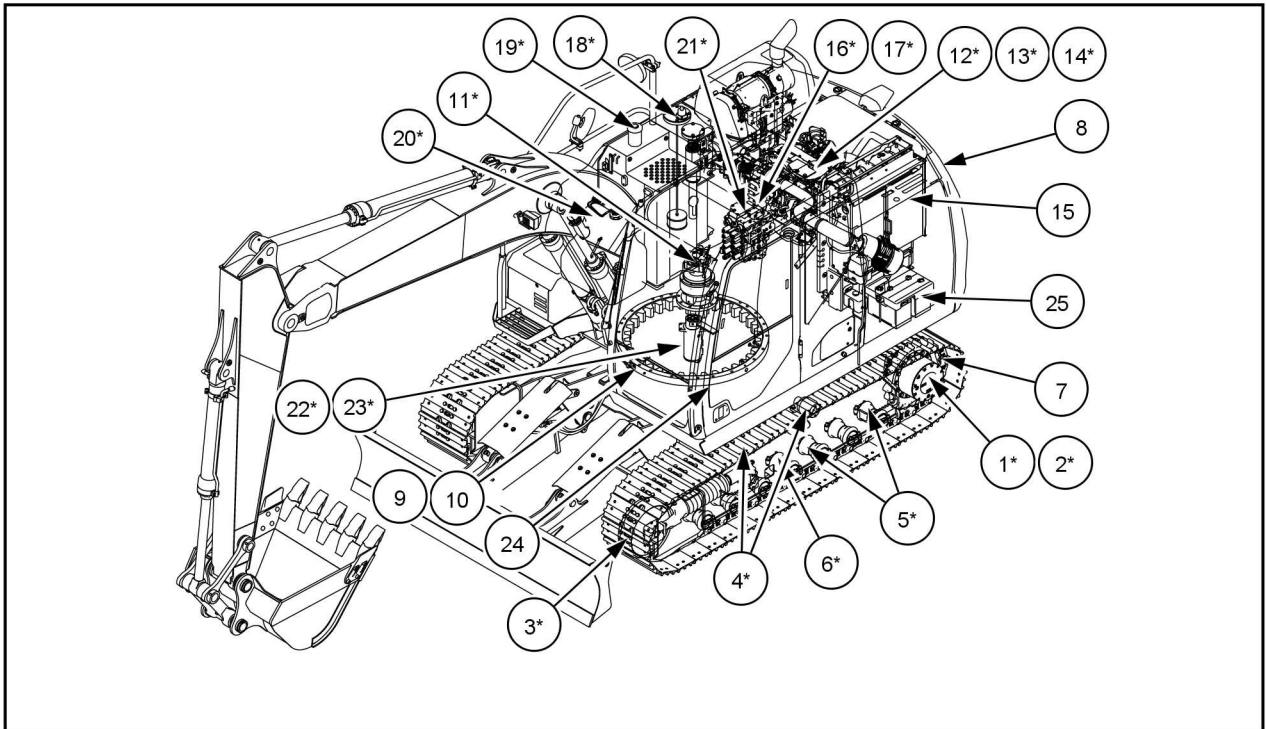

SML17CEX4866HB 1

INTRODUCTION

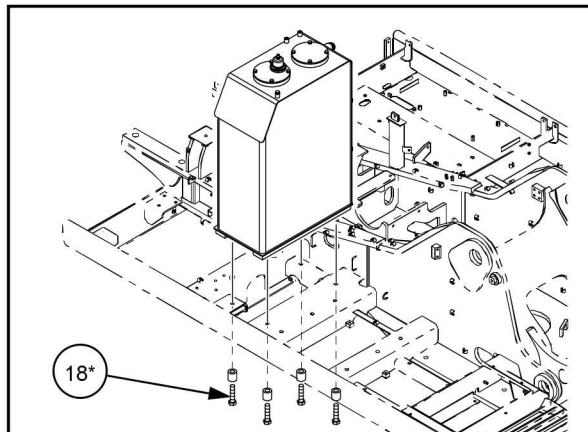
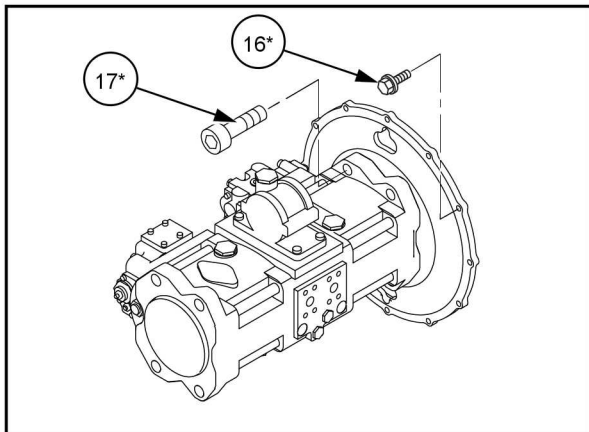
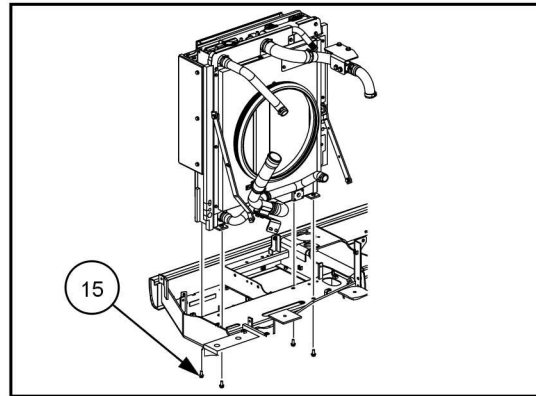
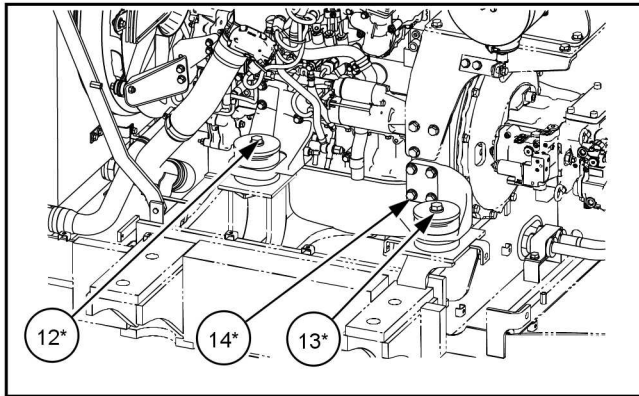
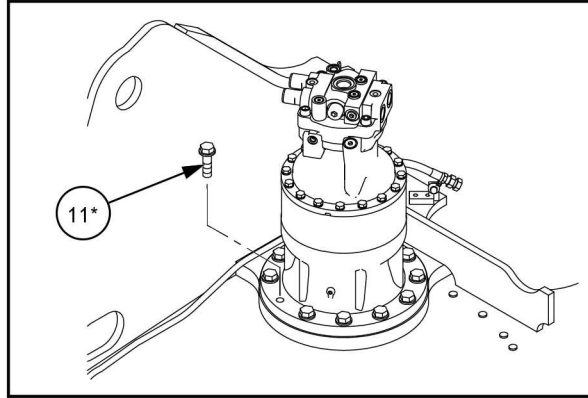
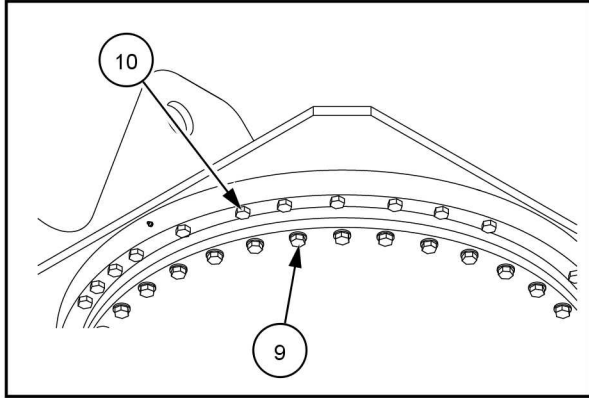

SMIL17CEX4867GB 2

INTRODUCTION

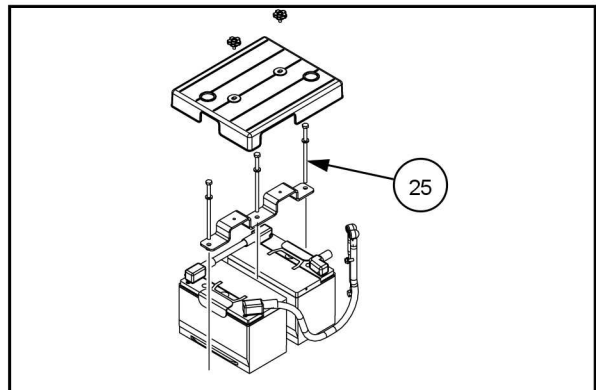
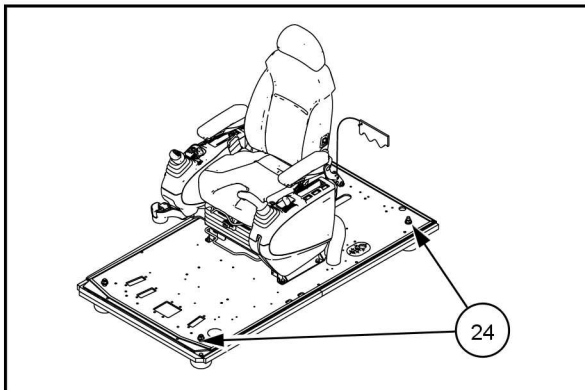
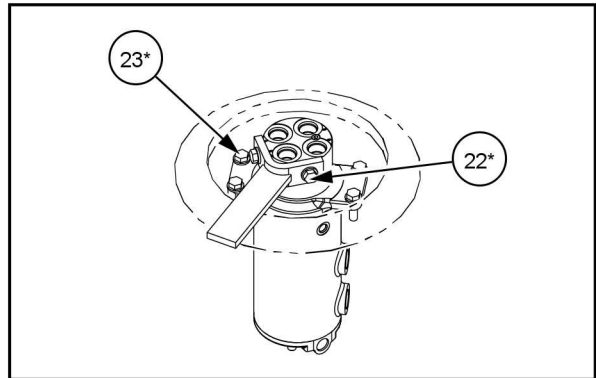
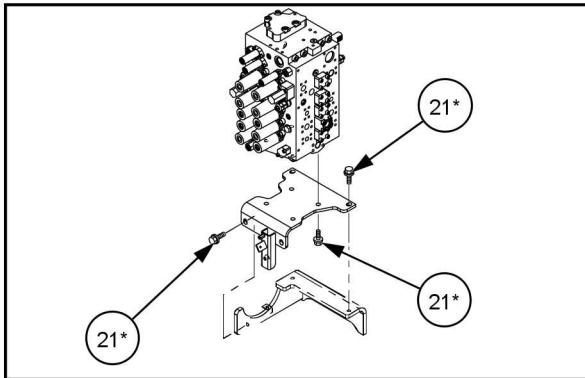
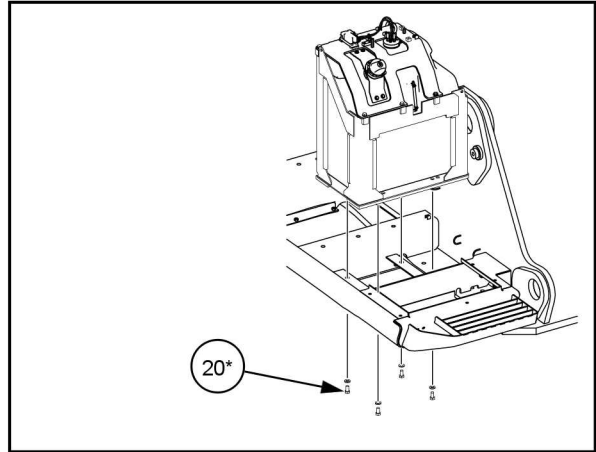
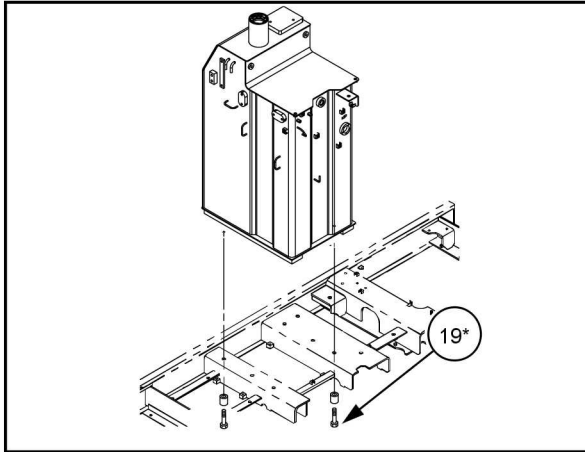

SML17CEX4868GB 3

Basic instructions - Shop and assembly

Shimming

For each adjustment operation, select adjusting shims and measure the adjusting shims individually using a micrometer, then add up the recorded values. Do not rely on measuring the entire shimming set, which may be incorrect, or the rated value shown on each shim.

Rotating shaft seals

For correct rotating shaft seal installation, proceed as follows:

1. Before assembly, allow the seal to soak in the oil it will be sealing for at least thirty minutes.
2. Thoroughly clean the shaft and check that the working surface on the shaft is not damaged.
3. Position the sealing lip facing the fluid.

NOTE: *With hydrodynamic lips, take into consideration the shaft rotation direction and position the grooves so that they will move the fluid towards the inner side of the seal.*

4. Coat the sealing lip with a thin layer of lubricant (use oil rather than grease). Fill the gap between the sealing lip and the dust lip on double lip seals with grease.
5. Insert the seal in its seat and press down using a flat punch or seal installation tool. Do not tap the seal with a hammer or mallet.
6. While you insert the seal, check that the seal is perpendicular to the seat. When the seal settles, make sure that the seal makes contact with the thrust element, if required.
7. To prevent damage to the seal lip on the shaft, position a protective guard during installation operations.

O-ring seals

Lubricate the O-ring seals before you insert them in the seats. This will prevent the O-ring seals from overturning and twisting, which would jeopardize sealing efficiency.

Sealing compounds

Apply a sealing compound on the mating surfaces when specified by the procedure. Before you apply the sealing compound, prepare the surfaces as directed by the product container.

Spare parts

Only use CNH Original Parts or CASE CONSTRUCTION Original Parts.

Only genuine spare parts guarantee the same quality, duration, and safety as original parts, as they are the same parts that are assembled during standard production. Only CNH Original Parts or CASE CONSTRUCTION Original Parts can offer this guarantee.

When ordering spare parts, always provide the following information:

- Machine model (commercial name) and Product Identification Number (PIN)
- Part number of the ordered part, which can be found in the parts catalog

Protecting the electronic and/or electrical systems during charging and welding

To avoid damage to the electronic and/or electrical systems, always observe the following practices:

1. Never make or break any of the charging circuit connections when the engine is running, including the battery connections.
2. Never short any of the charging components to ground.
3. Always disconnect the ground cable from the battery before arc welding on the machine or on any machine attachment.
 - Position the welder ground clamp as close to the welding area as possible.
 - If you weld in close proximity to a computer module, then you should remove the module from the machine.
 - Never allow welding cables to lie on, near, or across any electrical wiring or electronic component while you weld.
4. Always disconnect the negative cable from the battery when charging the battery in the machine with a battery charger.

NOTICE: *If you must weld on the unit, you must disconnect the battery ground cable from the machine battery. The electronic monitoring system and charging system will be damaged if this is not done.*

5. Remove the battery ground cable. Reconnect the cable when you complete welding.

⚠ WARNING

Battery acid causes burns. Batteries contain sulfuric acid. Avoid contact with skin, eyes or clothing. Antidote (external): Flush with water. Antidote (eyes): flush with water for 15 minutes and seek medical attention immediately. Antidote (internal): Drink large quantities of water or milk. Do not induce vomiting. Seek medical attention immediately. Failure to comply could result in death or serious injury.

W0111A

Special tools

The special tools that CASE CONSTRUCTION suggests and illustrate in this manual have been specifically researched and designed for use with CASE CONSTRUCTION machines. The special tools are essential for reliable repair operations. The special tools are accurately built and rigorously tested to offer efficient and long-lasting operation.

By using these tools, repair personnel will benefit from:

- Operating in optimal technical conditions
- Obtaining the best results
- Saving time and effort
- Working in safe conditions

General specification

CX130D Crawler excavators Standard w/Blade version (TIER 4 FINAL) - EU market	WE
--	----

Engine

Type	Water-cooled, 4-cycle diesel, 4-cylinder in line, High pressure common rail system (electric control), Turbocharger with air cooled intercooler, SCR system	
Model	ISUZU AR-4JJ1X	
Rated flywheel horse power		
	SAE J1349, ISO 9249	76.4 kW (102 Hp) at 2000 RPM
	ISO 14396	78.5 kW (105 Hp) at 2000 RPM
Piston displacement	2999 cm³ (183 in³)	
Maximum torque		
	SAE J1349, ISO 9249	349 N·m (257 lb ft) at 1800 RPM
	ISO 14396	356 N·m (263 lb ft) at 1800 RPM
Bore and stroke	95.4 – 104.9 mm (3.76 – 4.13 in)	
Voltage	24 V	
Alternator	50 A	
Starter	24 V 4.0 kW	

Hydraulic system

Main pumps	2 variable displacement axial piston pumps with regulating system	
	Max. oil flow	2 × 129 L (34.1 US gal) at 1800 RPM
	Working circuit pressure	Boom/Arm/Bucket
		34.3 MPa (4970 psi)
		Swing circuit
		27.9 MPa (4050 psi)
	Travel circuit	34.3 MPa (4970 psi)
Pilot pump	1 gear pump	
	Max. oil flow	20 L (5.3 US gal)
	Working circuit pressure	3.9 MPa (570 psi)
Blade pump	1 gear pump	
	Max. oil flow	54 L (14.3 US gal) at 2000 RPM
	Working circuit pressure	20.6 MPa (2988 psi)
Control valves	With Boom/Arm holding valve	
	One 4-spool valve for Right track travel, Bucket, Boom and Arm acceleration	
	One 5-spool valve for Left track travel, Auxiliary, Swing, Boom acceleration and Arm	
	One 1-spool valve for Blade	
Swing device		
	Motor	Fixed displacement axial piston motor
	Brake	Mechanical disc brake
	Final drive	Planetary gear reduction
	Turn table bearing	Ball bearing type with internal gear
	Maximum swing speed	14.3 RPM
	Swing torque	33000 N·m (24400 lb ft)
Cylinders	Number of cylinders – bore X Rod diameter X Stroke	
	Boom	2 x Ø 105 mm (4.134 in) - Ø 70 mm (2.756 in) - 961 mm (37.835 in)
	Arm	1 x Ø 115 mm (4.528 in) - Ø 80 mm (3.150 in) - 1108 mm (43.622 in)
	Bucket	1 x Ø 95 mm (3.740 in) - Ø 65 mm (2.559 in) - 881 mm (34.685 in)
	Blade	2x Ø 115 mm (4.528 in) - Ø 70 mm (2.756 in) - 250 mm (9.843 in)
Cooling system		

INTRODUCTION

Fan		Ø 550 mm (21.654 in) with 8-blades
Radiator capacity		74.1 kW
	fin type	Corrugated fin (wavy type)
	fin space	1.75 mm (0.06890 in)
Long life coolant		Coolant 55% , Water 45%
Oil cooler capacity		44.8 kW
	fin type	Corrugated fin (wavy type)
	fin space	1.75 mm (0.06890 in)
Intercooler capacity		10.8 kW
	fin type	Corrugated fin (wavy type)
	fin space	2.0 mm (0.0787 in)
Fuel cooler capacity		1.1 kW
	fin type	Corrugated fin (wavy type)
	fin space	2.0 mm (0.0787 in)
Filters		
Suction filter		105 µm
Return filter		6 µm
Pilot line filter		8 µm

Hydraulic controls

Boom/Arm/Bucket/Swing	Pilot pressure control system (ISO control pattern)
Travel	Pilot pressure control system
Work mode select	SP - mode
	H - mode
	Auto - mode
Travel mode select	2-speed travel
Attachment cushion control	
Hydraulic lock (gate lock, left side tilt console)	

Electrical system

Engine control	
	Dial type throttle control
	One touch idle / Auto deceleration / Auto idle shutdown system
	Emergency stop
Monitor system	
	Message display (Caution, condition, etc.)
	Work mode display (SP, H, Auto)
	Machine condition (Power boost, etc.)
	Alarm display and buzzer
	Water temperature
	Hydraulic oil temperature
	Fuel level
	Diagnosis system
	Rear view camera image
	Urea water level
Wire harness	
	Waterproof type connector
Safety	
	Double horn
Battery	2 X 12 V 72 A·h/5HR
Lights	
Working light	Upper 24 V 70 W X 1
	Boom 24 V 70 W X 1

INTRODUCTION

	Cab	24 V 70 W X 2
Operator's cab room		24 V 70 W X 1

Operator environment

Operator's cab		
	Smooth and round shape design cab, fabricated by press work	
	Safety glass for all windows	
	Shock-less cab suspension by 4-point fluid mounting	
	Sliding front window with auto lock	
	Built-in type full-color LCD monitor display	
	Membrane switch on monitor display	
	Windshield wiper & washer	
	Floor mat	
	Polycarbonate roof hatch & Sun shade	
	Auto air-conditioner	
	Rain deflector	
	Sun visor	
	Roll-over protective structure (ROPS)	
	Top guard OPG level 1 (in CAB structure)	
	Top guard OPG level 2 (additional guard)	
Operator's seat		
	Low frequency mechanical suspension with helical springs and double acting hydraulic damper. (Achieves ISO7096 in category EM6)	
	With following features	
	Manual weight adjustment	Backrest angle adjustment
	Seat height adjustment	Adjustable pivoting armrests linked to consoles
	Adjustable headrest	Retractable seat belt
	Adjustable lumbar support	Control consoles adjust independently of seat
Others		
	Rear view mirror (Cab side & Right side)	
	Rear view Camera	

Undercarriage

Travel motor	Variable displacement axial piston motor	
Brake	Mechanical disc brake	
Hydraulic service brake	Brake valve	
Final drive	Planetary gear reduction	
Travel speeds	High	5.6 km/h (3.5 mph) (Automatic travel speed shifting)
	Low	3.4 km/h (2.1 mph)
Drawbar pull	116 kN (26077.837 lb)	
Number of carrier rollers (each side)	1	
Number of track rollers (each side)	7	
Number of shoes (each side)	43	
Type of shoe	Triple grouser shoe	
Link pitch	171.5 mm (6.752 in)	
Width of shoe	600 mm (23.622 in) (S.T.D)	
Grade-ability	70% (35°)	

Dozer blade

Width of blade	2590 mm (101.969 in) [with 600 mm (23.622 in)]
Height of blade	570 mm (22.441 in)
Max. lift above ground	510 mm (20.079 in)
Max. drop below ground	520 mm (20.472 in)

Mass

Operating mass	14000 kg (30865 lb)
	with 2.50 m (8.20 ft) Arm, 0.5 m³ Bucket, 600 mm (23.622 in) grouser shoe, operator, lubricant, coolant, full fuel tank and top guard OPG level 2
Shipping mass	13300 kg (29321 lb)
	Operating mass - (operator mass [75 kg (165.35 lb)] + 90% of fuel mass [195 kg (429.901 lb)] + bucket mass [400 kg (881.849 lb)]
Counter weight mass	1990 kg (4387 lb)
Ground pressure	0.038 MPa (5.512 psi)
	with 2.50 m (8.20 ft) Arm, 0.5 m³ Bucket, 600 mm (23.622 in) grouser shoe

Digging force (with 0.5 m³ bucket) (ISO 6015)

	[2.50 m (8.2021 ft)] Arm	[3.01 m (9.8753 ft)] Arm	[2.11 m (6.9226 ft)] Arm
Arm digging force	62 kN (13938.15 lb)	56 kN (12589.30 lb)	70 kN (15736.63 lb)
With auto power up	66 kN (14837.39 lb)	60 kN (13488.54 lb)	74 kN (16635.86 lb)
Bucket digging force	90 kN (20232.80 lb)	90 kN (20232.80 lb)	90 kN (20232.80 lb)
With auto power up	95 kN (21356.85 lb)	95 kN (21356.85 lb)	95 kN (21356.85 lb)

Dimensions

	[2.50 m (8.2021 ft)] Arm	[3.01 m (9.8753 ft)] Arm	[2.11 m (6.9226 ft)] Arm
Overall length (without attachment)	4160 mm (163.780 in)	4160 mm (163.780 in)	4160 mm (163.780 in)
Overall length (with attachment)	7900 mm (311.024 in)	7900 mm (311.024 in)	7900 mm (311.024 in)
Overall height (to top of boom)	2770 mm (109.055 in)	2640 mm (103.937 in)	2680 mm (105.512 in)
Overall height (to top of Cab)	2920 mm (114.961 in)	2920 mm (114.961 in)	2920 mm (114.961 in)
Overall height (to top of handrail)	2810 mm (110.630 in)	2810 mm (110.630 in)	2810 mm (110.630 in)
Upper structure overall width	2530 mm (99.606 in)	2530 mm (99.606 in)	2530 mm (99.606 in)
Swing (rear end) radius	2170 mm (85.433 in)	2170 mm (85.433 in)	2170 mm (85.433 in)
Clearance height under upper structure	895 mm (35.236 in)	895 mm (35.236 in)	895 mm (35.236 in)
Minimum ground clearance	425 mm (16.732 in)	425 mm (16.732 in)	425 mm (16.732 in)
Wheel base (Center to center of wheels)	2790 mm (109.843 in)	2790 mm (109.843 in)	2790 mm (109.843 in)
Crawler overall length	3500 mm (137.795 in)	3500 mm (137.795 in)	3500 mm (137.795 in)
Track gauge	1990 mm (78.346 in)	1990 mm (78.346 in)	1990 mm (78.346 in)
Undercarriage overall width [with 600 mm (23.622 in) shoes]	2590 mm (101.969 in)	2590 mm (101.969 in)	2590 mm (101.969 in)
Crawler tracks height	780 mm (30.709 in)	780 mm (30.709 in)	780 mm (30.709 in)

Working ranges

	[2.50 m (8.2021 ft)] Arm	[3.01 m (9.8753 ft)] Arm	[2.11 m (6.9226 ft)] Arm
Boom length	4630 mm (182.283 in)	4630 mm (182.283 in)	4630 mm (182.283 in)
Bucket radius	1200 mm (47.244 in)	1200 mm (47.244 in)	1200 mm (47.244 in)
Bucket wrist action	178°	178°	178°
Maximum reach at GRP	8170 mm (321.654 in)	8640 mm (340.157 in)	7810 mm (307.480 in)
Maximum reach	8310 mm (327.165 in)	8770 mm (345.276 in)	7960 mm (313.386 in)
Max. digging depth	5550 mm (218.504 in)	6050 mm (238.189 in)	5160 mm (203.150 in)
Max. digging height	8770 mm (345.276 in)	9050 mm (356.299 in)	8550 mm (336.614 in)
Max. dumping height	6390 mm (251.575 in)	6680 mm (262.992 in)	6170 mm (242.913 in)

General specification

CX130D Crawler excavators LC version (TIER4 FINAL) - EU Market

WE

Engine

Type	Water-cooled, 4-cycle diesel, 4-cylinder in line, High pressure common rail system (electric control), Turbocharger with air cooled intercooler, SCR system	
Model	ISUZU AR-4JJ1X	
Rated flywheel horse power		
	SAE J1349, ISO 9249	76.4 kW (102 Hp) at 2000 RPM
	ISO 14396	78.5 kW (105 Hp) at 2000 RPM
Piston displacement	2999 cm³ (183 in³)	
Maximum torque		
	SAE J1349, ISO 9249	349 N·m (257 lb ft) at 1800 RPM
	ISO 14396	356 N·m (263 lb ft) at 1800 RPM
Bore and stroke	95.4 – 104.9 mm (3.76 – 4.13 in)	
Voltage	24 V	
Alternator	50 A	
Starter	24 V 4.0 kW	

Hydraulic system

Main pumps	2 variable displacement axial piston pumps with regulating system	
	Max. oil flow	2 × 129 L (34.1 US gal) at 1800 RPM
	Working circuit pressure	Boom/Arm/Bucket 34.3 MPa (4970 psi)
		Swing circuit 27.9 MPa (4050 psi)
		Travel circuit 34.3 MPa (4970 psi)
Pilot pump	1 gear pump	
	Max. oil flow	20 L (5.3 US gal)
	Working circuit pressure	3.9 MPa (570 psi)
Control valves	With Boom/Arm holding valve	
	One 4-spool valve for Right track travel, Bucket, Boom and Arm acceleration	
	One 5-spool valve for Left track travel, Auxiliary, Swing, Boom acceleration and Arm	
Swing device		
	Motor	Fixed displacement axial piston motor
	Brake	Mechanical disc brake
	Final drive	Planetary gear reduction
	Turn table bearing	Ball bearing type with internal gear
	Maximum swing speed	14.3 RPM
	Swing torque	33000 N·m (24400 lb ft)
Cylinders	Number of cylinders – bore X Rod diameter X Stroke	
	Boom	2 x Ø 105 mm (4.134 in) - Ø 70 mm (2.756 in) - 961 mm (37.835 in)
	Arm	1 x Ø 115 mm (4.528 in) - Ø 80 mm (3.150 in) - 1108 mm (43.622 in)
	Bucket	1 x Ø 95 mm (3.740 in) - Ø 65 mm (2.559 in) - 881 mm (34.685 in)
Cooling system		
	Fan	Ø 550 mm (21.654 in) with 8-blades
	Radiator capacity	74.1 kW
		fin type Corrugated fin (wavy type)
		fin space 1.75 mm (0.06890 in)
	Long life coolant	Coolant 55% , Water 45%

INTRODUCTION

Oil cooler capacity		44.8 kW
	fin type	Corrugated fin (wavy type)
	fin space	1.75 mm (0.06890 in)
Intercooler capacity		10.8 kW
	fin type	Corrugated fin (wavy type)
	fin space	2.0 mm (0.0787 in)
Fuel cooler capacity		1.1 kW
	fin type	Corrugated fin (wavy type)
	fin space	2.0 mm (0.0787 in)
Filters		
Suction filter		105 µm
Return filter		6 µm
Pilot line filter		8 µm

Hydraulic controls

Boom/Arm/Bucket/Swing	Pilot pressure control system (ISO control pattern)
Travel	Pilot pressure control system
Work mode select	SP - mode
	H - mode
	Auto - mode
Travel mode select	2-speed travel
Attachment cushion control	
Hydraulic lock (gate lock, left side tilt console)	

Electrical system

Engine control		
	Dial type throttle control	
	One touch idle / Auto deceleration / Auto idle shutdown system	
	Emergency stop	
Monitor system		
	Message display (Caution, condition, etc.)	
	Work mode display (SP, H, Auto)	
	Machine condition (Power boost, etc.)	
	Alarm display and buzzer	
	Water temperature	
	Hydraulic oil temperature	
	Fuel level	
	Diagnosis system	
	Rear view camera image	
	Urea water level	
Wire harness		
	Waterproof type connector	
Safety		
	Double horn	
Battery	2 X 12 V 72 A·h/5HR	
Lights		
Working light	Upper	24 V 70 W X 1
	Boom	24 V 70 W X 1
	Cab	24 V 70 W X 2
Operator's cab room		24 V 70 W X 1

Operator environment

Operator's cab		
	Smooth and round shape design cab, fabricated by press work	
	Safety glass for all windows	
	Shock-less cab suspension by 4-point fluid mounting	
	Sliding front window with auto lock	
	Built-in type full-color LCD monitor display	
	Membrane switch on monitor display	
	Windshield wiper & washer	
	Floor mat	
	Polycarbonate roof hatch & Sun shade	
	Auto air-conditioner	
	Rain deflector	
	Sun visor	
	Roll-over protective structure (ROPS)	
	Top guard OPG level 1 (in CAB structure)	
	Top guard OPG level 2 (additional guard)	
Operator's seat		
	Low frequency mechanical suspension with helical springs and double acting hydraulic damper. (Achieves ISO7096 in category EM6)	
	With following features	
	Manual weight adjustment	Backrest angle adjustment
	Seat height adjustment	Adjustable pivoting armrests linked to consoles
	Adjustable headrest	Retractable seat belt
	Adjustable lumbar support	Control consoles adjust independently of seat
Others		
	Rear view mirror (Cab side & Right side)	
	Rear view Camera	

Undercarriage

Travel motor		Variable displacement axial piston motor
Brake		Mechanical disc brake
Hydraulic service brake		Brake valve
Final drive		Planetary gear reduction
Travel speeds	High	5.6 km/h (3.5 mph) (Automatic travel speed shifting)
	Low	3.4 km/h (2.1 mph)
Drawbar pull		116 kN (26077.837 lb)
Number of carrier rollers (each side)		2
Number of track rollers (each side)		7
Number of shoes (each side)		46
Type of shoe		Triple grouser shoe
Link pitch		171.5 mm (6.752 in)
Width of shoe		600 mm (23.622 in) (S.T.D)
Grade-ability		70% (35°)

Mass

Operating mass		13400 kg (29542 lb)
with 2.50 m (8.20 ft) Arm, 0.5 m³ Bucket, 600 mm (23.622 in) grouser shoe, operator, lubricant, coolant, full fuel tank, and top guard OPG level 2		
Shipping mass		12700 kg (27999 lb)
Operating mass - (operator mass [75 kg (165.35 lb)] + 90% of fuel mass [195 kg (429.901 lb)] + bucket mass [400 kg (881.849 lb)]		
Counter weight mass		1990 kg (4387 lb)

Ground pressure	0.033 MPa (4.787 psi)
with 2.50 m (8.20 ft) Arm, 0.5 m³ Bucket, 600 mm (23.622 in) grouser shoe	

Digging force (with 0.5 m³ bucket) (ISO 6015)

	[2.50 m (8.2021 ft)] Arm	[3.01 m (9.8753 ft)] Arm	[2.11 m (6.9226 ft)] Arm
Arm digging force	62 kN (13938.15 lb)	56 kN (12589.30 lb)	70 kN (15736.63 lb)
With auto power up	66 kN (14837.39 lb)	60 kN (13488.54 lb)	74 kN (16635.86 lb)
Bucket digging force	90 kN (20232.80 lb)	90 kN (20232.80 lb)	90 kN (20232.80 lb)
With auto power up	95 kN (21356.85 lb)	95 kN (21356.85 lb)	95 kN (21356.85 lb)

Dimensions

	[2.50 m (8.2021 ft)] Arm	[3.01 m (9.8753 ft)] Arm	[2.11 m (6.9226 ft)] Arm
Overall length (without attachment)	4030 mm (158.661 in)	4030 mm (158.661 in)	4030 mm (158.661 in)
Overall length (with attachment)	7650 mm (301.181 in)	7640 mm (300.787 in)	7640 mm (300.787 in)
Overall height (to top of boom)	2770 mm (109.055 in)	2640 mm (103.937 in)	2680 mm (105.512 in)
Overall height (to top of Cab)	2920 mm (114.961 in)	2920 mm (114.961 in)	2920 mm (114.961 in)
Overall height (to top of handrail)	2810 mm (110.630 in)	2810 mm (110.630 in)	2810 mm (110.630 in)
Upper structure overall width	2530 mm (99.606 in)	2530 mm (99.606 in)	2530 mm (99.606 in)
Swing (rear end) radius	2170 mm (85.433 in)	2170 mm (85.433 in)	2170 mm (85.433 in)
Clearance height under upper structure	895 mm (35.236 in)	895 mm (35.236 in)	895 mm (35.236 in)
Minimum ground clearance	420 mm (16.535 in)	420 mm (16.535 in)	420 mm (16.535 in)
Wheel base (Center to center of wheels)	3040 mm (119.685 in)	3040 mm (119.685 in)	3040 mm (119.685 in)
Crawler overall length	3760 mm (148.031 in)	3760 mm (148.031 in)	3760 mm (148.031 in)
Track gauge	1990 mm (78.346 in)	1990 mm (78.346 in)	1990 mm (78.346 in)
Undercarriage overall width [with 600 mm (23.622 in) shoes]	2590 mm (101.969 in)	2590 mm (101.969 in)	2590 mm (101.969 in)
Crawler tracks height	780 mm (30.709 in)	780 mm (30.709 in)	780 mm (30.709 in)

Working ranges

	[2.50 m (8.2021 ft)] Arm	[3.01 m (9.8753 ft)] Arm	[2.11 m (6.9226 ft)] Arm
Boom length	4630 mm (182.283 in)	4630 mm (182.283 in)	4630 mm (182.283 in)
Bucket radius	1200 mm (47.244 in)	1200 mm (47.244 in)	1200 mm (47.244 in)
Bucket wrist action	178°	178°	178°
Maximum reach at GRP	8170 mm (321.654 in)	8640 mm (340.157 in)	7810 mm (307.480 in)
Maximum reach	8310 mm (327.165 in)	8770 mm (345.276 in)	7960 mm (313.386 in)
Max. digging depth	5550 mm (218.504 in)	6050 mm (238.189 in)	5160 mm (203.150 in)
Max. digging height	8770 mm (345.276 in)	9050 mm (356.299 in)	8550 mm (336.614 in)
Max. dumping height	6390 mm (251.575 in)	6680 mm (262.992 in)	6170 mm (242.913 in)

General specification

CX130D Long Reach Crawler excavators LC Long Reach (Tier 4 FINAL) - EU Market	WE
--	----

Engine

Type	Water-cooled, 4-cycle diesel, 4-cylinder in line, High pressure common rail system (electric control), Turbocharger with air cooled intercooler, SCR system	
Model	ISUZU AR-4JJ1X	
Rated flywheel horse power		
	SAE J1349, ISO 9249	76.4 kW (102 Hp) at 2000 RPM
	ISO 14396	78.5 kW (105 Hp) at 2000 RPM
Piston displacement	2999 cm³ (183 in³)	
Maximum torque		
	SAE J1349, ISO 9249	349 N·m (257 lb ft) at 1800 RPM
	ISO 14396	356 N·m (263 lb ft) at 1800 RPM
Bore and stroke	95.4 – 104.9 mm (3.76 – 4.13 in)	
Voltage	24 V	
Alternator	50 A	
Starter	24 V 4.0 kW	

Hydraulic system

Main pumps	2 variable displacement axial piston pumps with regulating system	
	Max. oil flow	2 × 129 L (34.1 US gal) at 2000 RPM
	Working circuit pressure	Boom up/Arm out
		34.3 MPa (4970 psi)
		Boom down
		36.3 MPa (5260 psi) with auto power up
		Arm in
		32.3 MPa (4685 psi)
		Bucket close
		22.6 MPa (3278 psi)
	Bucket open	
	20.6 MPa (2988 psi)	
	Swing circuit	
	31.4 MPa (4555 psi)	
	Travel circuit	
	24.0 MPa (3481 psi)	
	34.3 MPa (4970 psi)	
Pilot pump	1 gear pump	
	Max. oil flow	20 L (5.3 US gal)
	Working circuit pressure	3.9 MPa (570 psi)
Control valves	With boom/Arm holding valve	
	One 4-spool valve for Right track travel, Bucket, Boom and Arm acceleration	
	One 5-spool valve for Left track travel, Auxiliary, Swing, Boom acceleration and Arm	
Swing device		
	Motor	Fixed displacement axial piston motor
	Brake	Mechanical disc brake
	Final drive	Planetary gear reduction
	Turn table bearing	Ball bearing type with internal gear
	Maximum swing speed	14.3 RPM
	Swing torque	28400 N·m (20947 lb ft)
Cylinders	Number of cylinders - Bore X Rod diameter X Stroke	
	Boom	2 - Ø 105 mm (4.134 in) x Ø 70 mm (2.756 in) x 961 mm (37.835 in)
	Arm	1 - Ø 115 mm (4.528 in) x Ø 80 mm (3.150 in) x 1108 mm (43.622 in)
	Bucket	1 - Ø 85 mm (3.346 in) x Ø 55 mm (2.165 in) x 665 mm (26.181 in)
Cooling system		

INTRODUCTION

Fan		Ø 550 mm (21.654 in) with 8-blades
Radiator capacity		74.1 kW
	fin type	Corrugated fin (wavy type)
	fin space	1.75 mm (0.06890 in)
Long life coolant		Coolant 55% , Water 45%
Oil cooler capacity		44.8 kW
	fin type	Corrugated fin (wavy type)
	fin space	1.75 mm (0.06890 in)
Intercooler capacity		10.8 kW
	fin type	Corrugated fin (wavy type)
	fin space	2.0 mm (0.0787 in)
Fuel cooler capacity		1.1 kW
	fin type	Corrugated fin (wavy type)
	fin space	2.0 mm (0.0787 in)
Filters		
Suction filter		105 µm
Return filter		6 µm
Pilot line filter		8 µm

Hydraulic controls

Boom/Arm/Bucket/Swing	Pilot pressure control system (ISO control pattern)
Travel	Pilot pressure control system
Work mode select	SP - mode
	H - mode
	Auto - mode
Travel mode select	2-speed travel
Attachment cushion control	
Hydraulic lock (gate lock, left side tilt console)	

Electrical system

Engine control	
	Dial type throttle control
	One touch idle / Auto deceleration / Auto idle shutdown system
	Emergency stop
Monitor system	
	Message display (Caution, condition, etc.)
	Work mode display (SP, H, Auto)
	Machine condition (Power boost, etc.)
	Alarm display and buzzer
	Water temperature
	Hydraulic oil temperature
	Fuel level
	Diagnosis system
	Rear view camera image
	Urea water level
Wire harness	
	Waterproof type connector
Safety	
	Double horn
Battery	2 X 12 V 72 A·h/ 5HR
Lights	
Working light	Upper 24 V 70 W X 1
	Boom 24 V 70 W X 1

INTRODUCTION

	Cab	24 V 70 W X 2
Operator's cab room		24 V 70 W X 1

Operator environment

Operator's cab		
	Smooth and round shape design cab, fabricated by press work	
	Safety glass for all windows	
	Shock-less cab suspension by 4-point fluid mounting	
	Sliding front window with auto lock	
	Built-in type full-color LCD monitor display	
	Membrane switch on monitor display	
	Windshield wiper and washer	
	Floor mat	
	Polycarbonate roof hatch and Sun shade	
	Auto air-conditioner	
	Rain deflector	
	Sun visor	
	Roll-over protective structure (ROPS)	
	Top guard OPG level 1 (in CAB structure)	
Operator's seat		
	Low frequency air suspension with air springs and double acting hydraulic damper. (Achieves ISO7096 in category EM6)	
	With following features	
	Manual weight adjustment	Backrest angle adjustment
	Seat height adjustment	Adjustable pivoting armrests linked to consoles
	Adjustable headrest	Retractable seat belt
	Adjustable lumbar support	Control consoles adjust independently of seat
Others		
	Rear view mirror (Cab side & Right side)	
	Rear view Camera	

Undercarriage

Travel motor	Variable displacement axial piston motor	
Brake	Mechanical disc brake	
Hydraulic service brake	Brake valve	
Final drive	Planetary gear reduction	
Travel speeds	High	5.6 km/h (3.5 mph) (Automatic travel speed shifting)
	Low	3.4 km/h (2.1 mph)
Drawbar pull	116 kN (26077.837 lb)	
Number of carrier rollers (each side)	2	
Number of track rollers (each side)	7	
Number of shoes (each side)	46	
Type of shoe	Triple grouser shoe	
Link pitch	171.5 mm (6.752 in)	
Width of shoe	700 mm (27.559 in) (S.T.D)	
Grade-ability	70% (35°)	

Mass

Operating mass	15400 kg (33951 lb)
	with 5.30 m (17.39 ft) Arm, 0.28 m³ Bucket, 700 mm (27.559 in) grouser shoe, operator, lubricant, coolant and full fuel tank
Shipping mass	14900 kg (32849 lb)
	Operating mass - (operator mass [75 kg (165.35 lb)] + 90% of fuel mass [195 kg (429.901 lb)] + bucket mass [210 kg (462.971 lb)]
Counter weight mass	3400 kg (7496 lb)
Ground pressure	0.033 MPa (4.787 psi)
	with 5.30 m (17.39 ft) Arm, 0.28 m³ Bucket, 700 mm (27.559 in) grouser shoe

Digging force (with 0.28 m³ bucket) (ISO 6015)

	[5.30 m (17.39 ft)] Arm
Arm digging force	23 kN (5170.606 lb)
With auto power up	35 kN (7868.313 lb)

Dimensions

	[5.30 m (17.39 ft)] Arm
Overall length (without attachment)	4030 mm (158.661 in)
Overall length (with attachment)	10390 mm (409.055 in)
Overall height (to top of boom)	2660 mm (104.724 in)
Overall height (to top of Cab)	2800 mm (110.236 in)
Overall height (to top of handrail)	2810 mm (110.630 in)
Upper structure overall width	2530 mm (99.606 in)
Swing (rear end) radius	2170 mm (85.433 in)
Clearance height under upper structure	895 mm (35.236 in)
Minimum ground clearance	420 mm (16.535 in)
Wheel base (Center to center of wheels)	3040 mm (119.685 in)
Crawler overall length	3760 mm (148.031 in)
Track gauge	1990 mm (78.346 in)
Undercarriage overall width [with 700 mm (27.559 in) shoes]	2690 mm (105.906 in)
Crawler tracks height	780 mm (30.709 in)

Working ranges

	[5.30 m (17.39 ft)] Arm
Boom length	7400 mm (291.339 in)
Bucket radius	1050 mm (41.339 in)
Bucket wrist action	180°
Maximum reach at GRP	13010 mm (512.205 in)
Maximum reach	13100 mm (515.748 in)
Max. digging depth	10130 mm (398.819 in)
Max. digging height	12070 mm (475.197 in)
Max. dumping height	10080 mm (396.850 in)

General specification - Main equipment

CX130D Crawler excavators Standard w/Blade version (TIER 4 FINAL)
- EU market

WE

Lower component

Travel unit

Manufacturer	Nabtesco corporation
Motor type	Variable displacement piston motor
	Automatic 2-speed switchover with parking brake
Intake amount	44.9 – 76.6 cm³/rev (2.7 – 4.7 in³/rev)
Operating pressure	34.3 MPa (4975 psi)
Operating flow	130.0 l/min (34.3424 US gpm)
Brake torque	17.4 N·m (12.83 lb ft) or more (reduction gear included)
Relief valve set pressure	35.3 – 37.3 MPa (5120.3 – 5410.4 psi)
Automatic 2-speed switch over pressure	24.5 – 26.5 MPa (3553.7 – 3843.8 psi)
Reduction gear	
Reduction gear type	Planetary gear 2-stage reduction gear
Reduction ratio	53.306
Dry weight	147 kg (324.080 lb)

Take-up roller

Weight	65.2 kg (143.7414 lb)
--------	------------------------------

Upper roller

Weight	14.4 kg (31.747 lb)
--------	----------------------------

Lower roller

Weight	21.55 kg (47.510 lb)
--------	-----------------------------

Recoil spring

Item	Weight	Quantity
Yoke	16.9 kg (37.258 lb)	1
Sems B M16	0.8 kg (1.7637 lb)	6
Threaded rod	13.2 kg (29.101 lb)	1
Deep groove height N M39	0.6 kg (1.3228 lb)	1
SP pin 6x 63	-	1
Recoil spring	31 kg (68.343 lb)	1
Grease cylinder assembly	13.4 kg (29.542 lb)	1
Assembly (total)	75.9 kg (167.331 lb)	
Mounting length of spring	431 mm (16.969 in)	
Stroke	54 mm (2.126 in)	

Shoe

Item	Weight or Quantity
600 grouser, including seal (standard)	796.9 kg (1756.864 lb)
Link	1 pair
Shoe	43
Bolt	172
Nut	172
500 grouser, including seal, with pad hole	710.9 kg (1567.266 lb)
Link	1 pair
Shoe	43
Bolt	172
Nut	172
500 link chain, including seal	749.6 kg (1652.585 lb)
Link	1 pair
Shoe	43
Bolt	172
Nut	172
700 grouser, including seal	974.4 kg (2148.184 lb)
Link	1 pair
Shoe	43
Bolt	172
Nut	172

Upper component

Swing unit

Swing motor assembly	
Swing motor	
Manufacturer	TOSHIBA MACHINE CO.LTD
Motor type	Fixed displacement piston motor
	With parking brake
Absorption amount	65 cm³/rev (3.97 in³/rev)
Operating pressure	27.9 MPa (4047 psi)
Operating flow	130 l/min (34.3424 US gpm)
Mechanical brake torque	336.1 N·m (247.895 lb ft) min.
Brake off pressure	2.9 MPa (421 psi) max.
Relief valve set pressure	27.9 MPa (4047 psi) at 108 l/min (28.531 US gpm) 27.3 MPa (3960 psi) at 40 l/min (10.567 US gpm)
Swing reduction gear	
Reduction gear type	Planetary gear 2-stage reduction gear
Reduction ratio	17.03
Dry weight	99 kg (218.258 lb)
Turntable bearing	
Number of teeth	98
Weight	177.7 kg (391.7614 lb)
Counterweight	
Weight	1970 kg (4343.107 lb)

Engine-related**Engine**

Engine model name	Isuzu 4JJ1X diesel engine
Engine type	4-cycle, water-cooled, overhead camshaft, vertical in-line, direct injection type (electronics control type)
Number of cylinders - diameter - stroke	Ø 95.4 mm (3.756 in) - 104.9 mm (4.130 in)
Total displacement	2999 L (792.252 US gal)
Compression ratio	17.5
Rated output	80.6 – 85.8 kW (109.59 – 116.66 Hp) / 2200 RPM
Maximum torque	349 N·m (257.41 lb ft) / 1800 RPM
Engine dry weight	About 333 kg (734.139 lb)
Oil pan	All direction allowable inclination angle 0.61 rad
Cooling fan	Ø 550 mm (21.654 in) - suction type - 8 blades resin With bell mouth-type fan guide
Pulley ratio	0.95 (reduction)
Charging generator	24 V 50 A AC type
Starter motor	24 V 4.0 kW (5.4 Hp) reduction type
Coolant capacity	6.0 L (1.585 US gal)
Oil pan capacity	Max: 15 L (3.96 US gal) Min: 11 L (2.91 US gal) (excluding oil filter)
Direction of rotation	Right (viewed from fan side)

Air cleaner (double element)

Manufacturer	Nippon Donaldson, Ltd.
Element (outer) - Filtering area size	3.24 m² (5022.01 in²)
Element (inner) - Filtering area size	0.08 m² (124.00 in²)
Weight	2.7 kg (5.952 lb)

Radiator

Manufacturer	Tokyo Radiator MFG. Co.,Ltd.	
Oil cooler	Weight	17.5 kg (38.5809 lb)
	Oil volume	6.9 l (1.823 US gal)
Radiator	Weight	8.8 kg (19.4007 lb)
	Coolant capacity	6.3 l (1.664 US gal)
Air cooler	Weight	6.3 kg (13.8891 lb)
	Capacity	4.4 l (1.162 US gal)
Fuel cooler	Weight	0.7 kg (1.5432 lb)
	Capacity	0.2 l (0.053 US gal)
Total weight	73.2 kg (161.378 lb)	

SCR

Manufacturer	Tokyo Radiator MFG. Co.,Ltd.
Urea capacity	75.1 L (19.84 US gal)
Weight	9.2 kg (20.283 lb)

Hydraulic device

Hydraulic pump

Manufacturer		Kawasaki Heavy Industries, Ltd.	
Main pump			
Pump type		Double variable displacement piston pump	
Displacement capacity		65.2 cm³/rev (3.98 in³/rev) x 2	
Operating pressure	Rated	34.3 MPa (4975 psi)	
	Maximum	36.3 MPa (5265 psi)	
Input revolution speed		2000 RPM	
Maximum discharge flow		129 l/min (34.078 US gpm) x 2 (at 2000 RPM)	
Pilot pump			
Pump type		Gear pump	
Displacement capacity		10 cm³/rev (0.61 in³/rev)	
Operating pressure		3.92 MPa (569 psi)	
Maximum discharge flow		20 l (5.283 US gal) (at 2000 RPM)	
Control method		Hydraulic simultaneous constant output control	
		Electrical negative control by external command milli-amp (front and rear side)	
Accessory		Power take-off	
Dry weight		89 kg (196.211 lb)	

Control-related

Control valve

Manufacturer	Hyst Corporation Ltd.	
Maximum flow	130 l/min (34.342 US gpm) (at 2000 RPM)	53.6 l/min (53.600 US gpm) (at 2000 RPM)
Overload set pressure	32.3 MPa (4685 psi) boom down	23.0 – 24.0 MPa (3336.2 – 3481.2 psi) (at 2000 RPM), second option blade
	38.2 MPa (5541 psi) boom up, arm, bucket	
Main relief set pressure	34.3 MPa (4975 psi)	
	(Upon pressure boost)	36.3 MPa (5265.315 psi)
Foot relief set pressure	3.05 MPa (442.40 psi)	
Function	Pressure boost circuit	
	Straight travel circuit	
	Boom-up and arm-out/in 2 pumps internal flow	
	Boom-down and arm-in load holding circuit	
	Boom-down and bucket-close regenerative circuit	
	Arm-in forced regenerative circuit	
	Swing priority variable orifice (for arm operation) 2 pumps flow	
Weight	175.5 kg (386.911 lb)	

Solenoid valve (4 stack)

Manufacturer	Yuken Kogyo Co., Ltd.	
Valve specifications		
Maximum flow	P→B 20 l/min (5.283 US gpm) Other 5 l/min (1.321 US gpm)	
Rated pressure	4.5 MPa (652 psi)	
Port size	P.T.B port	G3/8
	C1, C2, C3 ports	G1/4
Solenoid specifications		
Operating voltage	DC 20 – 32 V	
Power consumption	17 W max.	
Weight	5.0 kg (11.0232 lb)	

Remote control valve for left/right operations

Manufacturer	Kawasaki Heavy Industries, Ltd.	
Operating pressure	3.92 MPa (569 psi)	
Secondary pressure	0.64 – 2.45 MPa (92.8320 – 355 psi) primary short type	
Operating angle	1,3 port	19°
	2,4 port	25°
Weight	1.9 kg (4.1888 lb)	

Valve for travel operation

Manufacturer	Kawasaki Heavy Industries, Ltd.	
Operating pressure	3.92 MPa (569 psi)	
Secondary pressure	0.64 – 2.45 MPa (92.8320 – 355 psi) primary short type	
Operating angle	12.4°	
Weight	4.1 kg (9.039 lb)	

Valve for blade operation

Manufacturer	Kawasaki Heavy Industries, Ltd.
Operating pressure	3.92 MPa (569 psi)
Secondary pressure	0.64 – 2.45 MPa (92.8320 – 355 psi) primary short type
Operating angle	10.0°
Weight	1.0 kg (2.205 lb)

Operation remote control valve control diagram

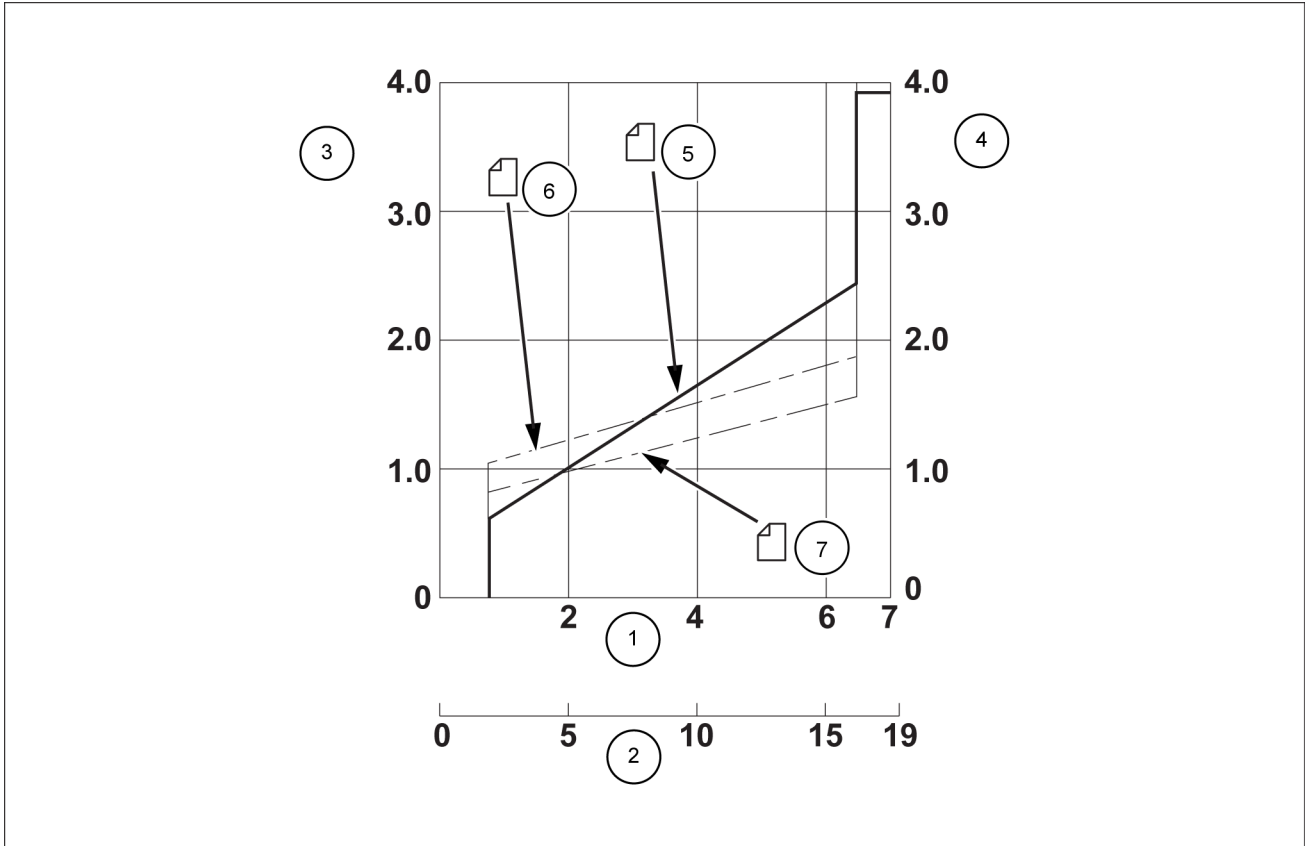

SMIL15CEX4380FB 1

Ports 1, 3

- | | |
|-----------------------------|---|
| 1 Push rod stroke [mm (in)] | 5 Secondary pressure |
| 2 Operating angle [deg.] | 6 Independent operating torque (Port 1) |
| 3 Secondary pressure [MPa] | 7 Independent operating torque (Port 3) |
| 4 Operating torque [Nm] | |

INTRODUCTION

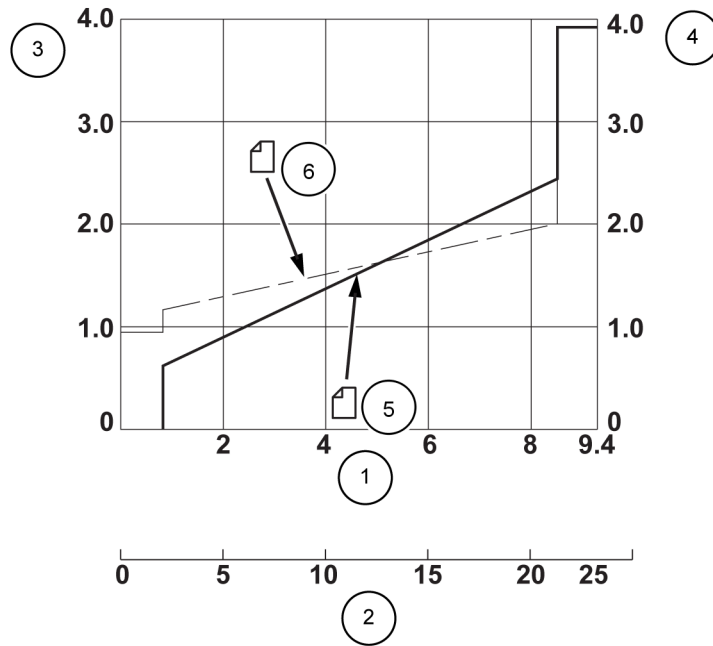

SMIL15CEX4381FB 2

Ports 2, 4

- | | |
|-----------------------------|--------------------------------|
| 1 Push rod stroke [mm (in)] | 4 Operating torque [Nm] |
| 2 Operating angle [deg.] | 5 Secondary pressure |
| 3 Secondary pressure [MPa] | 6 Independent operating torque |

Travel remote control valve control diagram

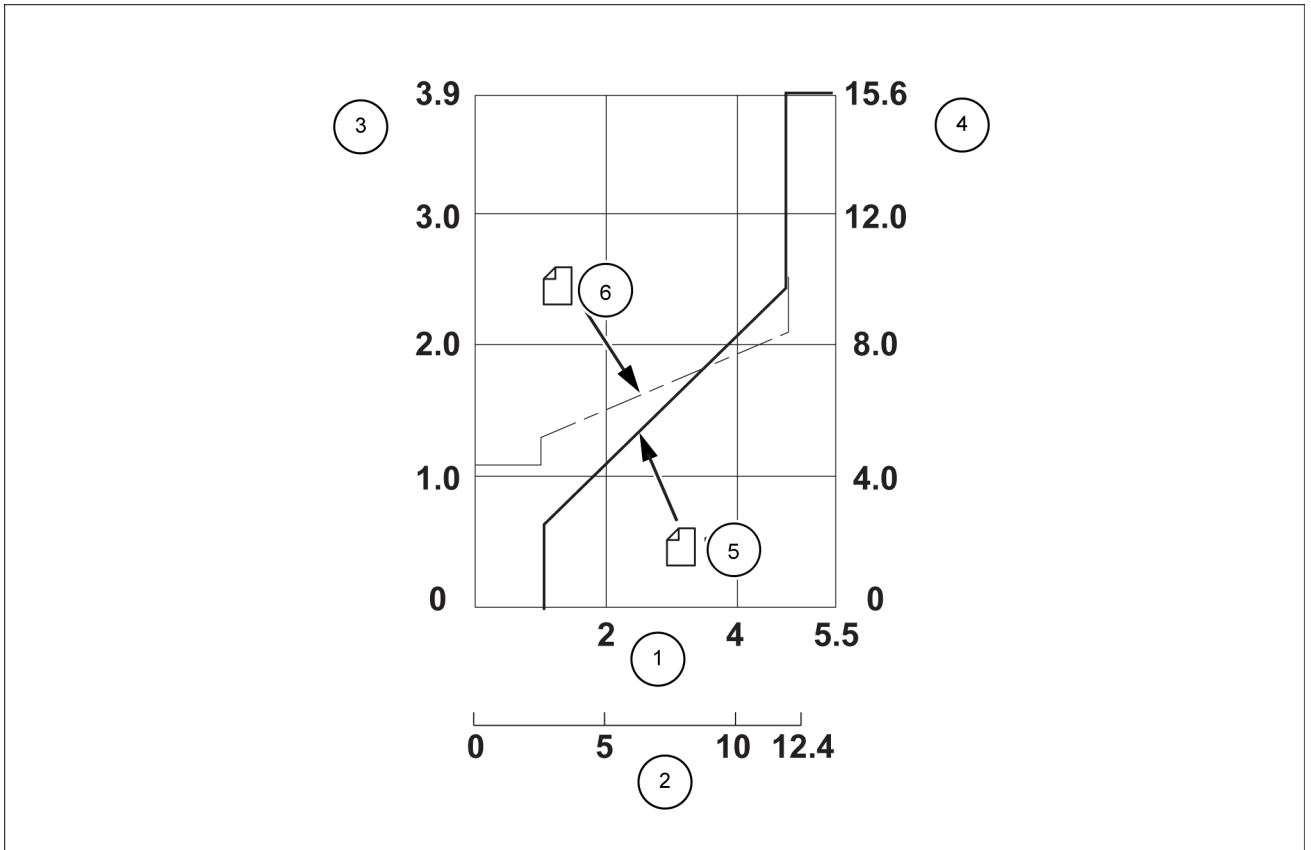

SMIL15CEX4382FB 3

- | | |
|--------------------------------|--------------------------------|
| 1 Push rod stroke [mm (in)] | 4 Operating torque [Nm] |
| 2 Pedal operating angle [deg.] | 5 Secondary pressure |
| 3 Secondary pressure [MPa] | 6 Independent operating torque |

Blade remote control valve control diagram

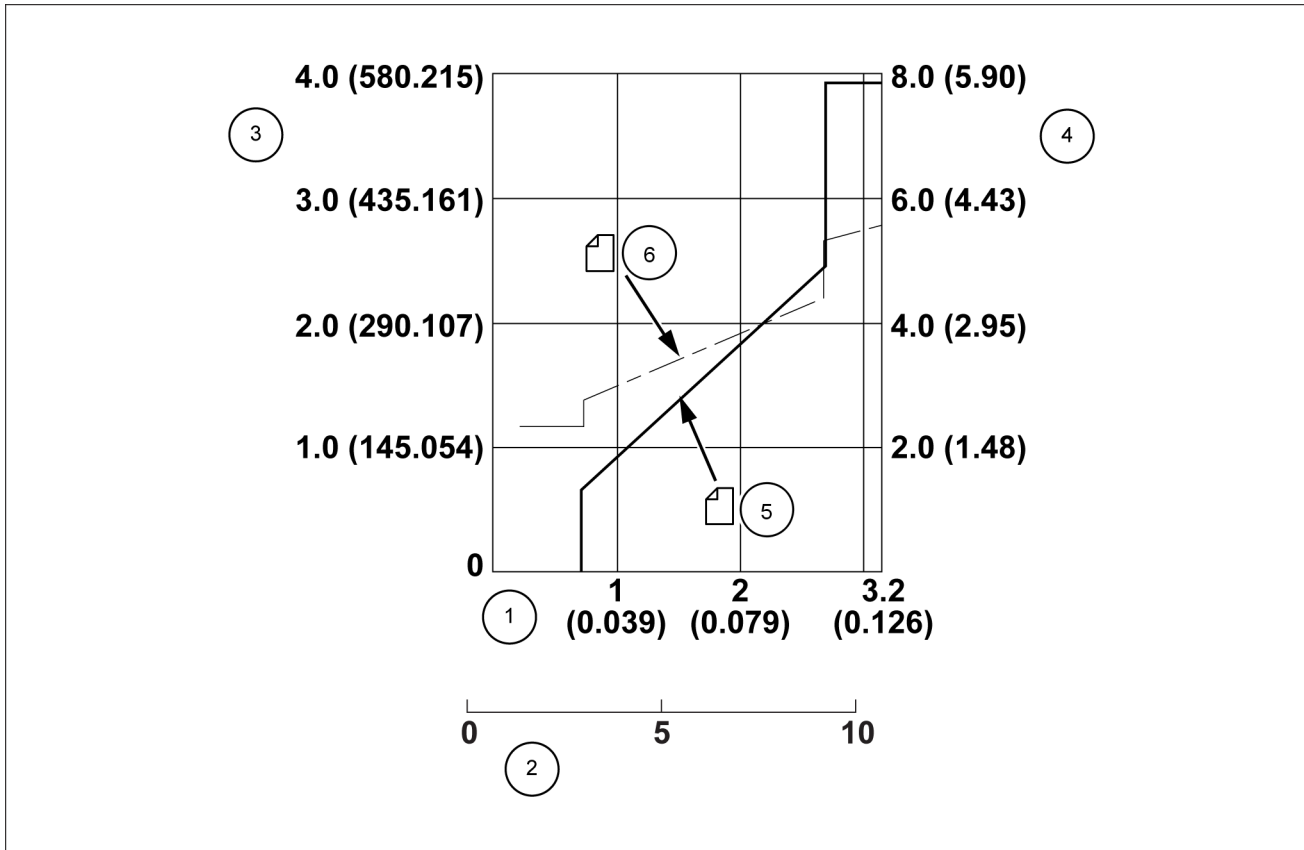

SMIL15CEX4383FB 4

- | | |
|----------------------------------|---------------------------------|
| 1 Push rod stroke [mm (in)] | 4 Operating torque [Nm (lb ft)] |
| 2 Pedal operating angle [deg.] | 5 Secondary pressure |
| 3 Secondary pressure [MPa (psi)] | 6 Operating torque |

Cushion valve (heat circuit, with shuttle valve)

Manufacturer	Yanagisawa Seiki MFG. Co., Ltd.
Port size	G3/8 (A - P ports)
	G1/4 (Q - V ports)
Weight	12.5 kg (27.5578 lb)

Selector valve (option)

2WAY	
Manufacturer	Nishina Industrial Co., Ltd.
Rated flow	25 l/min (6.604 US gpm)
Operating method	D (ISO), C (JD)
Port size	G3/8
Weight	4 kg (8.8185 lb)

Center joint

Operating pressure	High-pressure passage (ABCD)	34.3 MPa (4975 psi)
	High-pressure passage (EF)	20.6 MPa (2988.03 psi)
	Drain port (G)	0.5 MPa (72.52 psi)
	Pilot port (H)	3.9 MPa (566 psi)
Flow rate	High-pressure passage (ABCD)	210 L/min (55.476 US gpm)
	High-pressure passage (EF)	80.5 L/min (21.266 US gpm)
	Drain port (G)	10 L/min (2.642 US gpm)
	Pilot port (H)	19.8 L/min (5.231 US gpm)
Speed	15 RPM or less	
Rotational torque	At no load 115 – 247 N·m (84.820 – 182.178 lb ft)	
	29.4 MPa (4264.470 psi) applied to A and B or C and D ports. 160 – 274 N·m (118.01 – 202.09 lb ft)	
Hydraulic fluid used	ISO VG46	
Hydraulic fluid temperature range	-20.0 – 95.0 °C (-4.0 – 203.0 °F)	
Port A	Forward right	G3/4
Port B	Forward left	G3/4
Port C	Backward right	G3/4
Port D	Backward left	G3/4
Port E	Blade up	G1/2
Port F	Blade down	G1/2
Port G	Drain port	G1/2
Port H	Pilot port	G1/4
Weight	53.4 kg (117.727 lb)	

Relief valve (electromagnetic proportional)

Manufacturer	Kawasaki Heavy Industries, Ltd.	
Relief valve specifications		
Rated flow rate	A-T, C-T	300 L/min (79.252 US gpm)
	A-B	460 L/min (121.519 US gpm)
Pressure adjustable range	12 – 37 MPa (1740.60 – 5366.85 psi)	
Allowable back pressure	1.0 MPa (145.05 psi)	
Port size	A, B	G1
	C, T	G3/4
Inversely proportional relief valve electrical specifications		
Rated voltage	24 V DC	
Rated current	700 mA	
Coil resistance	19.5 Ω (20 °C (68 °F))	
Weight	12 kg	

Cylinder

Boom cylinder	
Manufacturer	KYB Corporation
Cylinder bore	Ø105 mm (4.134 in)
Rod diameter	Ø70 mm (2.756 in)
Maximum retracted length	1464 mm (57.638 in)
Stroke	961 mm (37.835 in)
Weight	108 kg (238.099 lb)

Arm cylinder	
Manufacturer	KYB Corporation
Cylinder bore	Ø115 mm (4.528 in)
Rod diameter	Ø80 mm (3.15 in)
Maximum retracted length	1619 mm (63.74 in)
Stroke	1108 mm (43.622 in)
Weight	156 kg (343.921 lb)

Bucket cylinder	
Manufacturer	KYB Corporation
Cylinder bore	Ø95 mm (3.74 in)
Rod diameter	Ø65 mm (2.559 in)
Maximum retracted length	1373 mm (54.055 in)
Stroke	881 mm (34.685 in)
Weight	91 kg (200.621 lb)

Blade cylinder	
Manufacturer	KYB Corporation
Cylinder bore	Ø 115 mm (4.528 in)
Rod diameter	Ø 70 mm (2.756 in)
Maximum retracted length	670 mm (26.378 in)
Stroke	250 mm (9.843 in)
Weight	53 kg (116.845 lb)

General specification - Main equipment

CX130D Crawler excavators LC version (TIER4 FINAL) - EU Market	WE
--	----

Lower component

Travel unit

Manufacturer	Nabtesco corporation
Motor type	Variable displacement piston motor
	Automatic 2-speed switchover with parking brake
Intake amount	44.9 – 76.6 cm³/rev (2.7 – 4.7 in³/rev)
Operating pressure	34.3 MPa (4975 psi)
Operating flow	130.0 l/min (34.3424 US gpm)
Brake torque	17.4 N·m (12.83 lb ft) or more (reduction gear included)
Relief valve set pressure	35.3 – 37.3 MPa (5120.3 – 5410.4 psi)
Automatic 2-speed switch over pressure	24.5 – 26.5 MPa (3553.7 – 3843.8 psi)
Reduction gear	
Reduction gear type	Planetary gear 2-stage reduction gear
Reduction ratio	53.306
Dry weight	147 kg (324.080 lb)

Take-up roller

Weight	65.2 kg (143.7414 lb)
--------	------------------------------

Upper roller

Weight	14.4 kg (31.747 lb)
--------	----------------------------

Lower roller

Weight	21.55 kg (47.510 lb)
--------	-----------------------------

Recoil spring

Item	Weight	Quantity
Yoke	16.9 kg (37.258 lb)	1
Sems B M16	0.8 kg (1.7637 lb)	6
Threaded rod	13.2 kg (29.101 lb)	1
Deep groove height N M39	0.6 kg (1.3228 lb)	1
SP pin 6x 63	-	1
Recoil spring	31 kg (68.343 lb)	1
Grease cylinder assembly	13.4 kg (29.542 lb)	1
Assembly (total)	75.9 kg (167.331 lb)	
Mounting length of spring	431 mm (16.969 in)	
Stroke	54 mm (2.126 in)	

INTRODUCTION

Shoe	
Item	Weight or Quantity
600 grouser, including seal (standard)	852.4 kg (1879.220 lb)
Link	1 pair
Shoe	46
Bolt	184
Nut	184
500 grouser, including seal, with pad hole	760.4 kg (1676.395 lb)
Link	1 pair
Shoe	46
Bolt	184
Nut	184
500 link chain, including seal	801.8 kg (1767.666 lb)
Link	1 pair
Shoe	46
Bolt	184
Nut	184
700 grouser, including seal	1008.8 kg (2224.023 lb)
Link	1 pair
Shoe	46
Bolt	184
Nut	184

Upper component

Swing unit

Swing motor assembly	
Swing motor	
Manufacturer	TOSHIBA MACHINE CO.LTD
Motor type	Fixed displacement piston motor
	With parking brake
Absorption amount	65 cm³/rev (3.97 in³/rev)
Operating pressure	27.9 MPa (4047 psi)
Operating flow	130 l/min (34.3424 US gpm)
Mechanical brake torque	336.1 N·m (247.895 lb ft) min.
Brake off pressure	2.9 MPa (421 psi) max.
Relief valve set pressure	27.9 MPa (4047 psi) at 108 l/min (28.531 US gpm) 27.3 MPa (3960 psi) at 40 l/min (10.567 US gpm)
Swing reduction gear	
Reduction gear type	Planetary gear 2-stage reduction gear
Reduction ratio	17.03
Dry weight	99 kg (218.258 lb)
Turntable bearing	
Number of teeth	98
Weight	177.7 kg (391.7614 lb)
Counterweight	
Weight	1970 kg (4343.107 lb)

Engine-related**Engine**

Engine model name	Isuzu 4JJ1X diesel engine
Engine type	4-cycle, water-cooled, overhead camshaft, vertical in-line, direct injection type (electronics control type)
Number of cylinders - diameter - stroke	∅ 95.4 mm (3.756 in) - 104.9 mm (4.130 in)
Total displacement	2999 L (792.252 US gal)
Compression ratio	17.5
Rated output	80.6 – 85.8 kW (109.59 – 116.66 Hp) / 2200 RPM
Maximum torque	349 N·m (257.41 lb ft) / 1800 RPM
Engine dry weight	About 333 kg (734.139 lb)
Oil pan	All direction allowable inclination angle 0.61 rad
Cooling fan	∅ 550 mm (21.654 in) - suction type - 8 blades resin With bell mouth-type fan guide
Pulley ratio	0.95 (reduction)
Charging generator	24 V 50 A AC type
Starter motor	24 V 4.0 kW (5.4 Hp) reduction type
Coolant capacity	6.0 L (1.585 US gal)
Oil pan capacity	Max: 15 L (3.96 US gal) Min: 11 L (2.91 US gal) (excluding oil filter)
Direction of rotation	Right (viewed from fan side)

Air cleaner (double element)

Manufacturer	Nippon Donaldson, Ltd.
Element (outer) - Filtering area size	3.24 m² (5022.01 in²)
Element (inner) - Filtering area size	0.08 m² (124.00 in²)
Weight	2.7 kg (5.952 lb)

Radiator

Manufacturer	Tokyo Radiator MFG. Co.,Ltd.	
Oil cooler	Weight	17.5 kg (38.5809 lb)
	Oil volume	6.9 l (1.823 US gal)
Radiator	Weight	8.8 kg (19.4007 lb)
	Coolant capacity	6.3 l (1.664 US gal)
Air cooler	Weight	6.3 kg (13.8891 lb)
	Capacity	4.4 l (1.162 US gal)
Fuel cooler	Weight	0.7 kg (1.5432 lb)
	Capacity	0.2 l (0.053 US gal)
Total weight	73.2 kg (161.378 lb)	

SCR

Manufacturer	Tokyo Radiator MFG. Co.,Ltd.
Urea capacity	75.1 L (19.84 US gal)
Weight	9.2 kg (20.283 lb)

Hydraulic device
Hydraulic pump

Manufacturer		Kawasaki Heavy Industries, Ltd.
Main pump		
Pump type		Double variable displacement piston pump
Displacement capacity		65.2 cm³/rev (3.98 in³/rev) x 2
Operating pressure	Rated	34.3 MPa (4975 psi)
	Maximum	36.3 MPa (5265 psi)
Input revolution speed		2000 RPM
Maximum discharge flow		129 l/min (34.078 US gpm) x 2 (at 2000 RPM)
Pilot pump		
Pump type		Gear pump
Displacement capacity		10 cm³/rev (0.61 in³/rev)
Operating pressure		3.92 MPa (569 psi)
Maximum discharge flow		20 l (5.283 US gal) (at 2000 RPM)
Control method		Hydraulic simultaneous constant output control
		Electrical negative control by external command milli-amp (front and rear side)
Dry weight		86 kg (189.598 lb)

Control-related

Control valve

Manufacturer	Hyst Corporation Ltd.	
Maximum flow	130 l/min (34.342 US gpm) (at 2000 RPM)	
Overload set pressure	32.3 MPa (4685 psi) boom down	
	38.2 MPa (5541 psi) boom up, arm, bucket	
Main relief set pressure	34.3 MPa (4975 psi)	
	(Upon pressure boost)	36.8 MPa (5338 psi)
Foot relief set pressure	3.05 MPa (442.40 psi)	
Function	Pressure boost circuit	
	Straight travel circuit	
	Boom-up and arm-out/in 2 pumps internal flow	
	Boom-down and arm-in load holding circuit	
	Boom-down and bucket-close regenerative circuit	
	Arm-in forced regenerative circuit	
	Swing priority variable orifice (for arm operation) 2 pumps flow	
Weight	160 kg (352.740 lb)	

Solenoid valve (4 stack)

Manufacturer	Yuken Kogyo Co., Ltd.	
Valve specifications		
	Maximum flow	P→B 20 l/min (5.283 US gpm) Other 5 l/min (1.321 US gpm)
	Rated pressure	4.5 MPa (652 psi)
	Port size	P.T.B port G3/8
		C1, C2, C3 ports G1/4
Solenoid specifications		
	Operating voltage	DC 20 – 32 V
	Power consumption	17 W max.
Weight	5.0 kg (11.0232 lb)	

Remote control valve for left/right operations

Manufacturer	Kawasaki Heavy Industries, Ltd.	
Operating pressure	3.92 MPa (569 psi)	
Secondary pressure	0.64 – 2.45 MPa (92.8320 – 355 psi) primary short type	
Operating angle	1,3 port	19°
	2,4 port	25°
Weight	1.9 kg (4.1888 lb)	

Valve for travel operation

Manufacturer	Kawasaki Heavy Industries, Ltd.	
Operating pressure	3.92 MPa (569 psi)	
Secondary pressure	0.64 – 2.45 MPa (92.8320 – 355 psi) primary short type	
Operating angle	12.4°	
Weight	4.1 kg (9.039 lb)	

Operation remote control valve control diagram

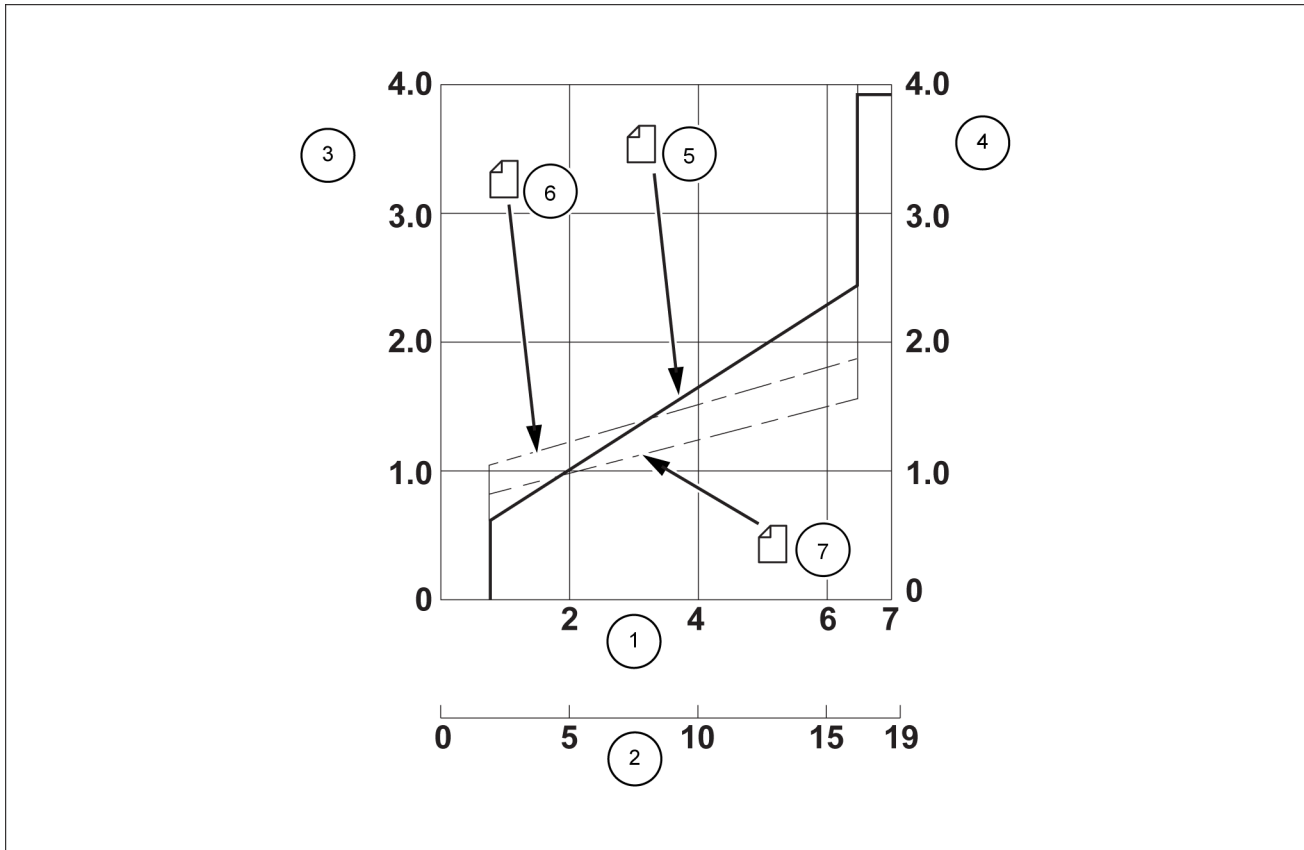

SMIL15CEX4380FB 1
Ports 1, 3

- | | |
|-----------------------------|---|
| 1 Push rod stroke [mm (in)] | 5 Secondary pressure |
| 2 Operating angle [deg.] | 6 Independent operating torque (Port 1) |
| 3 Secondary pressure [MPa] | 7 Independent operating torque (Port 3) |
| 4 Operating torque [Nm] | |

INTRODUCTION

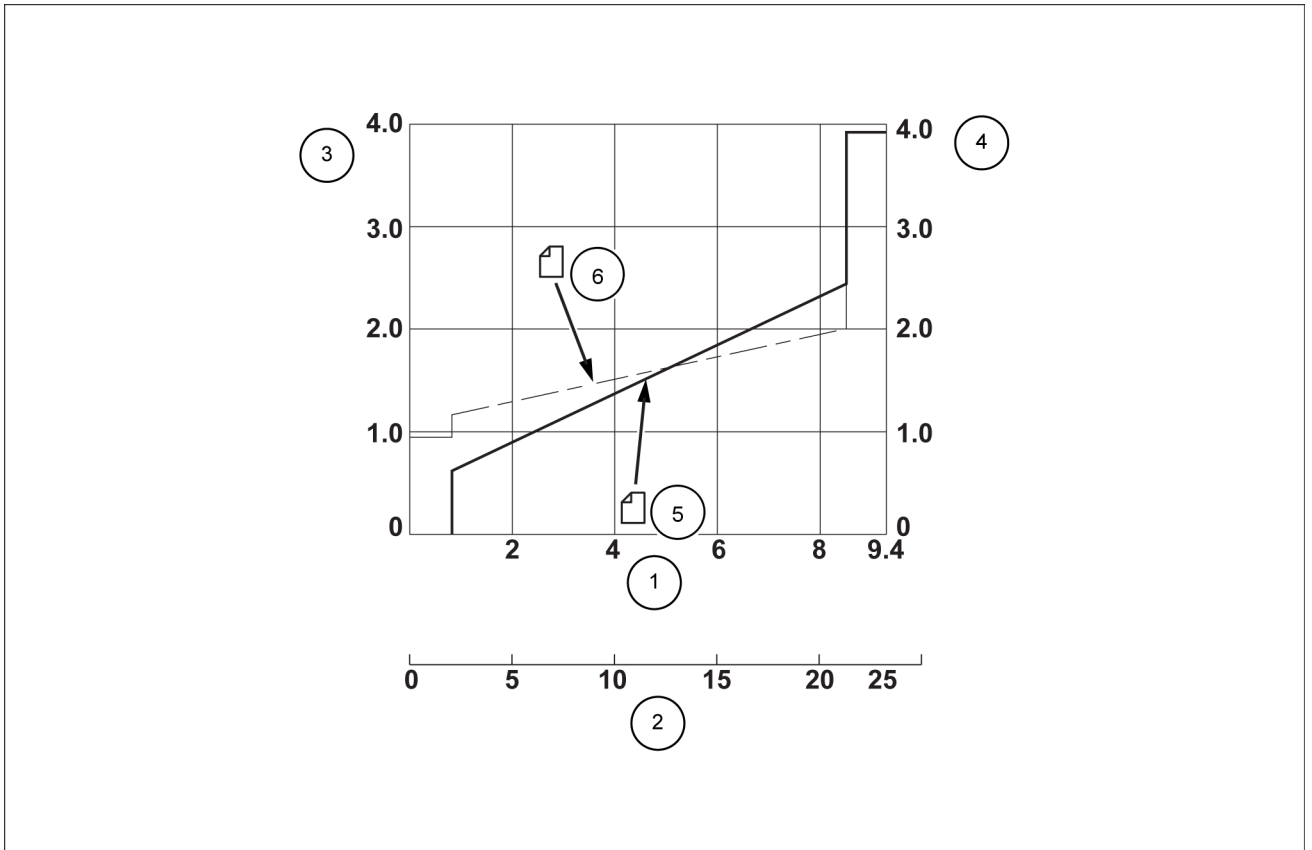

SMIL15CEX4381FB 2

Ports 2, 4

- | | | | |
|---|---------------------------|---|------------------------------|
| 1 | Push rod stroke [mm (in)] | 4 | Operating torque [Nm] |
| 2 | Operating angle [deg.] | 5 | Secondary pressure |
| 3 | Secondary pressure [MPa] | 6 | Independent operating torque |

Travel remote control valve control diagram

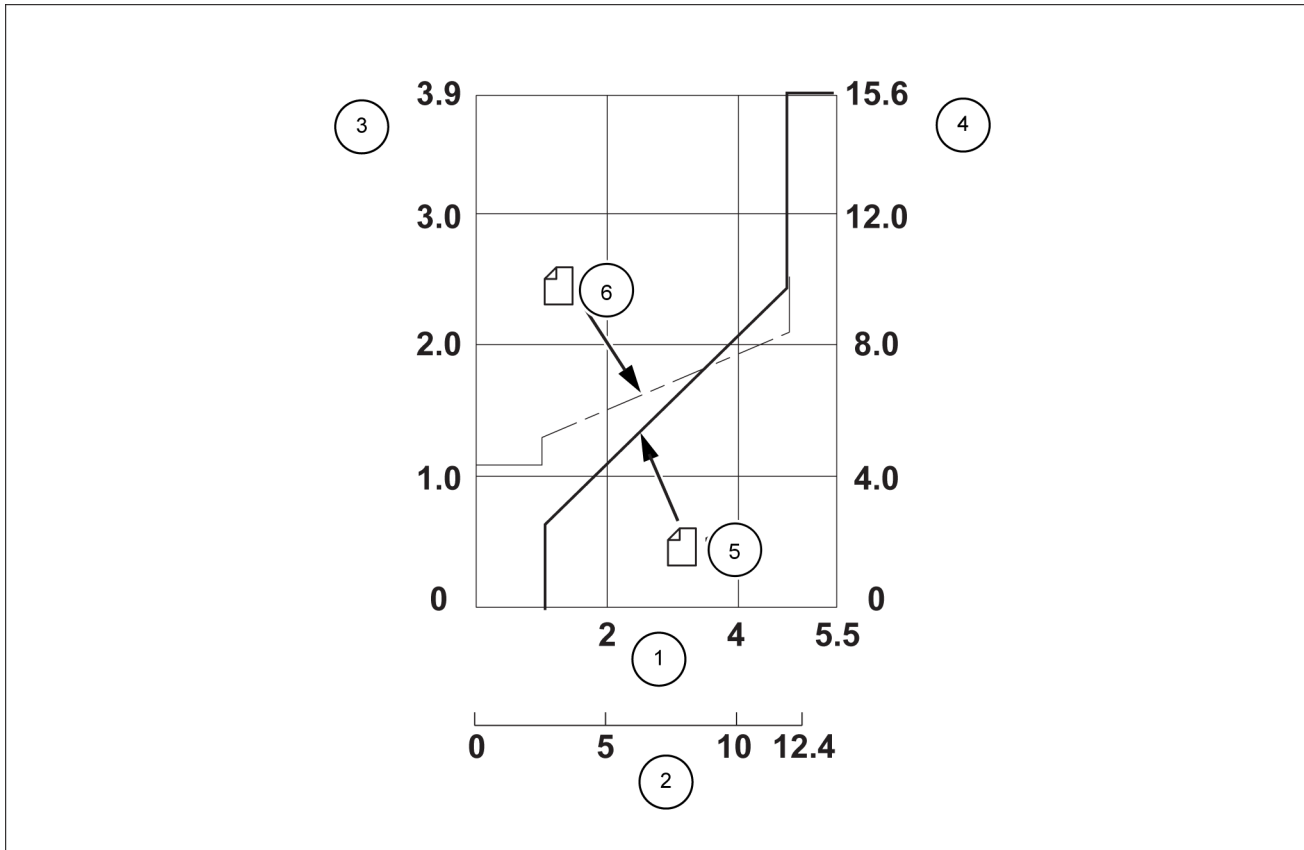

SMIL15CEX4382FB 3

- | | | | |
|---|------------------------------|---|------------------------------|
| 1 | Push rod stroke [mm (in)] | 4 | Operating torque [Nm] |
| 2 | Pedal operating angle [deg.] | 5 | Secondary pressure |
| 3 | Secondary pressure [MPa] | 6 | Independent operating torque |

Cushion valve (heat circuit, with shuttle valve)

Manufacturer	Yanagisawa Seiki MFG. Co., Ltd.
Port size	G3/8 (A - P ports)
	G1/4 (Q - V ports)
Weight	12.5 kg (27.5578 lb)

Selector valve (option)

2WAY	
Manufacturer	Nishina Industrial Co., Ltd.
Rated flow	25 l/min (6.604 US gpm)
Operating method	D (ISO), C (JD)
Port size	G3/8
Weight	4 kg (8.8185 lb)

Center joint

Operating pressure	High-pressure passage (ABCD)	34.3 MPa (4975 psi)
	Drain port (E)	0.5 MPa (73 psi)
	Pilot port (F)	3.9 MPa (566 psi)
Flow	High-pressure passage (ABCD)	234 l/min (61.816 US gpm)
	Drain port (E)	10 l/min (2.642 US gpm)
	Pilot port (F)	21 l/min (5.548 US gpm)
Speed	15 RPM or less	
Rotational torque	At no load 115 – 247 N·m (84.820 – 182.178 lb ft)	
	29.4 MPa (4264.470 psi) applied to A and B or C and D ports. 160 – 274 N·m (118.01 – 202.09 lb ft)	
Hydraulic fluid used	ISO VG46	
Hydraulic fluid temperature range	-20.0 – 95.0 °C (-4.0 – 203.0 °F)	
Port A	Forward right	G3/4
Port B	Forward left	G3/4
Port C	Backward right	G3/4
Port D	Backward left	G3/4
Port E	Drain port	G1/2
Port F	Pilot port	G1/4
Weight	31.4 kg (69.225 lb)	

Relief valve (electromagnetic proportional)

Manufacturer	Kawasaki Heavy Industries, Ltd.	
Relief valve specifications		
Rated flow rate	A-T, C-T	300 L/min (79.252 US gpm)
	A-B	460 L/min (121.519 US gpm)
Pressure adjustable range	12 – 37 MPa (1740.60 – 5366.85 psi)	
Allowable back pressure	1.0 MPa (145.05 psi)	
Port size	A, B	G1
	C, T	G3/4
Inversely proportional relief valve electrical specifications		
Rated voltage	24 V DC	
Rated current	700 mA	
Coil resistance	19.5 Ω (20 °C (68 °F))	
Weight	12 kg	

Cylinder

Boom cylinder	
Manufacturer	KYB Corporation
Cylinder bore	Ø105 mm (4.134 in)
Rod diameter	Ø70 mm (2.756 in)
Maximum retracted length	1464 mm (57.638 in)
Stroke	961 mm (37.835 in)
Weight	108 kg (238.099 lb)

Arm cylinder	
Manufacturer	KYB Corporation
Cylinder bore	Ø115 mm (4.528 in)
Rod diameter	Ø80 mm (3.15 in)
Maximum retracted length	1619 mm (63.74 in)
Stroke	1108 mm (43.622 in)
Weight	156 kg (343.921 lb)

Bucket cylinder	
Manufacturer	KYB Corporation
Cylinder bore	Ø95 mm (3.74 in)
Rod diameter	Ø65 mm (2.559 in)
Maximum retracted length	1373 mm (54.055 in)
Stroke	881 mm (34.685 in)
Weight	91 kg (200.621 lb)

General specification - Main equipment

CX130D Long Reach Crawler excavators LC Long Reach (Tier 4 FINAL) - EU Market	WE
--	----

Lower component

Travel unit

Manufacturer	Nabtesco corporation
Motor type	Variable displacement piston motor
	Automatic 2-speed switchover with parking brake
Intake amount	44.9 – 76.6 cm³/rev (2.7 – 4.7 in³/rev)
Operating pressure	34.3 MPa (4975 psi)
Operating flow	130.0 l/min (34.3424 US gpm)
Brake torque	17.4 N·m (12.83 lb ft) or more (reduction gear included)
Relief valve set pressure	35.3 – 37.3 MPa (5120.3 – 5410.4 psi)
Automatic 2-speed switch over pressure	24.5 – 26.5 MPa (3553.7 – 3843.8 psi)
Reduction gear	
Reduction gear type	Planetary gear 2-stage reduction gear
Reduction ratio	53.306
Dry weight	147 kg (324.080 lb)

Take-up roller

Weight	65.2 kg (143.7414 lb)
--------	------------------------------

Upper roller

Weight	14.4 kg (31.747 lb)
--------	----------------------------

Lower roller

Weight	21.55 kg (47.510 lb)
--------	-----------------------------

Recoil spring

Item	Weight	Quantity
Yoke	16.9 kg (37.258 lb)	1
Sems B M16	0.8 kg (1.7637 lb)	6
Threaded rod	13.2 kg (29.101 lb)	1
Deep groove height N M39	0.6 kg (1.3228 lb)	1
SP pin 6x 63	-	1
Recoil spring	31 kg (68.343 lb)	1
Grease cylinder assembly	13.4 kg (29.542 lb)	1
Assembly (total)	75.9 kg (167.331 lb)	
Mounting length of spring	431 mm (16.969 in)	
Stroke	54 mm (2.126 in)	

Shoe

Item	Weight or Quantity
600 grouser	852.4 kg (1879.220 lb)
Link	1 pair
Shoe	46
Bolt	184
Nut	184
700 grouser	1008.8 kg (2224.02 lb)
Link	1 pair
Shoe	46
Bolt	184
Nut	184

Upper component

Swing unit

Swing motor assembly	
Swing motor	
Manufacturer	Nabtesco Corporation
Motor type	Fixed displacement piston motor
	With parking brake
Absorption amount	65 cm³/rev (3.97 in³/rev)
Operating pressure	24 MPa (3481.20 psi)
Operating flow	130 l/min (34.3424 US gpm)
Mechanical brake torque	336.1 N·m (247.895 lb ft) or more
Brake off pressure	2.9 MPa (421 psi) or less
Relief valve set pressure	24 MPa (3481.20 psi) at 127 L/min (33.550 US gpm) 23.3 MPa (3379.665 psi) at 40 L/min (10.567 US gpm)
Swing reduction gear	
Reduction gear type	Planetary gear 2-stage reduction gear
Reduction ratio	17.03
Dry weight	99 kg (218.258 lb)
Turntable bearing	
Number of teeth	98
Weight	171.5 kg (378.0928 lb)
Counterweight	
Weight	3400 kg (7495.717 lb)

Engine-related**Engine**

Engine model name	Isuzu 4JJ1X diesel engine
Engine type	4-cycle, water-cooled, overhead camshaft, vertical in-line, direct injection type (electronics control type)
Number of cylinders - diameter - stroke	∅ 95.4 mm (3.756 in) - 104.9 mm (4.130 in)
Total displacement	2999 L (792.252 US gal)
Compression ratio	17.5
Rated output	80.6 – 85.8 kW (109.59 – 116.66 Hp) / 2200 RPM
Maximum torque	349 N·m (257.41 lb ft) / 1800 RPM
Engine dry weight	About 333 kg (734.139 lb)
Oil pan	All direction allowable inclination angle 0.61 rad
Cooling fan	∅ 550 mm (21.654 in) - suction type - 8 blades resin With bell mouth-type fan guide
Pulley ratio	0.95 (reduction)
Charging generator	24 V 50 A AC type
Starter motor	24 V 4.0 kW (5.4 Hp) reduction type
Coolant capacity	6.0 L (1.585 US gal)
Oil pan capacity	Max: 15 L (3.96 US gal) Min: 11 L (2.91 US gal) (excluding oil filter)
Direction of rotation	Right (viewed from fan side)

Air cleaner (double element)

Manufacturer	Nippon Donaldson, Ltd.
Element (outer) - Filtering area size	3.24 m² (5022.01 in²)
Element (inner) - Filtering area size	0.08 m² (124.00 in²)
Weight	2.7 kg (5.952 lb)

Radiator

Manufacturer	Tokyo Radiator MFG. Co.,Ltd.	
Oil cooler	Weight	17.5 kg (38.5809 lb)
	Oil volume	6.9 l (1.823 US gal)
Radiator	Weight	8.8 kg (19.4007 lb)
	Coolant capacity	6.3 l (1.664 US gal)
Air cooler	Weight	6.3 kg (13.8891 lb)
	Capacity	4.4 l (1.162 US gal)
Fuel cooler	Weight	0.7 kg (1.5432 lb)
	Capacity	0.2 l (0.053 US gal)
Total weight	73.2 kg (161.378 lb)	

SCR

Manufacturer	Tokyo Radiator MFG. Co.,Ltd.
Urea capacity	75.1 L (19.84 US gal)
Weight	9.2 kg (20.283 lb)

Hydraulic device

Hydraulic pump

Manufacturer		Kawasaki Heavy Industries, Ltd.
Main pump		
Pump type		Double variable displacement piston pump
Displacement capacity		65.2 cm³/rev (3.98 in³/rev) x 2
Operating pressure	Rated	34.3 MPa (4975 psi)
	Maximum	36.3 MPa (5265 psi)
Input revolution speed		2000 RPM
Maximum discharge flow		129 l/min (34.078 US gpm) x 2 (at 2000 RPM)
Pilot pump		
Pump type		Gear pump
Displacement capacity		10 cm³/rev (0.61 in³/rev)
Operating pressure		3.92 MPa (569 psi)
Maximum discharge flow		20 l (5.283 US gal) (at 2000 RPM)
Control method		Hydraulic simultaneous constant output control
		Electrical negative control by external command milli-amp (front and rear side)
Dry weight		86 kg (189.598 lb)

Control-related

Control valve

Manufacturer	Nabtesco Corporation	
Maximum flow	130 l/min (34.342 US gpm) (at 2000 RPM)	
Overload set pressure	38.2 MPa (5540.910 psi) boom up, arm out	
	32.3 MPa (4685.115 psi) boom down	
	22.6 MPa (3278.130 psi) arm in	
	20.6 MPa (2988.030 psi) bucket close	
	31.4 MPa (4554.570 psi) bucket open	
Main relief set pressure	34.3 MPa (4975.215 psi)	
	(Upon pressure boost)	36.3 MPa (5265.315 psi)
Foot relief set pressure	2.54 MPa (368.427 psi)	
Function	Pressure boost circuit	
	Straight travel circuit	
	Boom-up and arm-out/in 2 pumps internal flow	
	Boom-down and arm-in load holding circuit	
	Boom-down regenerative circuit	
	Bucket-close regenerative circuit	
	Arm-in Forced Regenerative Circuit	
	Swing priority variable orifice	
	2 pumps flow	
Weight	160 kg (352.740 lb)	

Solenoid valve (4 stack)

Manufacturer	Yuken Kogyo Co., Ltd.	
Valve specifications		
Maximum flow	P→B 20 l/min (5.283 US gpm) Other 5 l/min (1.321 US gpm)	
Rated pressure	4.5 MPa (652 psi)	
Port size	P.T.B port	G3/8
	C1, C2, C3 ports	G1/4
Solenoid specifications		
Operating voltage	DC 20 – 32 V	
Power consumption	17 W max.	
Weight	5.0 kg (11.0232 lb)	

Remote control valve for left/right operations

Manufacturer	Kawasaki Heavy Industries, Ltd.	
Operating pressure	3.92 MPa (569 psi)	
Secondary pressure	0.64 – 2.45 MPa (92.8320 – 355 psi) primary short type	
Operating angle	1,3 port	19°
	2,4 port	25°
Weight	1.9 kg (4.1888 lb)	

Valve for travel operation

Manufacturer	Kawasaki Heavy Industries, Ltd.	
Operating pressure	3.92 MPa (569 psi)	
Secondary pressure	0.64 – 2.45 MPa (92.8320 – 355 psi) primary short type	
Operating angle	12.4°	
Weight	4.1 kg (9.039 lb)	

Operation remote control valve control diagram

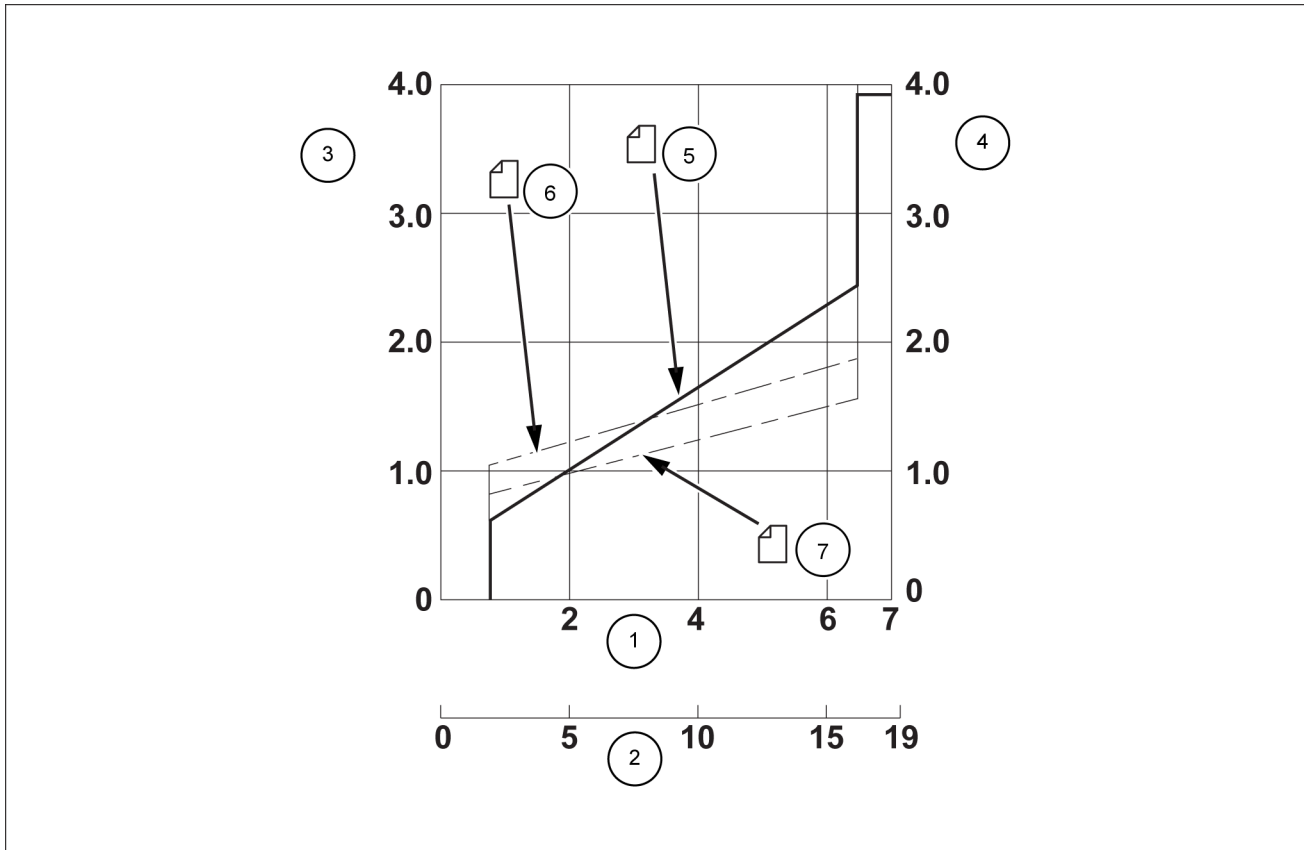

SMIL15CEX4380FB 1
Ports 1, 3

- | | |
|-----------------------------|---|
| 1 Push rod stroke [mm (in)] | 5 Secondary pressure |
| 2 Operating angle [deg.] | 6 Independent operating torque (Port 1) |
| 3 Secondary pressure [MPa] | 7 Independent operating torque (Port 3) |
| 4 Operating torque [Nm] | |

INTRODUCTION

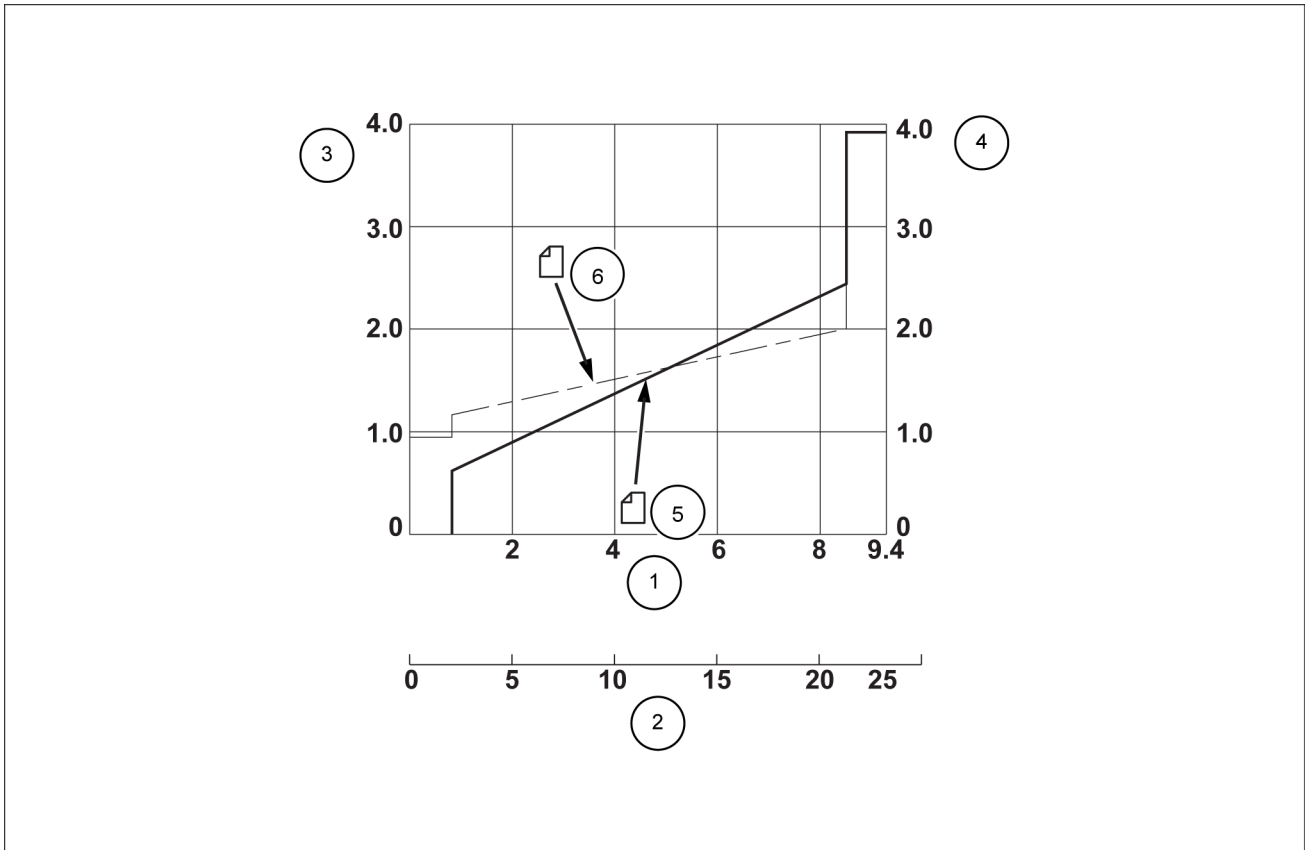

SMIL15CEX4381FB 2

Ports 2, 4

- | | |
|-----------------------------|--------------------------------|
| 1 Push rod stroke [mm (in)] | 4 Operating torque [Nm] |
| 2 Operating angle [deg.] | 5 Secondary pressure |
| 3 Secondary pressure [MPa] | 6 Independent operating torque |

Travel remote control valve control diagram

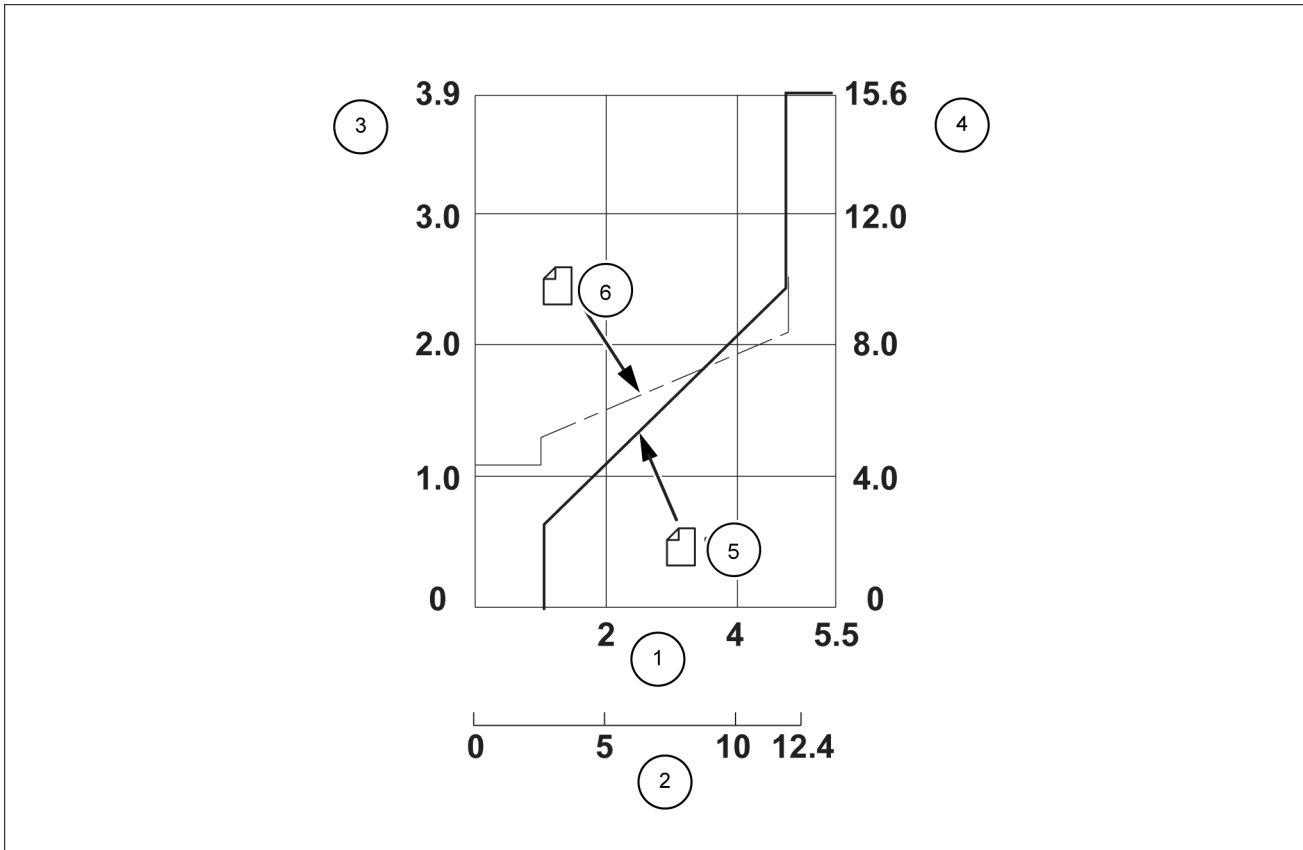

SMIL15CEX4382FB 3

- | | |
|--------------------------------|--------------------------------|
| 1 Push rod stroke [mm (in)] | 4 Operating torque [Nm] |
| 2 Pedal operating angle [deg.] | 5 Secondary pressure |
| 3 Secondary pressure [MPa] | 6 Independent operating torque |

Cushion valve (heat circuit, with shuttle valve)

Manufacturer	Yanagisawa Seiki MFG. Co., Ltd.
Port size	G3/8 (A - P ports)
	G1/4 (Q - V ports)
Weight	12.5 kg (27.5578 lb)

Selector valve (option)

2WAY	
Manufacturer	Nishina Industrial Co., Ltd.
Rated flow	25 l/min (6.604 US gpm)
Operating method	D (ISO), C (JD)
Port size	G3/8
Weight	4 kg (8.8185 lb)

Center joint

Operating pressure	High-pressure passage (ABCD)	34.3 MPa (4975 psi)
	Drain port (E)	0.5 MPa (73 psi)
	Pilot port (F)	3.9 MPa (566 psi)
Flow	High-pressure passage (ABCD)	234 l/min (61.816 US gpm)
	Drain port (E)	10 l/min (2.642 US gpm)
	Pilot port (F)	21 l/min (5.548 US gpm)
Speed	15 RPM or less	
Rotational torque	At no load 115 – 247 N·m (84.820 – 182.178 lb ft)	
	29.4 MPa (4264.470 psi) applied to A and B or C and D ports. 160 – 274 N·m (118.01 – 202.09 lb ft)	
Hydraulic fluid used	ISO VG46	
Hydraulic fluid temperature range	-20.0 – 95.0 °C (-4.0 – 203.0 °F)	
Port A	Forward right	G3/4
Port B	Forward left	G3/4
Port C	Backward right	G3/4
Port D	Backward left	G3/4
Port E	Drain port	G1/2
Port F	Pilot port	G1/4
Weight	31.4 kg (69.225 lb)	

Relief valve (electromagnetic proportional)

Manufacturer	Kawasaki Heavy Industries, Ltd.	
Relief valve specifications		
Rated flow rate	A-T, C-T	300 L/min (79.252 US gpm)
	A-B	460 L/min (121.519 US gpm)
Pressure adjustable range	12 – 37 MPa (1740.60 – 5366.85 psi)	
Allowable back pressure	1.0 MPa (145.05 psi)	
Port size	A, B	G1
	C, T	G3/4
Inversely proportional relief valve electrical specifications		
Rated voltage	24 V DC	
Rated current	700 mA	
Coil resistance	19.5 Ω (20 °C (68 °F))	
Weight	12 kg	

Cylinder

Boom cylinder	
Manufacturer	KYB Corporation
Cylinder bore	Ø 105 mm (4.134 in)
Rod diameter	Ø 70 mm (2.756 in)
Maximum retracted length	1464 mm (57.638 in)
Stroke	961 mm (37.835 in)
Weight	108 kg (238.099 lb)

Arm cylinder	
Manufacturer	KYB Corporation
Cylinder bore	Ø 115 mm (4.528 in)
Rod diameter	Ø 80 mm (3.15 in)
Maximum retracted length	1619 mm (63.74 in)
Stroke	1108 mm (43.622 in)
Weight	156 kg (343.921 lb)

Bucket cylinder	
Manufacturer	KYB Corporation
Cylinder bore	Ø 85 mm (3.346 in)
Rod diameter	Ø 55 mm (2.165 in)
Maximum retracted length	1035 mm (40.748 in)
Stroke	665 mm (26.181 in)
Weight	56 kg (123.459 lb)

Weight

CX130D Crawler excavators Standard w/Blade version (TIER 4 FINAL) - EU market	WE
--	----

Divided weight

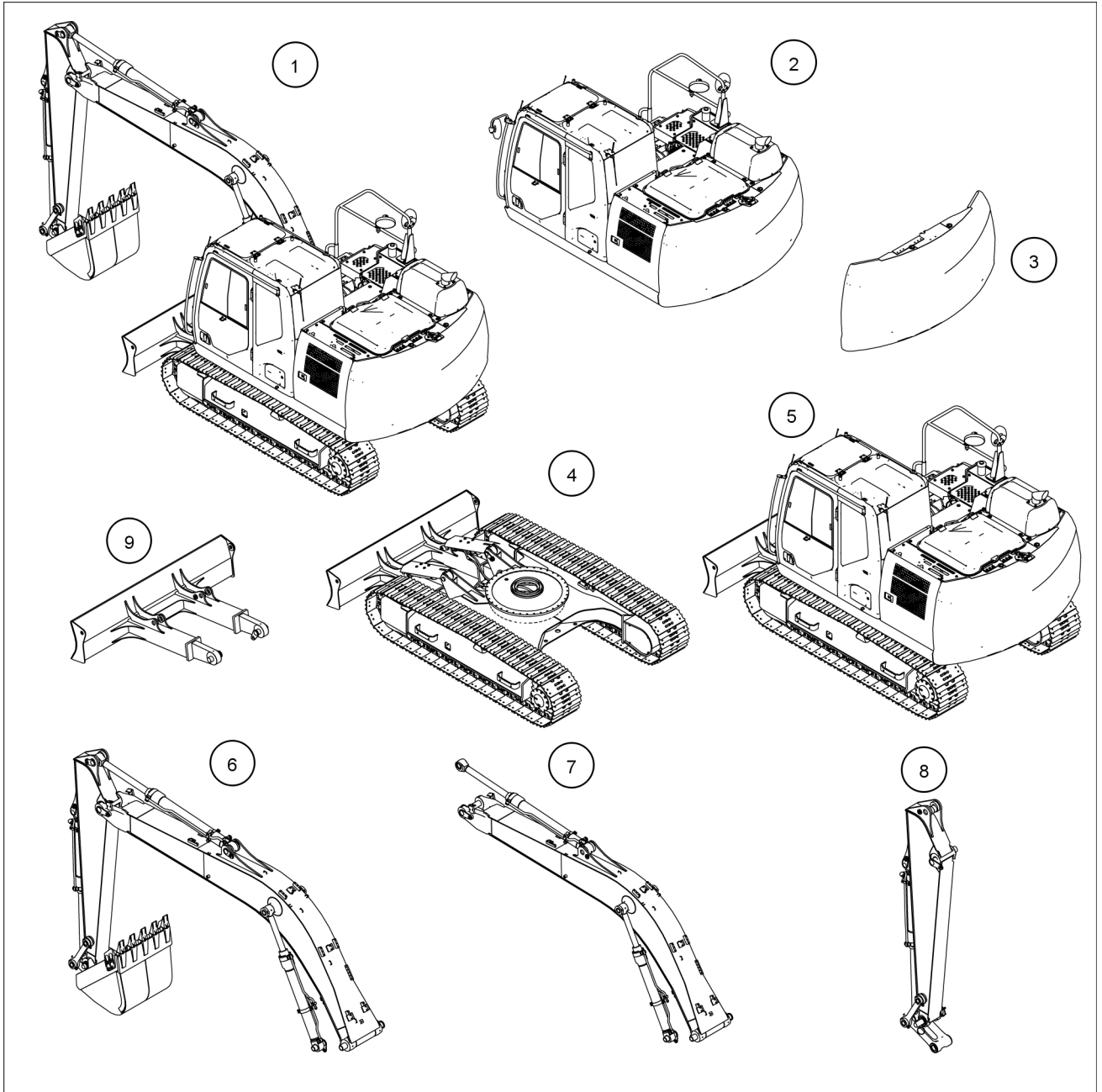

SML15CEX4384GB 1

Code	Part name	Weight
1	Operating weight	13601.1 kg (29985.293 lb)
2	Upper component (including counterweight and turntable bearing)	6661.9 kg (14687.020 lb)
3	Counterweight	1988.3 kg (4383.451 lb)
4	Lower component (with grouser shoe)	5011.1 kg (11047.584 lb)
5	Main unit weight	11673.0 kg (25734.560 lb)
6	Attachments (including piping)	1851.0 kg (4080.756 lb)
7	Boom (including cylinder and piping)	1258.1 kg (2773.636 lb)
8	Arm (including cylinder, linkage and piping)	593.0 kg (1307.341 lb)

INTRODUCTION

Code	Part name	Weight
9	Blade (including cylinder)	713.3 kg (1572.557 lb)

NOTE: The weights shown here are approximate values.

Stand alone part weight

	Part name	Weight
1	Travel unit (travel motor)	147 kg (324.080 lb)
2	Take-up roller	65 kg (143.300 lb)
3	Upper roller	14 kg (30.865 lb)
4	Lower roller	22 kg (48.502 lb)
5	Swing unit	99 kg (218.258 lb)
6	Turntable bearing	176 kg (388.014 lb)
7	Engine	406 kg (895.077 lb)
8	Radiator	73 kg (160.937 lb)
9	Hydraulic pump	89 kg (196.211 lb)
10	Fuel tank	132 kg (291.010 lb)
11	Hydraulic oil tank	126 kg (277.782 lb)
12	Urea solution tank	9.2 kg (20.283 lb)
13	Control valve	176 kg (388.014 lb)
14	Center joint	53 kg (116.845 lb)
15	Boom	713 kg (1571.896 lb)
16	Blade	562 kg (1238.998 lb)

Shoe weight (per side)

	Part name	Weight
1	500 mm (19.685 in) grouser shoe (M seal, with hole)	711 kg (1567.487 lb)
2	600 mm (23.62 in) grouser shoe (M seal, without hole)	797 kg (1757.084 lb)
3	700 mm (27.56 in) grouser shoe (M seal, without hole)	947 kg (2087.778 lb)
4	500 mm (19.685 in) link chain shoe (M seal)	750 kg (1653.467 lb)

Arm weight

	Part name	Weight
1	Standard arm (EM3 01)	343.6 kg (757.508 lb)
2	Standard arm (EM3 012)	348.3 kg (767.870 lb)
3	Standard arm (EM3 HD 01)	427.2 kg (941.815 lb)
4	Standard arm (EM3 HD 012)	431.9 kg (952.177 lb)
5	Long arm (EM3 01)	441.7 kg (973.782 lb)
6	Long arm (EM3 012)	446.4 kg (984.144 lb)
7	Long arm (EM3 01 PL)	481.1 kg (1060.644 lb)
8	Long arm (EM3 012 PL)	485.8 kg (1071.006 lb)
9	Short arm (EM3 HD 01)	366.8 kg (808.656 lb)
10	Short arm (EM3 HD 012)	370.9 kg (817.695 lb)

Bucket weight

General Purpose buckets		
Capacity ISO 7451 (Heaped)	Width	Mass
0.21 m ³ (0.27 yd ³)	450 mm (18 in)	249 kg (549 lb)
0.31 m ³ (0.41 yd ³)	600 mm (24 in)	283 kg (624 lb)
0.41 m ³ (0.54 yd ³)	750 mm (30 in)	326 kg (719 lb)
0.52 m ³ (0.68 yd ³)	900 mm (35 in)	359 kg (791 lb)
0.58 m ³ (0.76 yd ³)	1000 mm (39 in)	393 kg (866 lb)
0.66 m ³ (0.86 yd ³)	1100 mm (43 in)	425 kg (937 lb)
0.73 m ³ (0.95 yd ³)	1200 mm (47 in)	449 kg (990 lb)

Heavy Duty buckets		
Capacity ISO 7451 (Heaped)	Width	Mass
0.21 m ³ (0.27 yd ³)	450 mm (18 in)	279 kg (615 lb)
0.31 m ³ (0.41 yd ³)	600 mm (24 in)	313 kg (690 lb)
0.41 m ³ (0.54 yd ³)	750 mm (30 in)	351 kg (774 lb)
0.52 m ³ (0.68 yd ³)	900 mm (35 in)	399 kg (880 lb)
0.58 m ³ (0.76 yd ³)	1000 mm (39 in)	432 kg (952 lb)
0.66 m ³ (0.86 yd ³)	1100 mm (43 in)	467 kg (1030 lb)
0.73 m ³ (0.95 yd ³)	1200 mm (47 in)	492 kg (1085 lb)

Ditch cleaning buckets		
Capacity ISO 7451 (Heaped)	Width	Mass
0.54 m ³ (0.71 yd ³)	1830 mm (72 in)	345 kg (761 lb) (*)
0.54 m ³ (0.71 yd ³)	1830 mm (72 in)	475 kg (1047 lb)

NOTE: Refer to the Operator's Manual for direct fit buckets application as function of the arm.

Weight

CX130D Crawler excavators LC version (TIER4 FINAL) - EU Market

WE

Divided weight

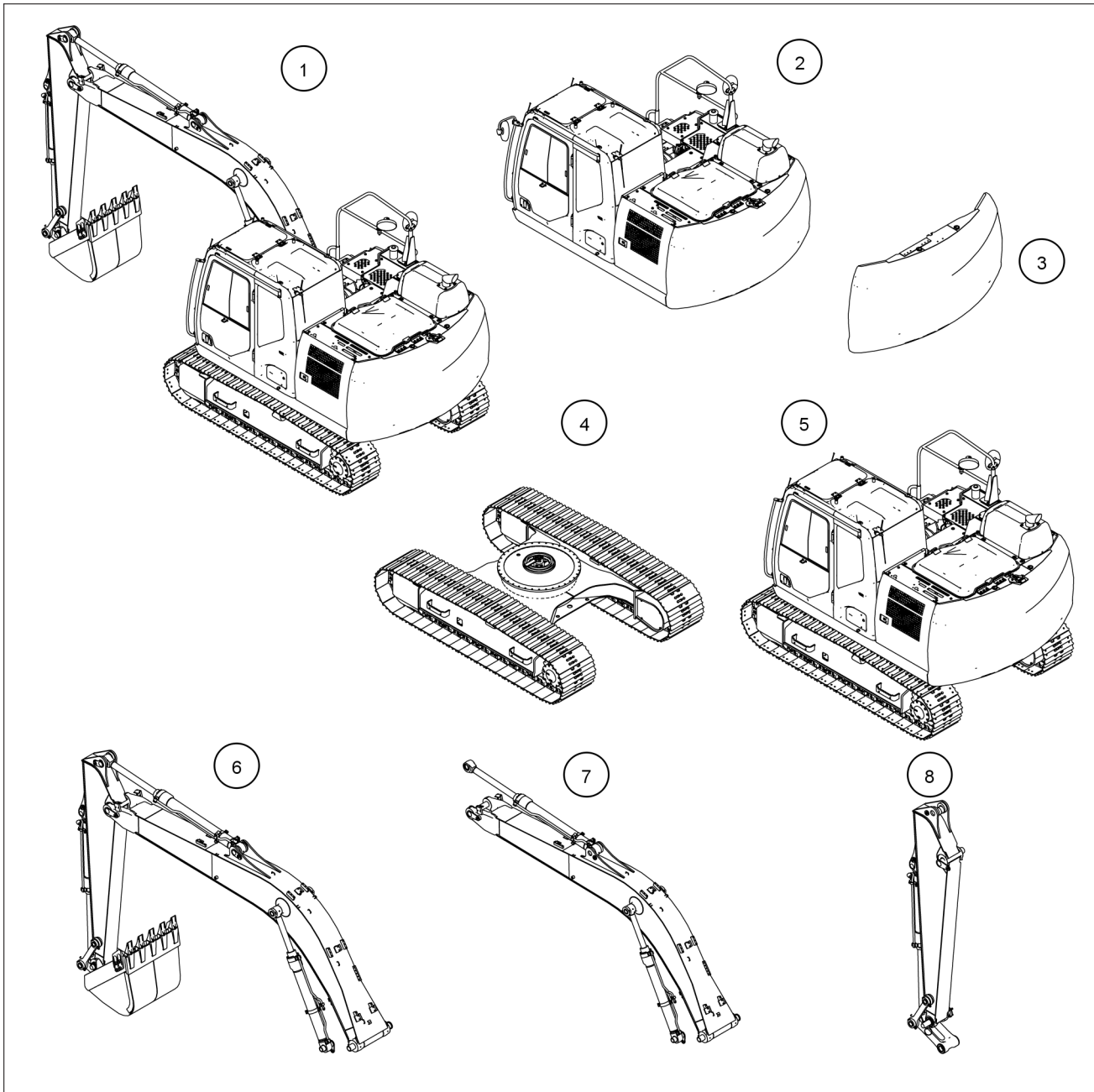

SMIL15CEX4385GB 1

Code	Part name	Weight
1	Operating weight	12967.1 kg (28587.562 lb)
2	Upper component (including counterweight and turntable bearing)	6624.6 kg (14604.787 lb)
3	Counterweight	1988.3 kg (4383.451 lb)
4	Lower component (with grouser shoe)	4415.4 kg (9734.247 lb)
5	Main unit weight	11040.0 kg (24339.034 lb)
6	Attachments (including piping)	1851.1 kg (4080.977 lb)
7	Boom (including cylinder and piping)	1258.1 kg (2773.636 lb)
8	Arm (including cylinder, linkage and piping)	593.0 kg (1307.341 lb)

NOTE: The weights shown here are approximate values.

Stand alone part weight

	Part name	Weight
1	Travel unit (travel motor)	147 kg (324.080 lb)
2	Take-up roller	65 kg (143.300 lb)
3	Upper roller	14 kg (30.865 lb)
4	Lower roller	22 kg (48.502 lb)
5	Swing unit	99 kg (218.258 lb)
6	Turntable bearing	176 kg (388.014 lb)
7	Engine	406 kg (895.077 lb)
8	Radiator	73 kg (160.937 lb)
9	Hydraulic pump	86 kg (189.598 lb)
10	Fuel tank	132 kg (291.010 lb)
11	Hydraulic oil tank	126 kg (277.782 lb)
12	Urea solution tank	9.2 kg (20.283 lb)
13	Control valve	160 kg (352.740 lb)
14	Center joint	29 kg (63.934 lb)
15	Boom	713 kg (1571.896 lb)

Shoe weight (per side)

	Part name	Weight
1	500 mm (19.685 in) grouser shoe (M seal)	760 kg (1675.513 lb)
2	600 mm (23.62 in) grouser shoe (M seal, without hole)	852 kg (1878.338 lb)
3	700 mm (27.56 in) grouser shoe (M seal)	1009 kg (2224.464 lb)
4	500 mm (19.685 in) link chain shoe (M seal)	802 kg (1768.107 lb)

Arm weight

	Part name	Weight
1	Standard arm (EM3 01)	343.6 kg (757.508 lb)
2	Standard arm (EM3 012)	348.3 kg (767.870 lb)
3	Standard arm (EM3 HD 01)	427.2 kg (941.815 lb)
4	Standard arm (EM3 HD 012)	431.9 kg (952.177 lb)
5	Long arm (EM3 01)	441.7 kg (973.782 lb)
6	Long arm (EM3 012)	446.4 kg (984.144 lb)
7	Long arm (EM3 01 PL)	481.1 kg (1060.644 lb)
8	Long arm (EM3 012 PL)	485.8 kg (1071.006 lb)
9	Short arm (EM3 HD 01)	366.8 kg (808.656 lb)
10	Short arm (EM3 HD 012)	370.9 kg (817.695 lb)

Bucket weight

General Purpose buckets		
Capacity ISO 7451 (Heaped)	Width	Mass
0.21 m³ (0.27 yd³)	450 mm (18 in)	249 kg (549 lb)
0.31 m³ (0.41 yd³)	600 mm (24 in)	283 kg (624 lb)
0.41 m³ (0.54 yd³)	750 mm (30 in)	326 kg (719 lb)
0.52 m³ (0.68 yd³)	900 mm (35 in)	359 kg (791 lb)
0.58 m³ (0.76 yd³)	1000 mm (39 in)	393 kg (866 lb)
0.66 m³ (0.86 yd³)	1100 mm (43 in)	425 kg (937 lb)
0.73 m³ (0.95 yd³)	1200 mm (47 in)	449 kg (990 lb)

Heavy Duty buckets		
Capacity ISO 7451 (Heaped)	Width	Mass
0.21 m³ (0.27 yd³)	450 mm (18 in)	279 kg (615 lb)
0.31 m³ (0.41 yd³)	600 mm (24 in)	313 kg (690 lb)
0.41 m³ (0.54 yd³)	750 mm (30 in)	351 kg (774 lb)
0.52 m³ (0.68 yd³)	900 mm (35 in)	399 kg (880 lb)
0.58 m³ (0.76 yd³)	1000 mm (39 in)	432 kg (952 lb)
0.66 m³ (0.86 yd³)	1100 mm (43 in)	467 kg (1030 lb)
0.73 m³ (0.95 yd³)	1200 mm (47 in)	492 kg (1085 lb)

Ditch cleaning buckets		
Capacity ISO 7451 (Heaped)	Width	Mass
0.54 m³ (0.71 yd³)	1830 mm (72 in)	345 kg (761 lb) (*)
0.54 m³ (0.71 yd³)	1830 mm (72 in)	475 kg (1047 lb)

NOTE: Refer to the Operator's Manual for direct fit buckets application as function of the arm.

Weight

CX130D Long Reach Crawler excavators LC Long Reach (Tier 4 FINAL) | WE
 - EU Market

Divided weight

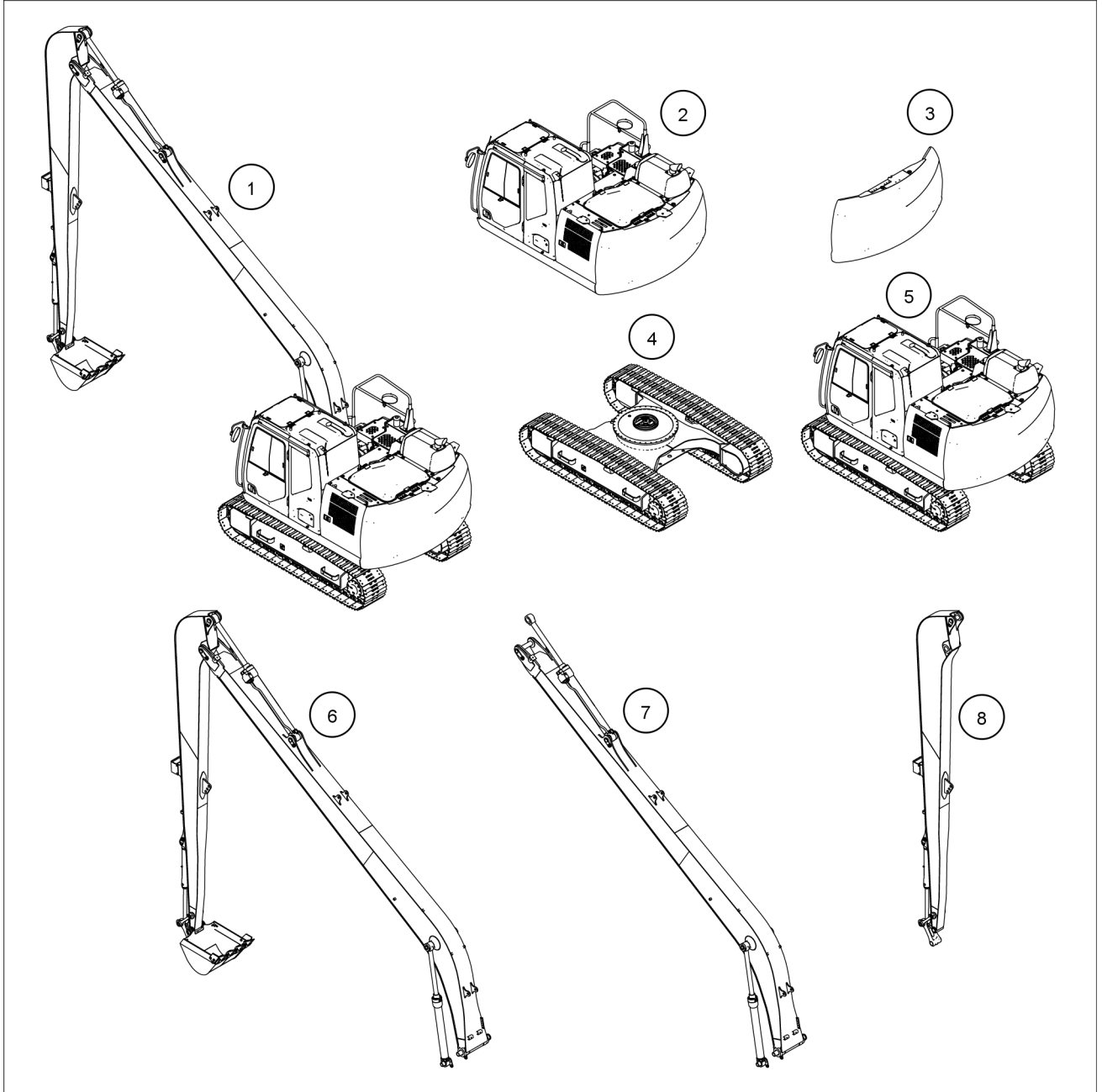

SML17CEX4869GB 1

Code	Part name	Weight
1	Operating weight	15400 kg (33951.188 lb)
2	Upper component (including counterweight and turntable bearing)	7790 kg (17174.010 lb)
3	Counterweight	3420 kg (7539.809 lb)
4	Lower component (with grouser shoe)	4730 kg (10427.865 lb)
5	Main unit weight	12700 kg (27998.707 lb)
6	Attachment (including piping)	2620 kg (5776.111 lb)
7	Boom (including cylinder and piping)	1670 kg (3681.720 lb)
8	Arm (including cylinder, linkage and piping)	740 kg (1631.421 lb)

NOTE: The weights shown here are approximate values.

Stand alone part weight

	Part name	Weight
1	Travel unit (travel motor)	147 kg (324.080 lb)
2	Take-up roller	65 kg (143.300 lb)
3	Upper roller	14 kg (30.865 lb)
4	Lower roller	22 kg (48.502 lb)
5	Swing unit	99 kg (218.258 lb)
6	Turntable bearing	171 kg (376.990 lb)
7	Engine	406 kg (895.077 lb)
8	Radiator	73 kg (160.937 lb)
9	Hydraulic pump	86 kg (189.598 lb)
10	Fuel tank	132 kg (291.010 lb)
11	Hydraulic oil tank	126 kg (277.782 lb)
12	Urea solution tank	9.2 kg (20.283 lb)
13	Control valve	160 kg (352.740 lb)
14	Center joint	29 kg (63.934 lb)
15	Boom	1050 kg (2314.854 lb)

Shoe weight (per side)

	Part name	Weight
1	600 mm (23.62 in) grouser shoe (M seal, without hole)	852 kg (1878.338 lb)
2	700 mm (27.56 in) grouser shoe (M seal)	1009 kg (2224.464 lb)

Arm weight

	Part name	Weight
1	Ultra-long arm (EM3)	587.2 kg (1294.554 lb)
2	Ultra-long arm (EM3 01)	591.6 kg (1304.255 lb)
3	Ultra-long arm (EM3 02)	589.9 kg (1300.507 lb)
4	Ultra-long arm (EM3 QC)	588.7 kg (1297.861 lb)
5	Ultra-long arm (EM3 01 QC)	593.1 kg (1307.562 lb)
6	Ultra-long arm (EM3 02 QC)	591.4 kg (1303.814 lb)

Dimension

CX130D Crawler excavators Standard w/Blade version (TIER 4 FINAL) - EU market	WE
--	----

Standard arm [2.50 m (8.2021 ft)]

NOTE: Numbers are subject to change without notice due to design change or other reason.

NOTE: The diagram gives values that include the shoe lug height "a" [20 mm (0.787 in)].

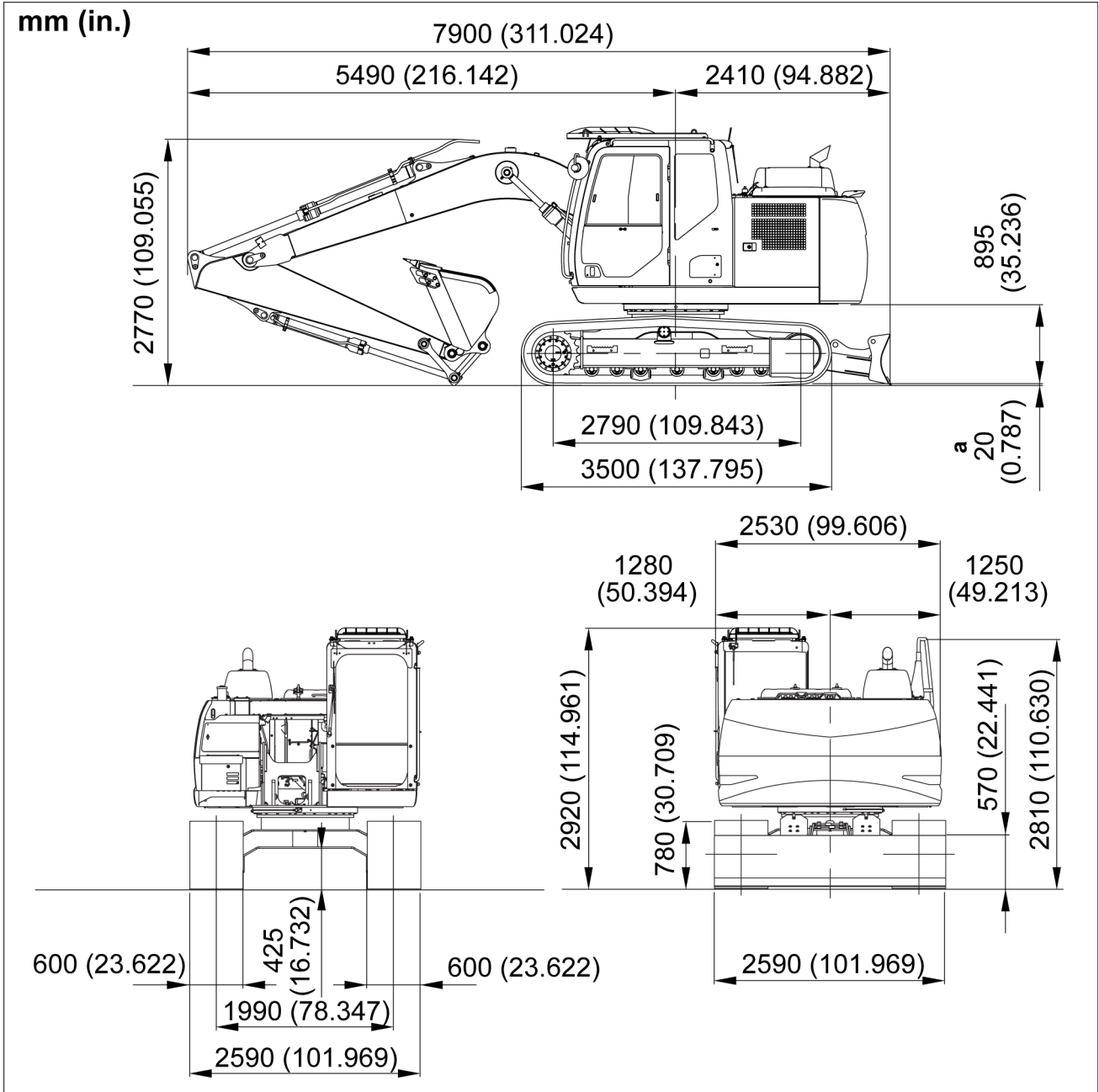

SMIL15CEX4452GB 1

Short arm [2.11 m (6.9226 ft)]

NOTE: Numbers are subject to change without notice due to design change or other reason.

NOTE: The diagram gives values that include the shoe lug height "a" [20 mm (0.787 in)].

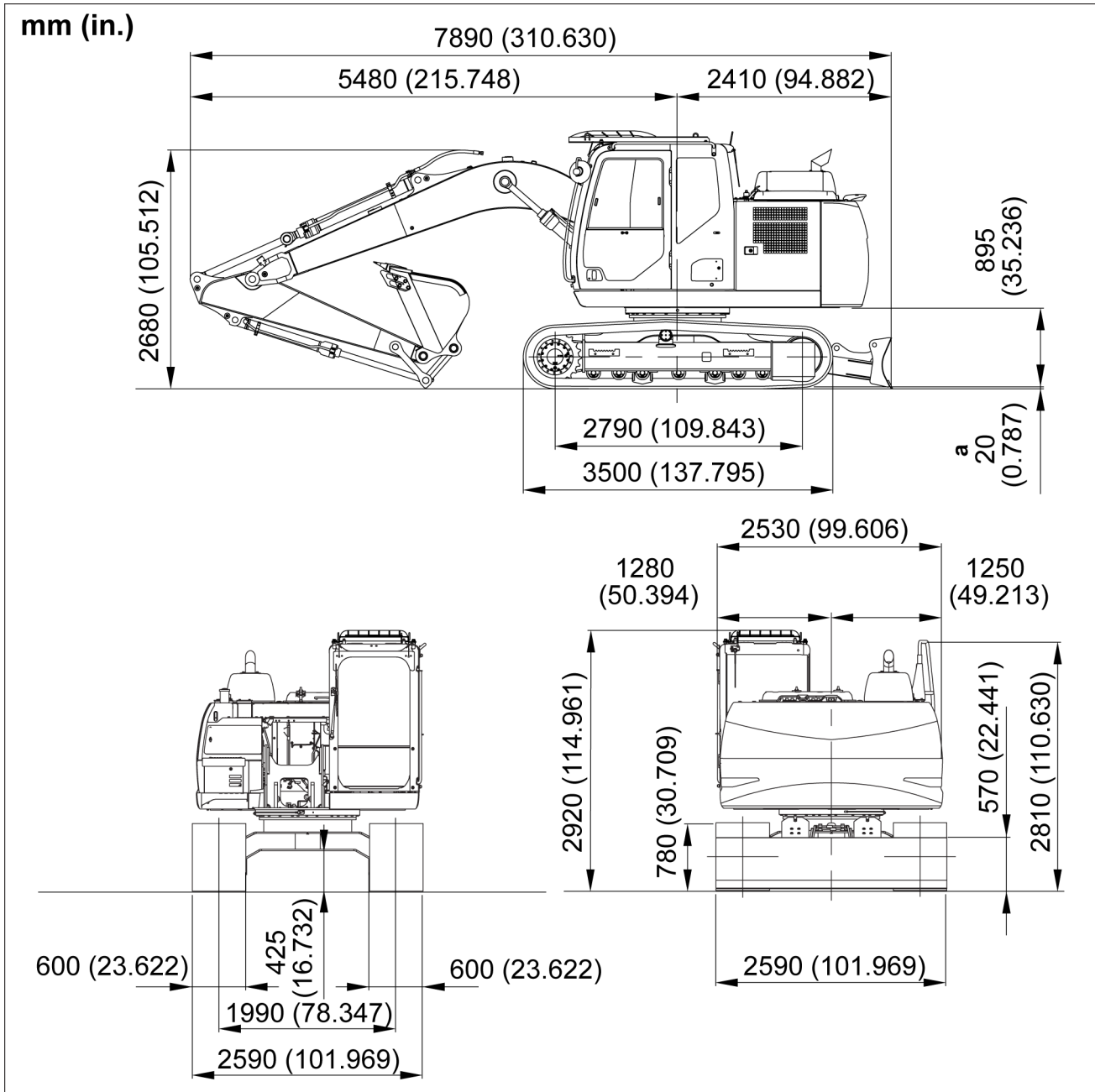

SMIL15CEX4453GB 2

Long arm [3.01 m (9.8753 ft)]

NOTE: Numbers are subject to change without notice due to design change or other reason.

NOTE: The diagram gives values that include the shoe lug height "a" [20 mm (0.787 in)].

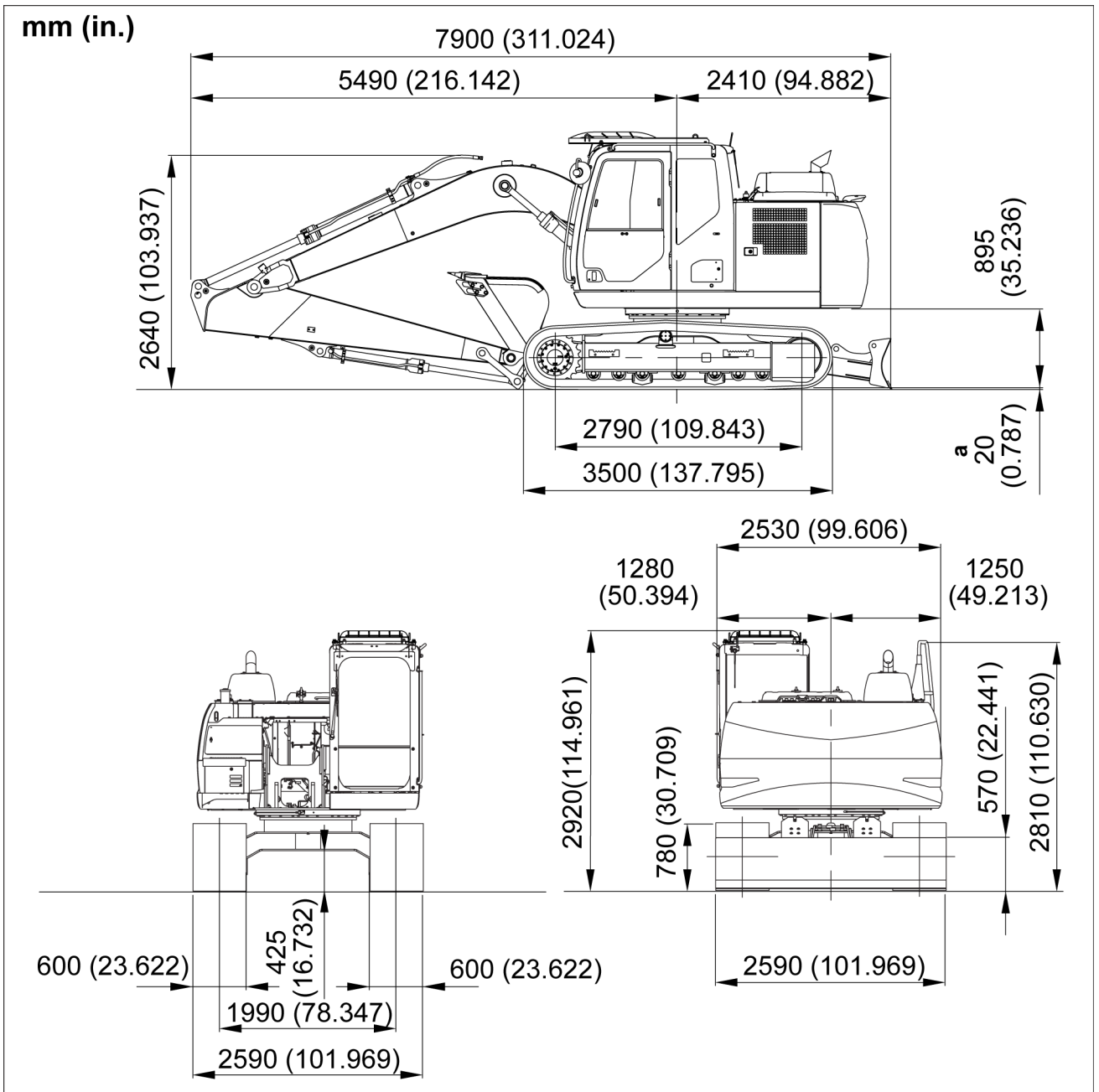

SML15CEX4454GB 3

Dimension

CX130D Crawler excavators LC version (TIER4 FINAL) - EU Market

WE

Standard arm [2.50 m (8.2021 ft)]

NOTE: Numbers are subject to change without notice due to design change or other reason.

NOTE: The diagram gives values that include the shoe lug height "a" [20 mm (0.787 in)].

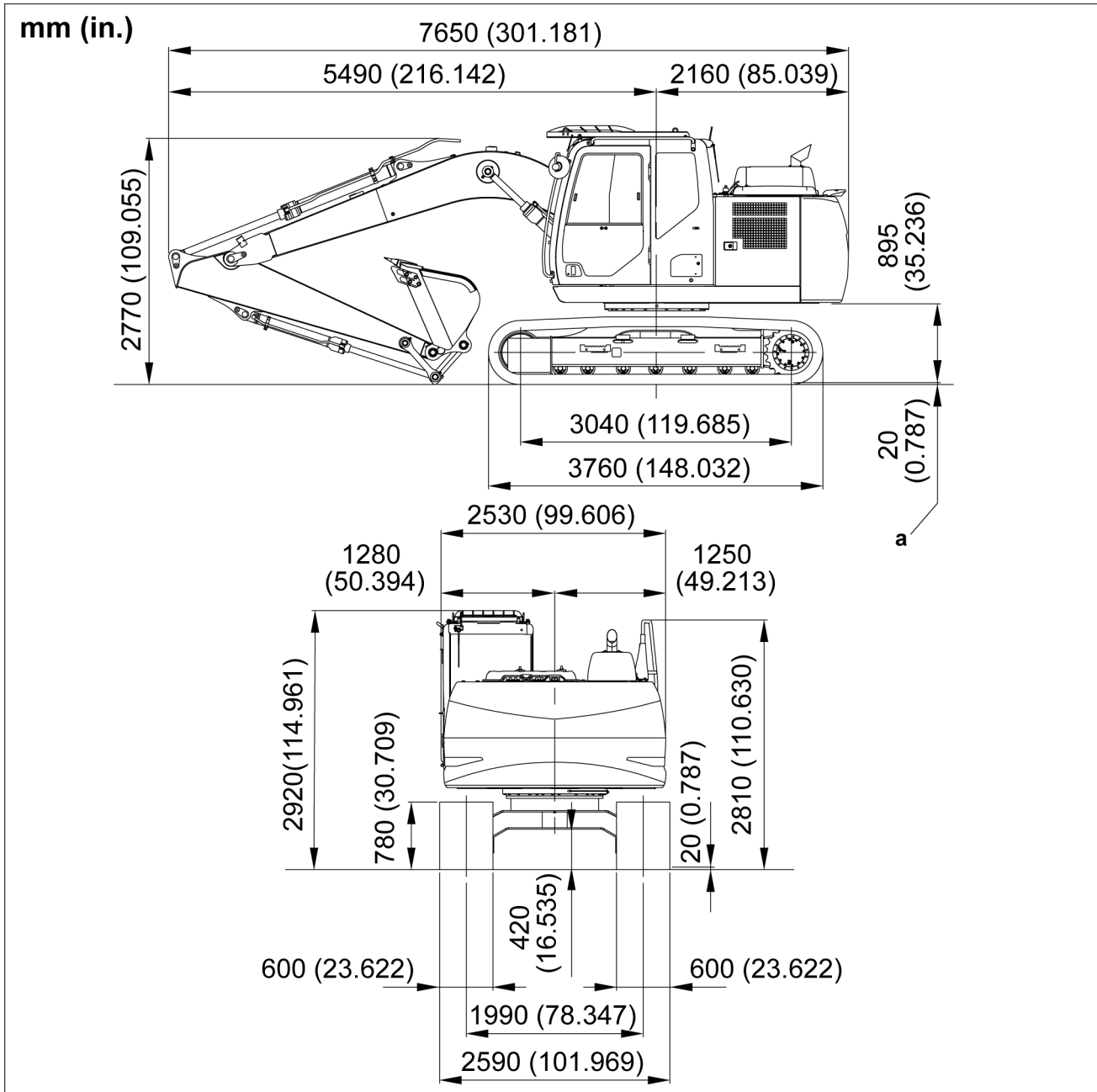

SMIL15CEX4455GB 1

Short arm [2.11 m (6.9226 ft)]

NOTE: Numbers are subject to change without notice due to design change or other reason.

NOTE: The diagram gives values that include the shoe lug height "a" [20 mm (0.787 in)].

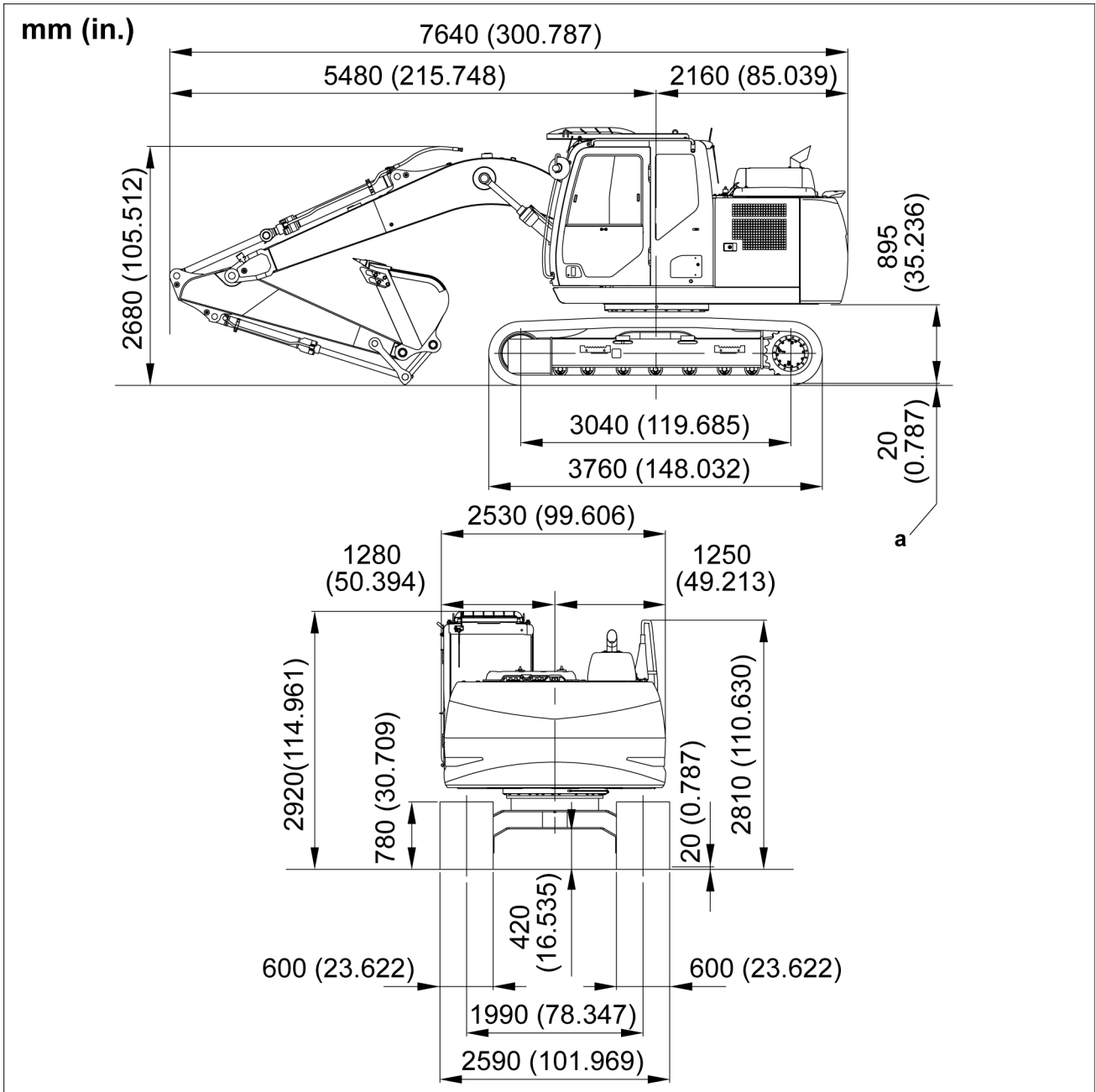

SML15CEX5794GB 2

This as a preview PDF file from best-manuals.com



Download full PDF manual at best-manuals.com